

## Step by step installation guide -32/40/50mm Push-Fit Waste



### WARNING

Ensure you purchase the correct pipe for your chosen system.



1 Measure and cut the pipe to size.



2 Lubricate the ring seal in the socket.



3 Push the pipe into the socket.

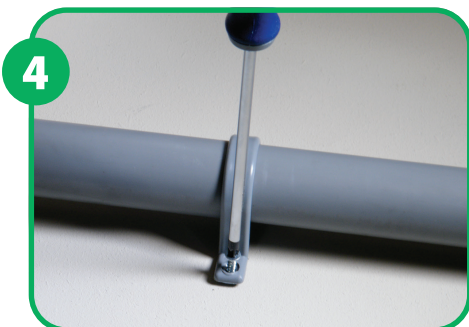

4 All pipes must be supported both vertically and horizontally.

### Pipework support (BS EN 12056:2000) Maximum distances for support

Pipe Size	Vertical	Horizontal
32mm	1.2m	0.5m
40mm	1.2m	0.5m
50mm	1.2m	0.6m



Roofline, Window and Cladding Systems



Rainwater Systems



Soil & Waste Systems



Underground Drainage Systems



MDPE Systems



Hot & Cold Plumbing Systems