

Step by step installation guide - Soil Stack



1 For replacement, first remove the existing soil stack and fittings, starting at the top of the stack and working your way down.



2 At this stage you will have previously installed the internal fittings leading to the new stack on the outside.



3 Install the new soil stack in the reverse order of the removal of the old stack working from the ground to the top.



4 Next, plan out where all the fittings will go.



5 Begin by offering up the first fitting. In this instance it is often advisable to install an access fitting at the base which is good practice to aid rodding. Spray the fitting with silicone lubricant and push into the branch.



6 Measure and mark the correct length on the pipes.



Roofline, Window and Cladding Systems



Rainwater Systems



Soil & Waste Systems



Underground Drainage Systems



MDPE Systems



Hot & Cold Plumbing Systems

Step by step installation guide - Soil Stack

7



Cut the pipes to the correct lengths.

8



Ensure all the cut lengths of pipe are chamfered to roughly a 45 degree angle.

9



Use a silicone lubricant to make the fitting easier.

10



Insert the pipe and fitting into the access fitting.

11



Fit the pipe or socket brackets at a maximum of 2 metres on vertical pipe and a maximum of 1 metre on horizontal pipe.

12



Mark the position where you want the bracket to go.

13



Drill a hole.

14



Using 40mm x 5.5mm roundhead brass or zinc screws, attach the first bracket to the pipe.

15



Next, establish the joining point of any horizontal and vertical pipes that may be required.



Roofline, Window and Cladding Systems



Rainwater Systems



Soil & Waste Systems



Underground Drainage Systems



MDPE Systems



Hot & Cold Plumbing Systems

Step by step installation guide - Soil Stack



16 Then measure and install the connecting branch and pipes securing with FloPlast's pipe or socket brackets.



17 Ensure pipe is vertical by measuring with a spirit level.



18 Continue installing the soil stack following the same procedure until you are ready to install the ventilation section. Apply silicone lubricant to the branch.



19 Insert branch into pipe.



20 Apply silicone lubricant to the bend.



21 Install bend into access bend.



22 Measure, mark and cut horizontal pipe to correct length.

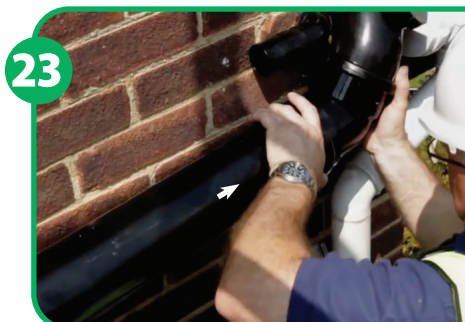

23 Install pipe between bend and branch.



Roofline, Window and Cladding Systems



Rainwater Systems



Soil & Waste Systems



Underground Drainage Systems



MDPE Systems



Hot & Cold Plumbing Systems

Step by step installation guide - Soil Stack



Fix vertical and horizontal pipe or socket brackets.

To view our Waste and Traps installations, please visit www.floplast.co.uk



The ventilation pipe open to the outside, should finish at least 900mm above any opening into the building that is within 3 metres of the soil stack.

Alternatively fit FloPlast's external air admittance valve. This will allow you to install an external soil pipe within 3 metres of any opening and it can

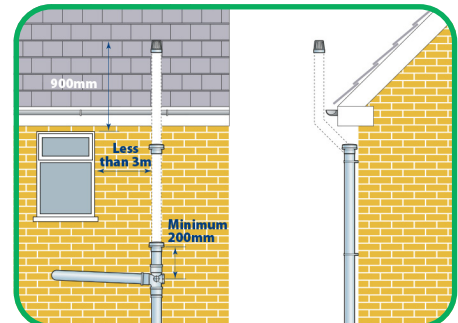

terminate at a minimum of 200mm from the wet entry point.



To complete the installation, use a cement mix to make good any holes.



Once your installation is complete, please dispose of old or unwanted items including pipes and fittings in a responsible manner.



Roofline, Window and Cladding Systems



Rainwater Systems



Soil & Waste Systems



Underground Drainage Systems



MDPE Systems



Hot & Cold Plumbing Systems