

Technical Specification / Product Datasheet

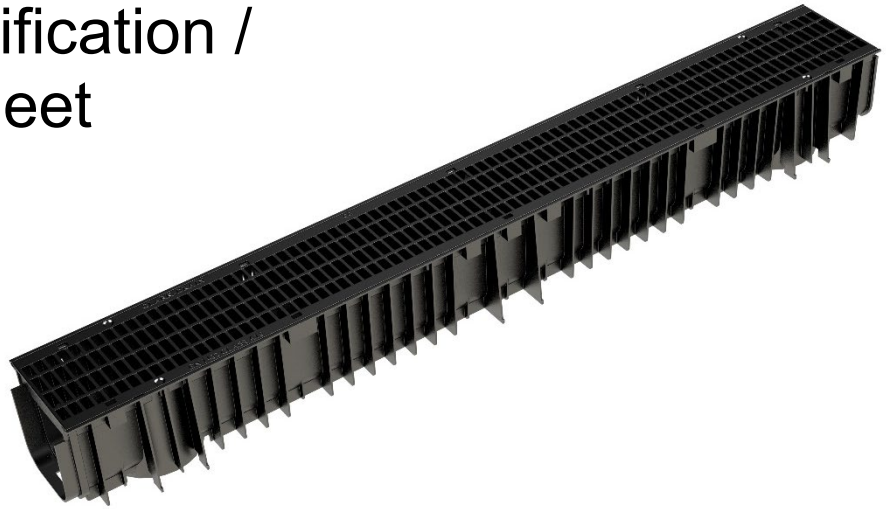
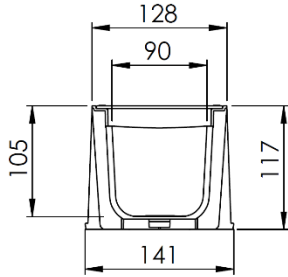

Specific Product Code:	CD 422 / MESH
Product Group:	Linear Drainage
Sub-Category:	A15 Light/Pedestrian Duty Plastic Channel
Material Grade/s:	Polypropylene Grade AP9
Dimensions (mm):	Length = 1000 Internal Width = 90 External Width = 128 Internal Height = 105 External Height = 117 Slot Size = 8.15 x 17/23
Waterway Area (cm ²):	534
Max Through-Flow (l/s):	4.3
Weight (kgs):	1.75
Load Rating Classification:	A15 (1.5 tonnes)

Features:

- CE and UKAS marked and fully certified to BS EN 1433:2002
- Lightweight non-rusting design, manufactured from recycled polypropylene
- Available with a range of accessories (CD 402 end-caps, CD 403 debris trap)
- Heat resistant (ideal for tarmac edging)
- 10 point 'snap-lock' slotted grating; secure yet easy to remove for cleaning and maintenance
- 'Spring-Lock' channel-to-channel male/female connection allows several meters of channel to be laid at a time
- Provision for locking screws in grating (purchased separately)
- Installation guide clearly marked on the inside of the channel
- Suitable for garage thresholds, patios, gardens and play areas

Date Issued: 28/6/22

Due to our continuous product improvement program features and sizes may be subject to change without notice