

Fitting & Instructions - Bath Pop Up Waste & Overflow

IMPORTANT NOTES

- Please ensure installation is undertaken by an experienced Plumber, as to ensure compliance with all Council and Local Authority requirements
- Please wear appropriate PPE
- It is the responsibility of the person who installs the waste to ensure that the installation is watertight
- We have taken great care to ensure that this product reaches you in perfect condition. However should any parts be damaged or missing please contact your point of purchase. This does not affect your statutory rights. In addition if you require replacement parts your point of purchase will be happy to assist.

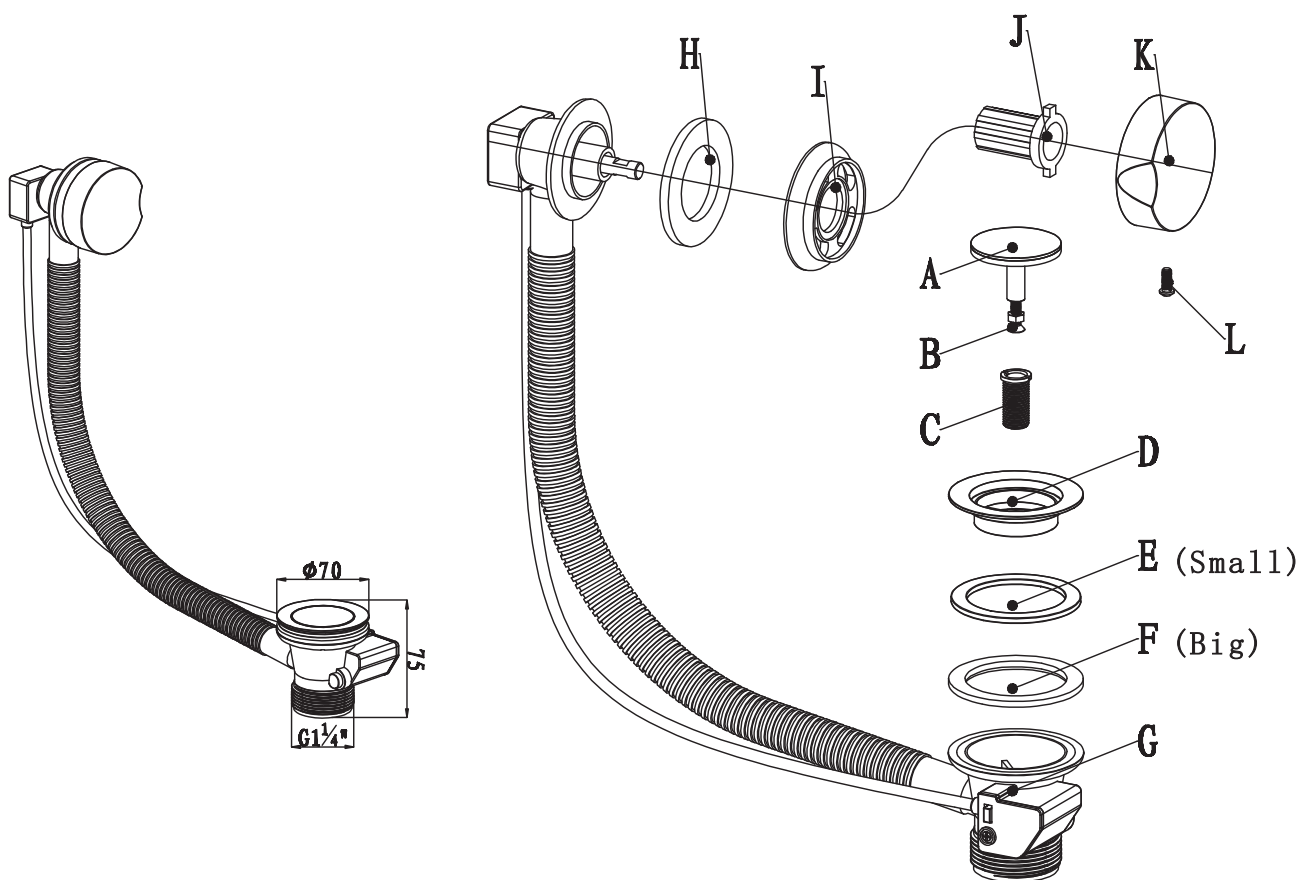

Installation Steps:

Disassemble the product according to the exploded diagram as above.

1. Assemble the fittings according to the picture 1.

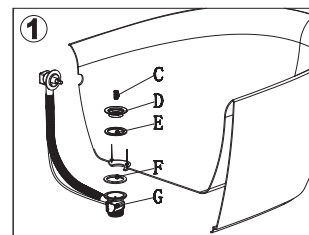

2. Install "A" ensuring it slides down into the body "G"

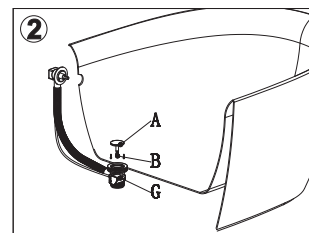

3. Assemble the rubber according to the picture 3.

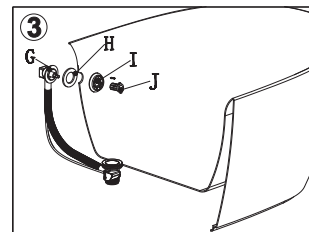

4. Install "K" through the screw "L" onto "G" tightly.

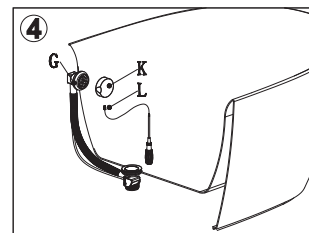

5. Check for leaks

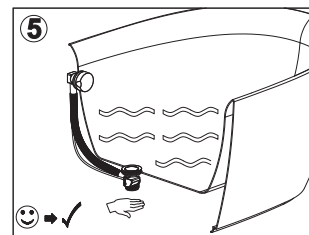

6. If there exists water leakage, then disassemble the product and back to step 1.

Pls apply a generous bead of a suitable bathroom silicone sealant around the bottom rim of "D" if necessity.

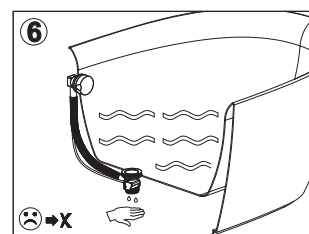

Attention:

This waste is designed for a bath with a maximum thickness of 16mm.

In order to adjust flow rate in compensation for differing bath thicknesses the Screw length 'A' and locking nut 'B' may have to be adjusted.

