

# 600 WC Unit Assembly

## Components

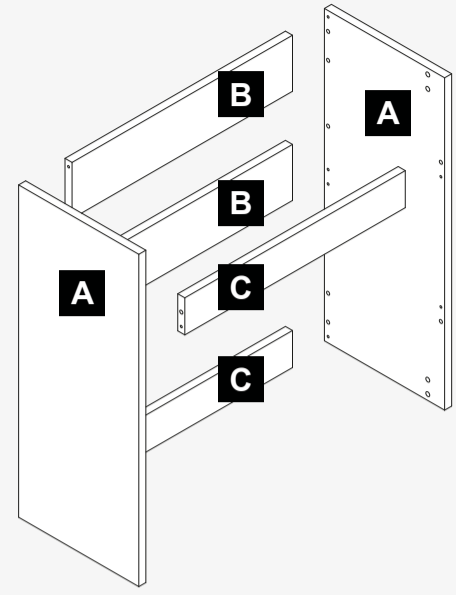
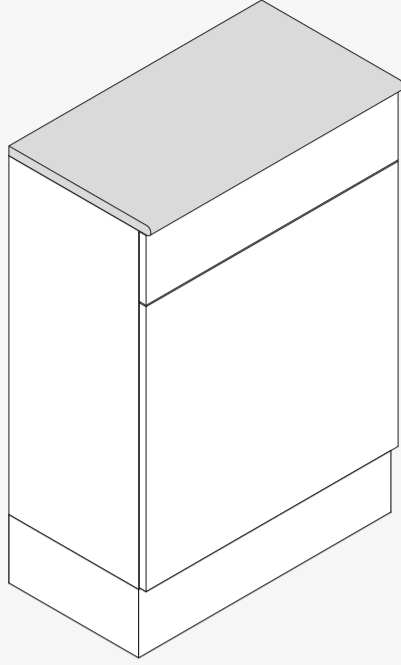

## Important Information

**Caution:** Some pieces of hardware could be hazardous to small children. Keep all these items out of reach and do not leave children unattended in the assembly area. Please read these instructions carefully before proceeding. Refer to the Guide to Receiving and Installing your Bathroom booklet for further information.  
**Note:** Due to variation in wall conditions no screws are supplied for fixing the units to the wall. If in doubt consult an expert. Assemble the unit on a clean solid work surface. In the interest of continuing improvements we reserve the right to amend or adjust the specifications without prior notice. Errors and omissions excepted. Every effort has been made to ensure that this product leaves the factory in perfect condition. In the unlikely event that an item is damaged or incorrect, please contact the customer services department.



FM 621254

Ref. No.	Item	Quantity	Ref. No.	Item	Quantity	Ref. No.	Item	Quantity	Tools Required
150101	3.5x12mm	44	154041		2	152404		2	Drill G-Clamp (pair) Medium Crosshead Screwdriver Hammer Large Flathead Screwdriver Tape Measure Spirit Level Bradawl
150201	4x15mm	8	154077		8	152402		4	
154082		8	154078		6	152413		2	
154085		8	154077		2				
154004		8							
150308		2							
150309		2							

### 1-3 Assembly Instructions

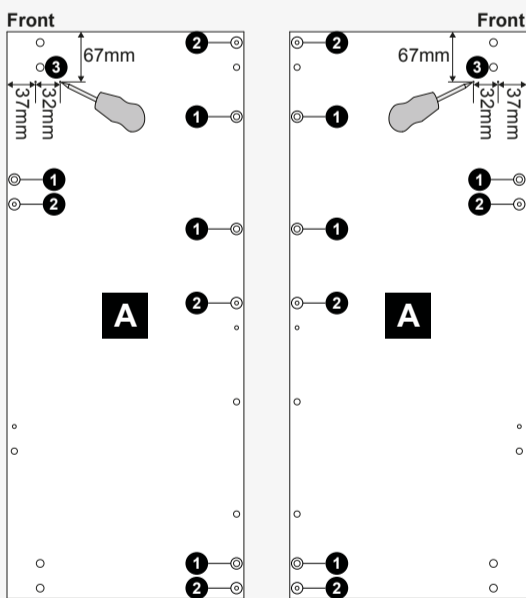

Note: Holes for Step 5 are marked with a bradawl as shown in Step 3.

### 4-6 Assembly Instructions

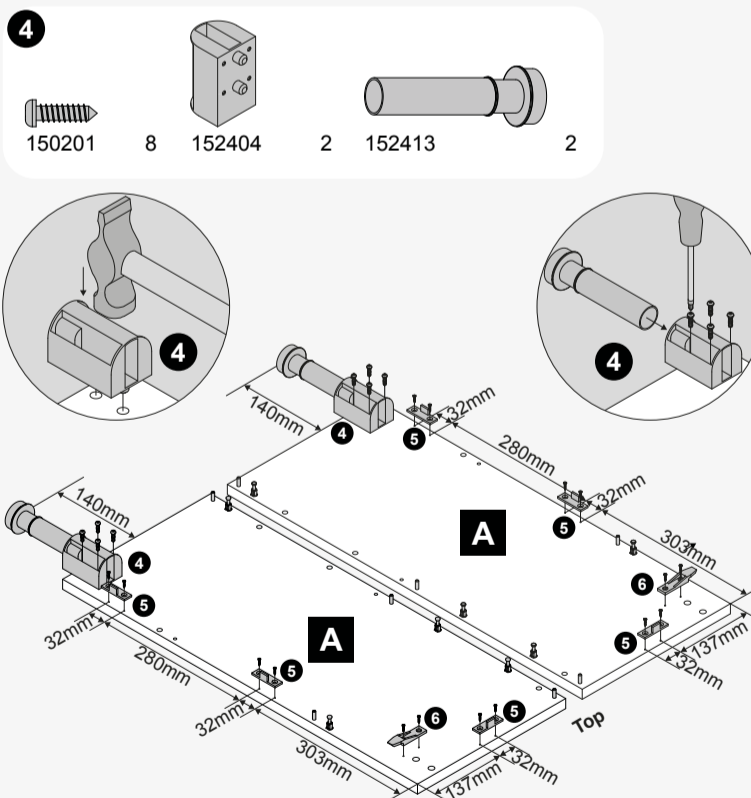

Note: Bracket 154078 is fitted flush to face of panel. Mark holes for Step 5 with bradawl.

### 7 Assembly Instructions

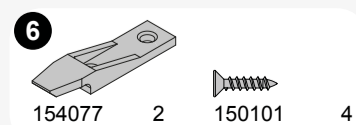
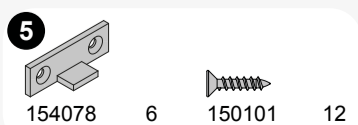
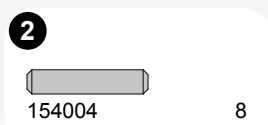
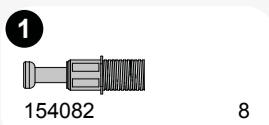
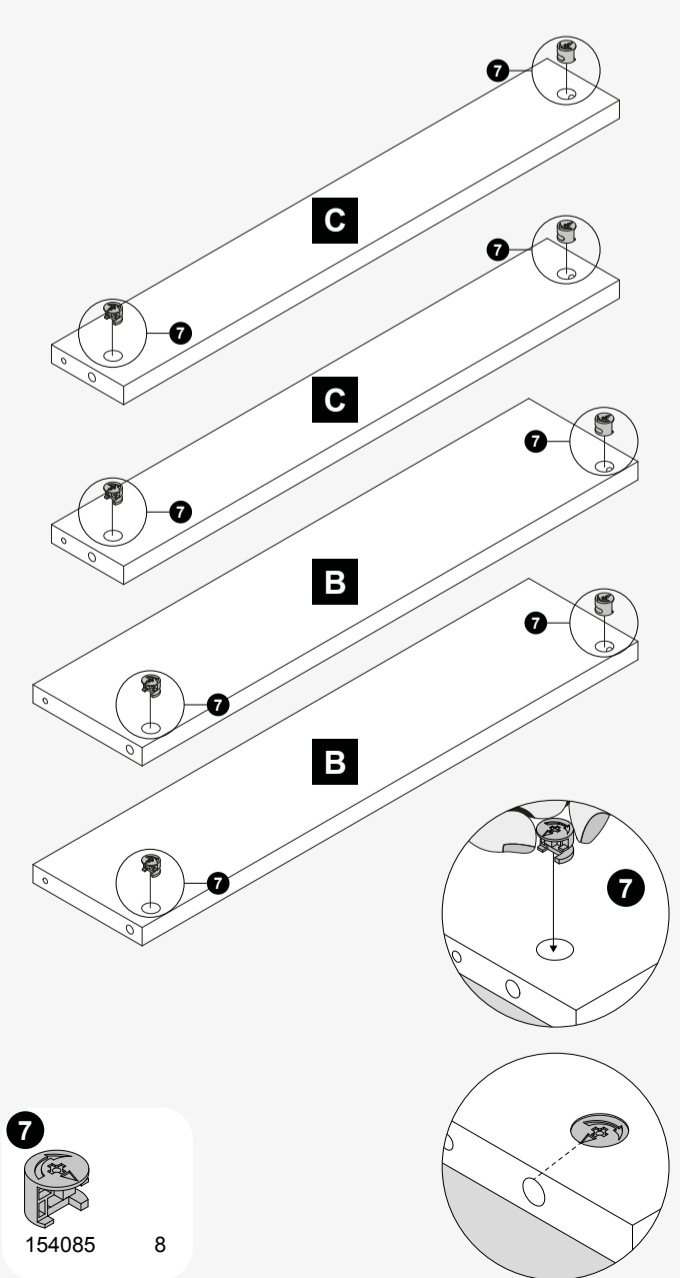

8 9

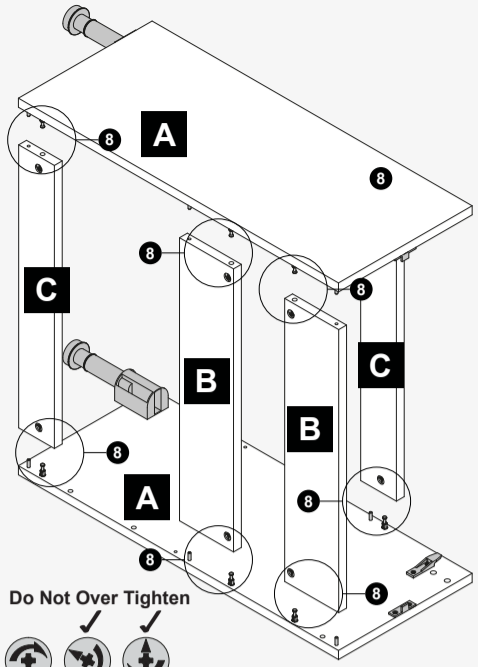

Do Not Over Tighten

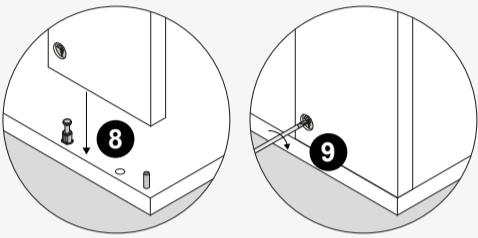

### 10 Installation Instructions

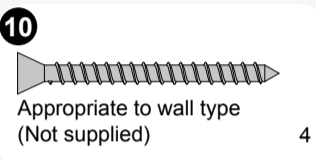
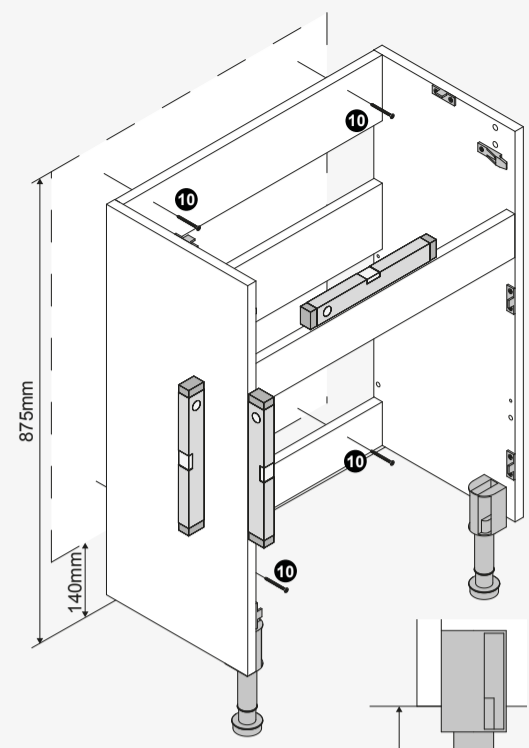

11

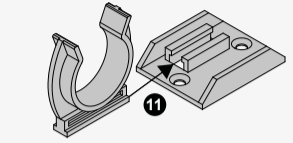
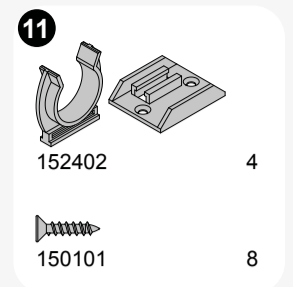
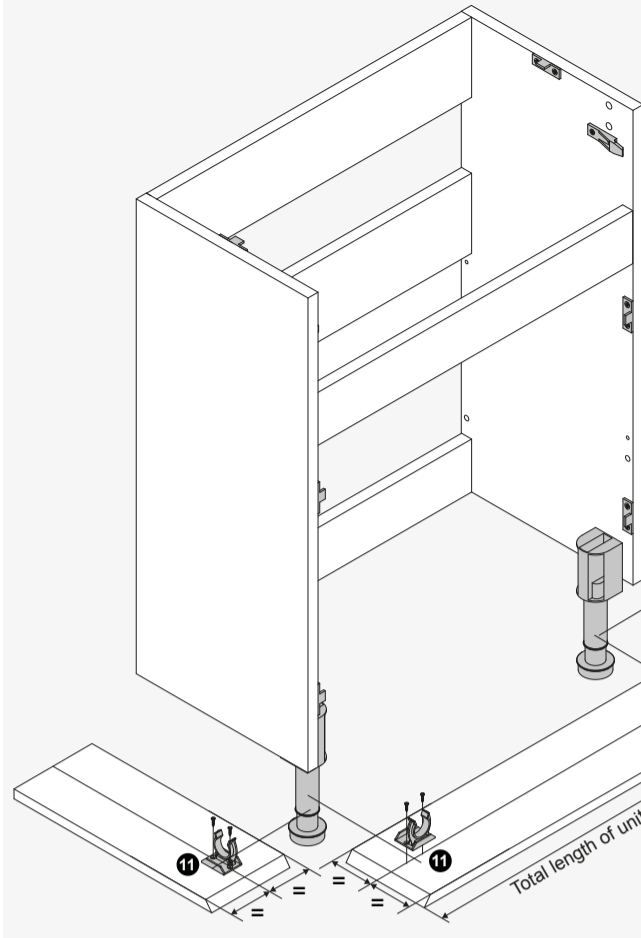

Note: Fit plinth clips on return plinth upside down.

12

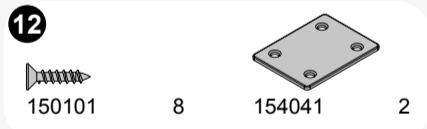
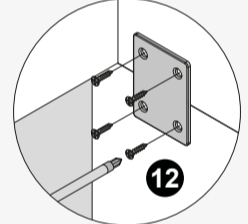
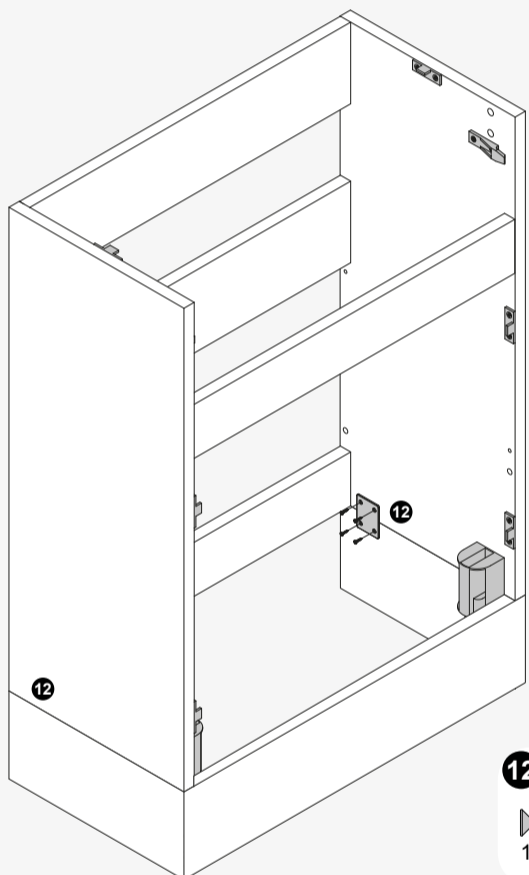

13

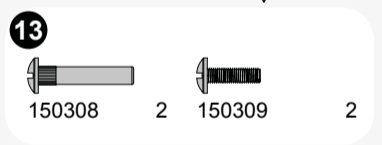
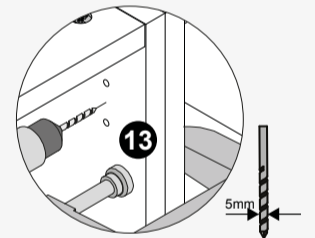
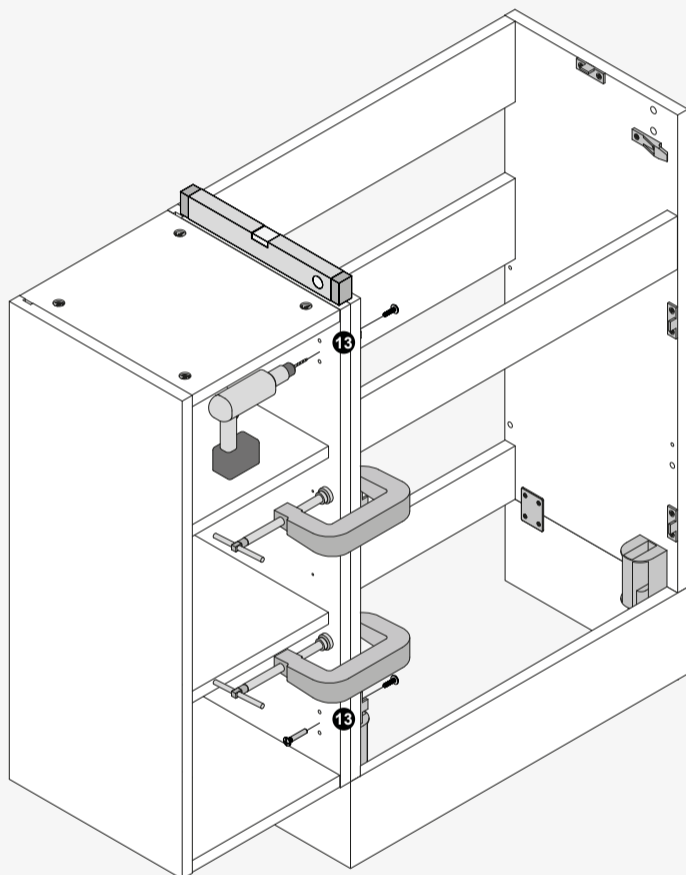

14 15

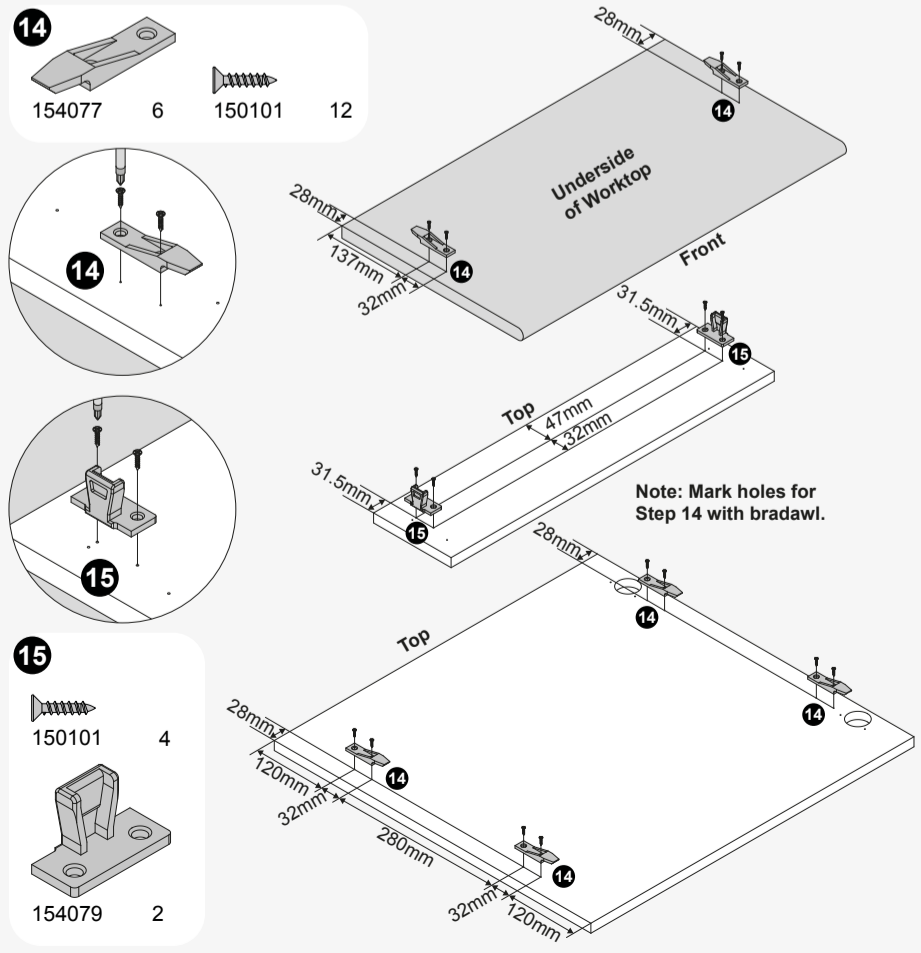

Note: Mark holes for Step 14 with bradawl.

16 18

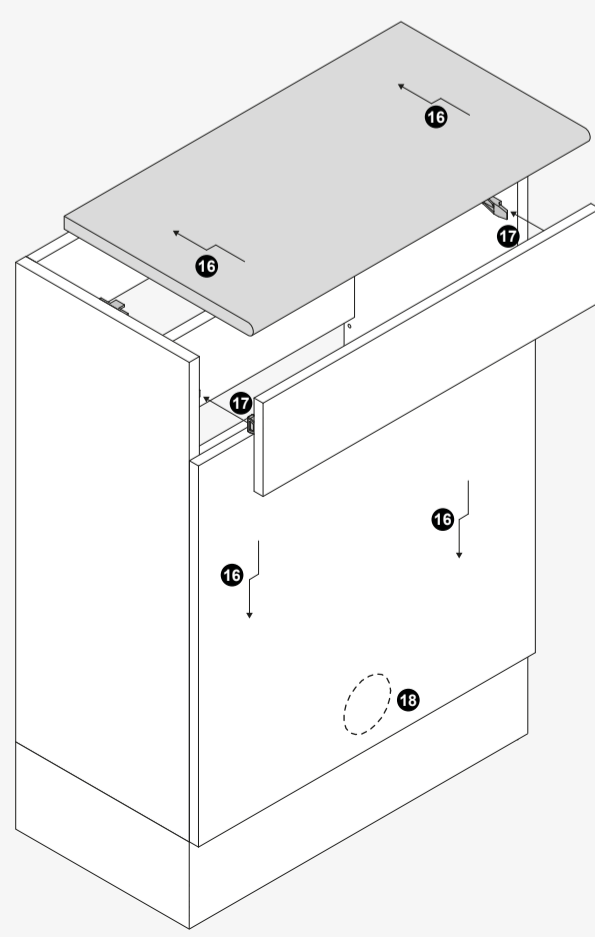

Note: Cut hole for Step 18 to suit WC.