

Wickes

CORDLESS SCREWDRIVER

3.6V LITHIUM



CSD36Y1
223751

CONTENTS

GENERAL POWER TOOL SAFETY WARNINGS 3

SAFETY WARNINGS FOR BATTERY CELLS INSIDE THE TOOL 5

COMPONENT LIST 7

ACCESSORIES 7

SYMBOLS 8

TECHNICAL DATA 8

NOISE INFORMATION 9

OPERATING INSTRUCTIONS 10

TROUBLESHOOTING 13

MAINTENANCE 14

ENVIRONMENTAL PROTECTION 14

DECLARATION OF CONFORMITY 15

ORIGINAL INSTRUCTION

GENERAL POWER TOOL SAFETY WARNINGS

 **WARNING!** Read all safety warnings, instructions, illustrations and specifications provided with this power tool. Failure to follow all instructions listed below may result in electric shock, fire and/or serious injury.

SAVE ALL WARNINGS AND INSTRUCTIONS FOR FUTURE REFERENCE.

The term "power tool" in the warnings refers to your mains-operated (corded) power tool or battery-operated (cordless) power tool.

1. WORK AREA SAFETY

- a) **Keep work area clean and well lit.** Cluttered or dark areas invite accidents.
- b) **Do not operate power tools in explosive atmospheres, such as in the presence of flammable liquids, gases or dust.** Power tools create sparks which may ignite the dust or fumes.
- c) **Keep children and bystanders away while operating a power tool.** Distractions can cause you to lose control.

2. ELECTRICAL SAFETY

- a) **Power tool plugs must match the outlet. Never modify the plug in any way. Do not use any adapter plugs with earthed (grounded) power tools.**
Unmodified plugs and matching outlets will reduce risk of electric shock.
- b) **Avoid body contact with earthed or grounded surfaces, such as pipes, radiators, ranges and refrigerators.** There is an increased risk of electric shock if your body is earthed or grounded.
- c) **Do not expose power tools to rain or wet conditions.** Water entering a power tool will increase the risk of electric shock.
- d) **Do not abuse the cord. Never use the cord for carrying, pulling or unplugging the power tool. Keep cord away from heat, oil, sharp edges or moving parts.** Damaged or entangled cords increase the risk of electric shock.
- e) **When operating a power tool outdoors, use an extension cord suitable for outdoor use.** Use of a cord suitable for outdoor use reduces the risk of electric shock.
- f) **If operating a power tool in a damp location is unavoidable, use a residual current device (RCD)**

protected supply. Use of an RCD reduces the risk of electric shock.

3. PERSONAL SAFETY

- a) **Stay alert, watch what you are doing and use common sense when operating a power tool. Do not use a power tool while you are tired or under the influence of drugs, alcohol or medication.** A moment of inattention while operating power tools may result in serious personal injury.
- b) **Use personal protective equipment. Always wear eye protection.** Protective equipment such as dust mask, non-skid safety shoes, hard hat, or hearing protection used for appropriate conditions will reduce personal injuries.
- c) **Prevent unintentional starting. Ensure the switch is in the off-position before connecting to power source and/or battery pack, picking up or carrying the tool.** Carrying power tools with your finger on the switch or energising power tools that have the switch on invites accidents.
- d) **Remove any adjusting key or wrench before turning the power tool on.** A wrench or a key left attached to a rotating part of the power tool may result in personal injury.
- e) **Do not overreach. Keep proper footing and balance at all times.** This enables better control of the power tool in unexpected situations.
- f) **Dress properly. Do not wear loose clothing or jewellery. Keep your hair and clothing away from moving parts.** Loose clothes, jewellery or long hair can be caught in moving parts.
- g) **If devices are provided for the connection of dust extraction and collection facilities, ensure these are connected and properly used.** Use of dust collection can reduce dust-related hazards.
- h) **Do not let familiarity gained from frequent use of tools allow you to become complacent and ignore tool safety principles.** A careless action can cause severe injury within a fraction of a second.

4. POWER TOOL USE AND CARE

- a) **Do not force the power tool. Use the correct power tool for your application.** The correct power tool will do the job better and safer at the rate for which it was designed.
- b) **Do not use the power tool if the switch does not turn it on and off.** Any power tool that cannot be controlled with the switch is dangerous and must be

GENERAL POWER TOOL SAFETY WARNINGS

repaired.

- c) **Disconnect the plug from the power source and/or remove the battery pack, if detachable, from the power tool before making any adjustments, changing accessories, or storing power tools.** Such preventive safety measures reduce the risk of starting the power tool accidentally.
- d) **Store idle power tools out of the reach of children and do not allow persons unfamiliar with the power tool or these instructions to operate the power tool.** Power tools are dangerous in the hands of untrained users.
- e) **Maintain power tools and accessories. Check for misalignment or binding of moving parts, breakage of parts and any other condition that may affect the power tool's operation. If damaged, have the power tool repaired before use.** Many accidents are caused by poorly maintained power tools.
- f) **Keep cutting tools sharp and clean.** Properly maintained cutting tools with sharp cutting edges are less likely to bind and are easier to control.
- g) **Use the power tool, accessories and tool bits etc. in accordance with these instructions, taking into account the working conditions and the work to be performed.** Use of the power tool for operations different from those intended could result in a hazardous situation.
- h) **Keep handles and grasping surfaces dry, clean and free from oil and grease.** Slippery handles and grasping surfaces do not allow for safe handling and control of the tool in unexpected situations.

5. BATTERY TOOL USE AND CARE

- a) **Recharge only with the charger specified by the manufacturer.** A charger that is suitable for one type of battery pack may create a risk of fire when used with another battery pack.

- b) **Use power tools only with specifically designated battery packs.** Use of any other battery packs may create a risk of injury and fire.
- c) **When battery pack is not in use, keep it away from other metal objects, like paper clips, coins, keys, nails, screws or other small metal objects, that can make a connection from one terminal to another.** Shorting the battery terminals together may cause burns or a fire.
- d) **Under abusive conditions, liquid may be ejected from the battery; avoid contact. If contact accidentally occurs, flush with water. If liquid contacts eyes, additionally seek medical help.** Liquid ejected from the battery may cause irritation or burns.
- e) **Do not use a battery pack or tool that is damaged or modified.** Damaged or modified batteries may exhibit unpredictable behaviour resulting in fire, explosion or risk of injury.
- f) **Do not expose a battery pack or tool to fire or excessive temperature.** Exposure to fire or temperature above 130 °C may cause explosion.
- g) **Follow all charging instructions and do not charge the battery pack or tool outside the temperature range specified in the instructions.** Charging improperly or at temperatures outside the specified range may damage the battery and increase the risk of fire.

6. SERVICE

- a) **Have your power tool serviced by a qualified repair person using only identical replacement parts.** This will ensure that the safety of the power tool is maintained.
- b) **Never service damaged battery packs.** Service of battery packs should only be performed by the manufacturer or authorized service providers.

SCREWDRIVER SAFETY WARNING

- 1. **Hold the power tool by insulated gripping surfaces, when performing an operation where the fastener may contact hidden wiring.** Fasteners contacting a "live" wire may make exposed metal parts of the power tool "live" and could give the operator an electric shock.

SAFETY WARNINGS FOR BATTERY CELLS INSIDE THE TOOL

- a) Do not dismantle, open or shred cells.
- b) Do not short-circuit charging terminal. Do not store power tool haphazardly in a box or drawer where charging terminal may short-circuit each other or be short-circuited by conductive materials. When power tool is not in use, keep it away from other metal objects, like paper clips, coins, keys, nails, screws or other small metal objects, that can make a connection from one charging terminal to another.
- c) Do not expose power tool to heat or fire. Avoid storage in direct sunlight.
- d) Do not subject power tool to mechanical shock.
- e) In the event of battery leaking, do not allow the liquid to come into contact with the skin or eyes. If contact has been made, wash the affected area with copious amounts of water and seek medical advice.
- f) Seek medical advice immediately if a cell has been swallowed.
- g) Keep power tool clean and dry.
- h) Wipe the charging terminals with a clean dry cloth if they become dirty.
- i) Power tool needs to be charged before use. Always refer to this instruction and use the correct charging procedure.
- j) Do not maintain power tool on charge when not in use.
- k) After extended periods of storage, it may be necessary to charge and discharge the power tool several times to obtain maximum performance.
- l) Battery gives its best performance when it is operated at normal room temperature ($20\text{ }^{\circ}\text{C} \pm 5\text{ }^{\circ}\text{C}$).
- m) When disposing of cells, keep cells of different electrochemical systems separate from each other.
- n) Recharge only with the charger specified by manufacturer. Do not use any charger other than that specifically provided for use with the equipment. A charger that is suitable for one type of battery may create a risk of fire when used with another battery.
- o) Keep power tool out of the reach of children.
- p) Retain the original product literature for future reference.
- q) Dispose of properly.
- r) Do not mix cells of different manufacture, capacity, size or type within a device.
- s) Do not use any cell which is not designed for use with the equipment.

GENERAL SAFETY WARNINGS FOR BATTERY CHARGER



WARNING! Read all safety warnings and all instructions. Failure to follow the warnings and instructions may result in electric shock, fire and/or serious injury.

Save all warnings and instructions for future reference.

This appliance can be used by children aged from 8 years and above and persons with reduced physical, sensory or mental capabilities or lack of experience and knowledge if they have been given supervision or instruction concerning use of the appliance in a safe way and understand the hazards involved. Children shall not play with the appliance. Cleaning and user maintenance shall not be made by children without supervision.

Additional safety instructions for your Battery Charger

1. Before charging, read the instructions.
2. Do not charge a leaking battery.
3. Do not use chargers for works other than those for which they are designed.
4. Before charging, ensure your charger is matching the local AC supply.
5. For indoor use only.
6. The charging device must be protected from moisture.
7. Do not short out the contacts of battery or charger.
8. Respect the polarity “+/-” when charging.
9. Do not open the unit and keep out of the reach of children.
10. Do not charge the batteries of other manufactures or ill-suited models.
11. Ensure that the connection between the battery charger and battery is correctly positioned and is not obstructed by foreign bodies.
12. Keep battery charger's slots are free of foreign objects and protect against dirt and humidity. Store in a dry and frost-free place.
13. When charging batteries, ensure that the battery charger is in a well-ventilated area and away from inflammable materials. Batteries can get hot during charging. Do not overcharge any batteries. Ensure that batteries and chargers are not left unsupervised during charging.
14. Do not recharge non-rechargeable batteries, as they can overheat and break.
15. Longer life and better performance can be obtained if the battery pack is charged when the air temperature is between 18°C and 24°C. Do not charge the battery pack in air temperatures below 0°C, or above 40°C. This is important as it can prevent serious damage to the battery pack.
16. Charge only battery pack of the same model provided by manufacturer and of models recommended by manufacturer.

COMPONENT LIST

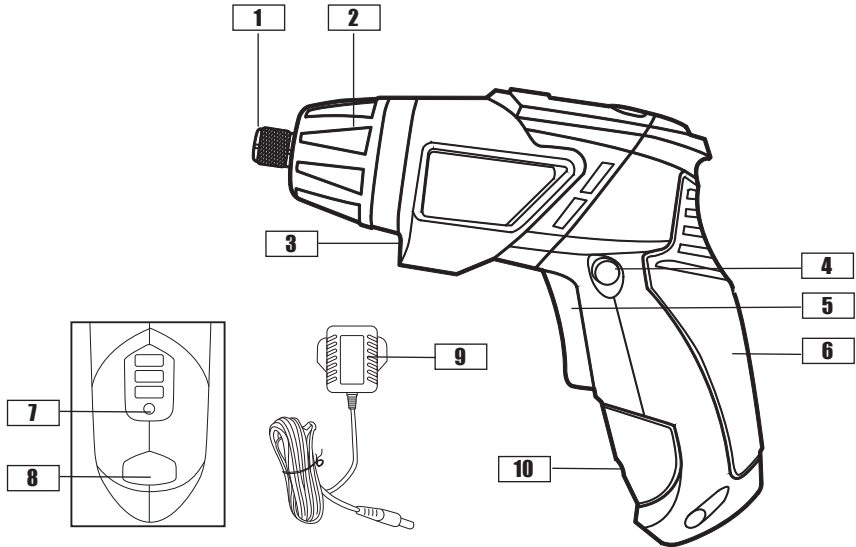

- 1** Collet locking sleeve
- 2** Torque adjustment ring
- 3** LED light
- 4** Forward/reverse rotating control
- 5** On/Off Switch

- 6** Soft grip handle
- 7** Battery capacity indicator button
- 8** Rotating handle button
- 9** Charger
- 10** Charging socket

ACCESSORIES

Charger (XZ0500-1700WB)	1
25mm screwdriver bits	10
Magnetic bit holder	1

We recommend that you purchase your accessories from the same store that sold you the tool. Refer to the accessory packaging for further details. Store personnel can assist you and offer advice.

SYMBOLS



To reduce the risk of injury, read all of this instruction manual



Warning



Wear ear protection



Wear eye protection



Wear dust mask



Do not burn



Batteries may enter water cycle if disposed improperly, which can be hazardous for ecosystem. Do not dispose of waste batteries as unsorted municipal waste.



Read the operator's manual.



Li-ion battery. This product has been marked with a symbol relating to 'separate collection' for all battery packs and battery pack. It will then be recycled or dismantled in order to reduce the impact on the environment. Battery packs can be hazardous for the environment and for human health since they contain hazardous substances.



Indoor use only



Double insulated



The output plug is with positive center pole and negative outer pole



Waste electrical products must not be disposed of with household waste. Please recycle where facilities exist. Check with your local authorities or retailer for recycling advice.

TECHNICAL DATA

Voltage	3.6 V _{nom}
No load speed	230/min
Clutch position	6+1
Max torque	4.5 N.m
Charger Protection class	□/II
Charging time	1 hr
Charger Input	220-240V~50/60Hz,0.3A
Charger Output	5.0V _{nom} 1.7A
Machine weight	0.41 Kg
Battery capacity	1.5 Ah Li-ion battery

For additional battery technical data, refer to the rating plate on the battery pack.

*Voltage measured without workload. Initial battery voltage reaches maximum of 4 volts. Nominal voltage is 3.6 volts.

NOISE INFORMATION

A weighted sound pressure

A weighted sound power

K_{pA} & K_{wA}

Wear ear protection.

L_{pA} : 70.1 dB(A)

L_{wA} : 81.1 dB(A)

3.0 dB(A)

VIBRATION INFORMATION

Vibration total values (triax vector sum) determined according to EN 62841:

Vibration emission value:

$a_h = 1.7 \text{ m/s}^2$ Uncertainty $K = 1.5 \text{ m/s}^2$

The declared vibration total value and the declared noise emission value have been measured in accordance with a standard test method and may be used for comparing one tool with another.

The declared vibration total value and the declared noise emission value may also be used in a preliminary assessment of exposure.

 **WARNING!** The vibration and noise emissions during actual use of the power tool can differ from the declared value depending on the ways in which the tool is used especially what kind of workpiece is processed dependant on the following examples and other variations on how the tool is used:

How the tool is used and the materials being cut or drilled.

The tool being in good condition and well maintained.

The use of the correct accessory for the tool and ensuring it is sharp and in good condition.

The tightness of the grip on the handles and if any anti vibration and noise accessories are used.

And the tool is being used as intended by its design and these instructions.

This tool may cause hand-arm vibration syndrome if its use is not adequately managed.

 **WARNING!** To be accurate, an estimation of exposure level in the actual conditions of use should also take account of all parts of the operating cycle such as the times when the tool is switched off and when it is running idle but not actually doing the job. This may significantly reduce the exposure level over the total working period, helping to minimize your vibration exposure risk.

Always use sharp chisels, drills and blades.

Maintain this tool in accordance with these instructions and keep well lubricated (where appropriate).

If the tool is to be used regularly then invest in anti vibration and noise accessories.

Plan your work schedule to spread any high vibration tool use across a number of days.

OPERATING INSTRUCTIONS



NOTE: Before using the tool, read the instruction book carefully.

Intended Use

The power tool is intended for driving in and loosening screws

BEFORE PUTTING INTO OPERATION

A) CHARGING THE BATTERY

The battery charger supplied is only for the Li-ion battery installed in the tool. Do not use another battery charger. The Li-ion battery is protected against deep discharging. When the battery is empty, the tool is switched off by means of a protective circuit: The tool will not turn on when the trigger is engaged. When the Battery is charged for the first time or after prolonged storage, the Battery Pack will accept a 100% charge only after several charge and discharge cycles.

B) HOW TO CHARGE YOUR BATTERY PACK (See Fig. A)

CHARGING PROCEDURE

Plug the charger plug into a suitable power outlet. Next, connect the charger (9) to the charging socket (10) on the tool. The light will turn to red to indicate the charging process has started. Let the battery charge for 1 hour. The light will go off to show the tool is fully charged. After the battery is fully charged, then unplug the charger. Disconnect the charger from the tool. The tool is ready to be used.

NOTE: If the tool is too hot, the light will flash red when charging. Please cool the tool before charging.

Important: When charging, the charger and tool may become warm to the touch, this is normal and does not indicate a problem.

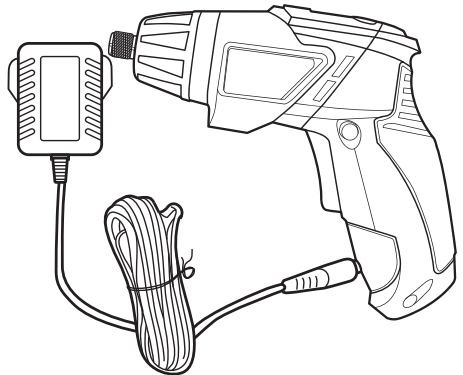

Fig. A

C) BATTERY CAPACITY INDICATOR (See Fig. B)

Your tool is equipped with battery capacity indicator. Press the battery capacity indicator button (7) to show the amount of charge left in the battery.

Light	Status
Red on	0-33%
Red on +Yellow on	33%-66%
Red on +Yellow on + Green on	66%-100%
Green on	Fully Charged

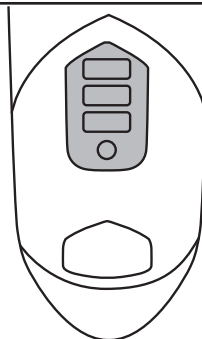

Fig. B

Red flash

Battery Temperature Protection

The temperature of battery pack is less than 0° or more than 40°.

OPERATION

1. COLLET LOCKING SLEEVE (See Fig. C)

Pull the collet locking sleeve (1) backward. Fully insert the desired bit into the chuck and release the collet locking sleeve (1). The collet accepts only standard 1/4" hexagonal shank accessories with power groove.

NOTE: Do not use this tool as a drill. Tools equipped with shut off clutches are not designed for drilling applications.

The clutch can shut off automatically and without warning. Attempting to restart drilling after shut-off has been reached can cause the tool to twist out of your hand until the clutch again reaches shut off.

NOTE: Do not attempt to insert quick change type drill bits into this chuck.

NOTE: Try to pull the bit after releasing the collet locking sleeve to make sure the bit is fully locked.

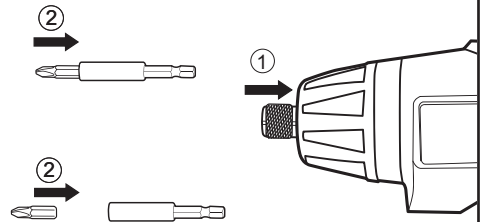

Fig. C

2. REMOVING A BIT HOLDER, SOCKET OR SCREWDRIVER BIT

Pull the collet locking sleeve (1) backward. Take the tool out of the chuck and release the collet locking sleeve (1).

3. ON/OFF SWITCH (See Fig. D)

Depress the on/off switch (5) to start and release to stop your driver.

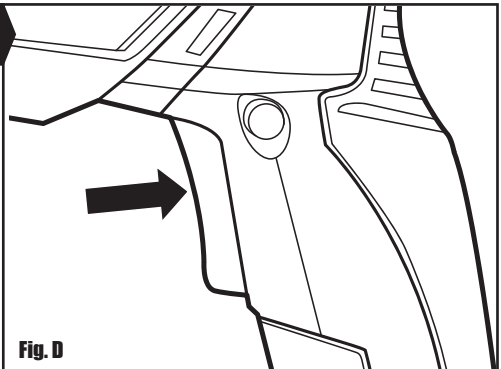

Fig. D

4. FORWARD, REVERSE ROTATION AND LOCK CONTROL(See Fig. E1, E2)

Your tool is equipped with a forward, reverse rotation and lock control (4) located above the on/off switch (6). It was designed for changing rotation of the chuck and for locking the on/off switch (6) in the center position to help prevent accidental start and accidental battery discharge. The screwdriver has forward/reverse function, press the forward/reverse rotating control to the right (See Fig. E1), it is forward function, then press the forward/reverse rotating control to the left (See Fig. E2), it is reverse function.

WARNING! Do not change direction of rotation until the tool comes to a complete stop. Shifting during rotation of the chuck can cause damage to the tool.

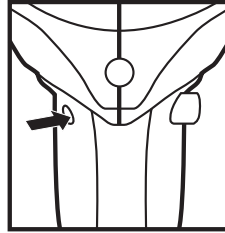

Fig. E1

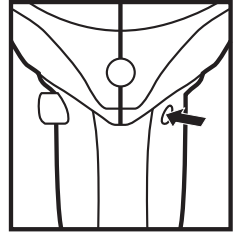

Fig. E2

5. USING THE WORK LIGHT

The work light (3) will illuminate whenever the trigger is pressed. LED lighting increases visibility, great for dark or enclosed areas.

6. ROTATING HANDLE (See Fig. F)

This machine can be used with a straight handle or pistol grip. Press the button (8) and hold it while adjusting the handle to desired position. Release the button to lock the handle.

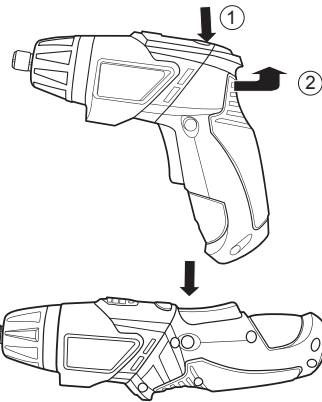



Fig. F

7. TORQUE ADJUSTMENT

The torque is adjusted by rotating the torque adjustment ring (2). The torque is greater when the torque adjustment ring is set on a higher setting. The torque is less when the torque adjustment ring is set on a lower setting.

Make the setting as follows:

1-3	for driving small screws
4-6	for driving screws into soft material
	for drilling purpose

8. DISPOSAL OF AN EXHAUSTED BATTERY PACK



To preserve natural resources, please recycle or dispose of the battery pack properly. This battery pack contains Lithium batteries. Consult your local waste authority for information regarding available recycling and/or disposal options. Discharge your battery pack by operating your drill, then remove the battery pack from the drill housing and cover the battery pack connections with heavy-duty adhesive tape to prevent short circuit and energy discharge. Do not attempt to open or remove any of the components.

9. OVERLOAD PROTECTION

When overloaded, the motor comes to a stop. Relieve the load on the machine immediately and allow cooling for approx. 30 seconds at the highest no-load speed.

10. TEMPERATURE DEPENDENT OVERLOAD PROTECTION

This power tool has over-load protection built in. If the load is too high or the battery temperature exceeds 75°C, the electronic control switches off the power tool until the battery has cooled.

11. PROTECTION AGAINST DEEP DISCHARGING

The Li-ion battery is protected against deep discharging by the "Discharging Protection System". When the battery is empty, the machine is switched off by means of a protective circuit: The inserted tool no longer rotates.

TROUBLESHOOTING

1. WHY DOES THE DRIVER NOT TURN WHEN YOU PRESS THE SWITCH?

The forward/reverse rotation control (4), which is on top of the on/off switch (5), is positioned in the lock function. Unlock the forward/reverse rotation control by putting it into the required rotation position. Push the trigger and the drill will start to rotate.

2. REASONS FOR DIFFERENT BATTERY PACK WORKING TIMES

Charging time problems, as above, and having not used a battery pack for a prolonged time will reduce the battery pack working time. This can be corrected after several charge and discharge operations by charging & working with your driver. Heavy working conditions such as large screws into hard wood will use up the battery pack energy faster than lighter working conditions. Do not re-charge your battery pack below 0°C and above 40°C as this will affect performance.

MAINTENANCE

Your tool requires no additional lubrication or maintenance.
There are no user serviceable parts in your power tool. Never use water or chemical cleaners to clean your power tool. Wipe clean with a dry cloth. Always store your power tool in a dry place. Keep the motor ventilation slots clean. Keep all working controls free of dust. Occasionally you may see sparks through the ventilation slots. This is normal and will not damage your power tool.

For Battery tools

The ambient temperature range for the use and storage of tool and battery is 0°C-45°C.
The recommended ambient temperature range for the charging system during charging is 0°C-40°C.

ENVIRONMENTAL PROTECTION



Waste electrical products must not be disposed of with household waste. Please recycle where facilities exist.
Check with your local authorities or retailer for recycling advice.

DECLARATION OF CONFORMITY

We,
Wickes Building Supplies Limited

Declare that this product: CORDLESS SCREWDRIVER

Description and SKU code: 223751

Complies with the following Directives and Regulations:

2006/42/EC, Machinery Directive

2014/30/EU, Electromagnetic Compatibility Directive

2011/65/EU & (EU)2015/863 (RoHS), Restriction of Hazardous Substances Directive

2014/35/EU, Low Voltage Directive

and conforms to the following standards:

Standards specific to this product:

EN 55014-1

EN 55014-2

EN 62841-1

EN 62841-2-2

EN 60335-1

EN 60335-2-29

EN 62233

EN 61000-3-2

EN 61000-3-3

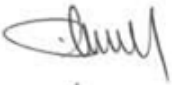

28th January, 2021

Philip Ansell

Category Technical Manager

Wickes

Vision House

19 Colonial Way

Watford

WD24 4JL”

Customer Helpline 0345 2005409