

Wickes

CORDLESS JIGSAW

18V LITHIUM



CSJ18W.1
223750

CONTENTS

GENERAL POWER TOOL SAFETY WARNINGS 3

GENERAL SAFETY WARNINGS FOR BATTERY CHARGER 6

COMPONENT LIST 7

ACCESSORIES 8

SYMBOLS 8

TECHNICAL DATA 9

NOISE INFORMATION 9

OPERATING INSTRUCTIONS 11

WORKING HINTS FOR YOUR JIGSAW 16

MAINTENANCE 16

TROUBLESHOOTING 18

ENVIRONMENTAL PROTECTION 18

DECLARATION OF CONFORMITY 20

ORIGINAL INSTRUCTION

GENERAL POWER TOOL SAFETY WARNINGS

 **WARNING!** Read all safety warnings, instructions, illustrations and specifications provided with this power tool. Failure to follow all instructions listed below may result in electric shock, fire and/or serious injury.

SAVE ALL WARNINGS AND INSTRUCTIONS FOR FUTURE REFERENCE.

The term "power tool" in the warnings refers to your mains-operated (corded) power tool or battery-operated (cordless) power tool.

1. WORK AREA SAFETY

- a) **Keep work area clean and well lit.** Cluttered or dark areas invite accidents.
- b) **Do not operate power tools in explosive atmospheres, such as in the presence of flammable liquids, gases or dust.** Power tools create sparks which may ignite the dust or fumes.
- c) **Keep children and bystanders away while operating a power tool.** Distractions can cause you to lose control.

2. ELECTRICAL SAFETY

- a) **Power tool plugs must match the outlet. Never modify the plug in any way. Do not use any adapter plugs with earthed (grounded) power tools.** Unmodified plugs and matching outlets will reduce risk of electric shock.
- b) **Avoid body contact with earthed or grounded surfaces, such as pipes, radiators, ranges and refrigerators.** There is an increased risk of electric shock if your body is earthed or grounded.
- c) **Do not expose power tools to rain or wet conditions.** Water entering a power tool will increase the risk of electric shock.
- d) **Do not abuse the cord. Never use the cord for carrying, pulling or unplugging the power tool. Keep cord away from heat, oil, sharp edges or moving parts.** Damaged or entangled cords increase the risk of electric shock.
- e) **When operating a power tool outdoors, use an extension cord suitable for outdoor use.** Use of a cord suitable for outdoor use reduces the risk of electric shock.
- f) **If operating a power tool in a damp location is unavoidable, use a residual current device (RCD) protected supply.** Use of an RCD reduces the risk of electric shock.

3. PERSONAL SAFETY

- a) **Stay alert, watch what you are doing and use common sense when operating a power tool. Do not use a power tool while you are tired or under the influence of drugs, alcohol or medication.** A moment of inattention while operating power tools may result in serious personal injury.
- b) **Use personal protective equipment. Always wear eye protection.** Protective equipment such as dust mask, non-skid safety shoes, hard hat, or hearing protection used for appropriate conditions will reduce personal injuries.
- c) **Prevent unintentional starting. Ensure the switch is in the off-position before connecting to power source and/or battery pack, picking up or carrying the tool.** Carrying power tools with your finger on the switch or energising power tools that have the switch on invites accidents.
- d) **Remove any adjusting key or wrench before turning the power tool on.** A wrench or a key left attached to a rotating part of the power tool may result in personal injury.
- e) **Do not overreach. Keep proper footing and balance at all times.** This enables better control of the power tool in unexpected situations.
- f) **Dress properly. Do not wear loose clothing or jewellery. Keep your hair and clothing away from moving parts.** Loose clothes, jewellery or long hair can be caught in moving parts.
- g) **If devices are provided for the connection of dust extraction and collection facilities, ensure these are connected and properly used.** Use of dust collection can reduce dust-related hazards.
- h) **Do not let familiarity gained from frequent use of tools allow you to become complacent and ignore tool safety principles.** A careless action can cause severe injury within a fraction of a second.

4. POWER TOOL USE AND CARE

- a) **Do not force the power tool. Use the correct power tool for your application.** The correct power tool will do the job better and safer at the rate for which it was designed.
- b) **Do not use the power tool if the switch does not turn it on and off.** Any power tool that cannot be controlled with the switch is dangerous and must be repaired.
- c) **Disconnect the plug from the power source and/**

GENERAL POWER TOOL SAFETY WARNINGS

or remove the battery pack, if detachable, from the power tool before making any adjustments, changing accessories, or storing power tools.

Such preventive safety measures reduce the risk of starting the power tool accidentally.

d) Store idle power tools out of the reach of children and do not allow persons unfamiliar with the power tool or these instructions to operate the power tool. Power tools are dangerous in the hands of untrained users.

e) Maintain power tools and accessories. Check for misalignment or binding of moving parts, breakage of parts and any other condition that may affect the power tool's operation. If damaged, have the power tool repaired before use. Many accidents are caused by poorly maintained power tools.

f) Keep cutting tools sharp and clean. Properly maintained cutting tools with sharp cutting edges are less likely to bind and are easier to control.

g) Use the power tool, accessories and tool bits etc. in accordance with these instructions, taking into account the working conditions and the work to be performed. Use of the power tool for operations different from those intended could result in a hazardous situation.

h) Keep handles and grasping surfaces dry, clean and free from oil and grease. Slippery handles and grasping surfaces do not allow for safe handling and control of the tool in unexpected situations.

5. BATTERY TOOL USE AND CARE

a) Recharge only with the charger specified by the manufacturer. A charger that is suitable for one type of battery pack may create a risk of fire when used with another battery pack.

b) Use power tools only with specifically

designated battery packs. Use of any other battery packs may create a risk of injury and fire.

c) When battery pack is not in use, keep it away from other metal objects, like paper clips, coins, keys, nails, screws or other small metal objects, that can make a connection from one terminal to another. Shorting the battery terminals together may cause burns or a fire.

d) Under abusive conditions, liquid may be ejected from the battery; avoid contact. If contact accidentally occurs, flush with water. If liquid contacts eyes, additionally seek medical help. Liquid ejected from the battery may cause irritation or burns.

e) Do not use a battery pack or tool that is damaged or modified. Damaged or modified batteries may exhibit unpredictable behaviour resulting in fire, explosion or risk of injury.

f) Do not expose a battery pack or tool to fire or excessive temperature. Exposure to fire or temperature above 130 °C may cause explosion.

g) Follow all charging instructions and do not charge the battery pack or tool outside the temperature range specified in the instructions. Charging improperly or at temperatures outside the specified range may damage the battery and increase the risk of fire.

6. SERVICE

a) Have your power tool serviced by a qualified repair person using only identical replacement parts. This will ensure that the safety of the power tool is maintained.

b) Never service damaged battery packs. Service of battery packs should only be performed by the manufacturer or authorized service providers.

JIG SAW SAFETY WARNINGS

- 1. Hold reciprocating saw by insulated gripping surfaces, when performing an operation where the cutting accessory may contact hidden wiring.** *Cutting accessory contacting a "live" wire may make exposed metal parts of the power tool "live" and could give the operator an electric shock.*
- 2. Use clamps or another practical way to secure and support the workpiece to a stable platform.** *Holding the work by hand or against your body leaves it unstable and may lead to loss of control.*

SAFETY WARNINGS FOR BATTERY PACK

- a) Do not dismantle, open or shred cells or battery pack.**
- b) Do not short-circuit a battery pack. Do not store battery packs haphazardly in a box or drawer where they may short-circuit each other or be short-circuited by conductive materials.** *When battery pack is not in use, keep it away from other metal objects, like paper clips, coins, keys, nails, screws or other small metal objects, that can make a connection from one terminal to another. Shorting the battery terminals together may cause burns or a fire.*
- c) Do not expose battery pack to heat or fire. Avoid storage in direct sunlight.**
- d) Do not subject battery pack to mechanical shock.**
- e) In the event of battery leaking, do not allow the liquid to come into contact with the skin or eyes. If contact has been made, wash the affected area with copious amounts of water and seek medical advice.**
- f) Seek medical advice immediately if a cell or battery pack has been swallowed.**
- g) Keep battery pack clean and dry.**
- h) Wipe the battery pack terminals with a clean dry cloth if they become dirty.**
- i) Battery pack needs to be charged before use. Always refer to this instruction and use the correct charging procedure.**
- j) Do not maintain battery pack on charge when not in use.**
- k) After extended periods of storage, it may be necessary to charge and discharge the battery pack several times to obtain maximum performance.**
- l) Battery pack gives its best performance when it is operated at normal room temperature (20 °C ± 5 °C).**
- m) When disposing of battery packs, keep battery packs of different electrochemical systems separate from each other.**
- n) Recharge only with the charger specified by manufacturer. Do not use any charger other than that specifically provided for use with the equipment.** *A charger that is suitable for one type of battery pack may create a risk of fire when used with another battery pack.*
- o) Do not use any battery pack which is not designed for use with the equipment.**
- p) Keep battery pack out of the reach of children.**
- q) Retain the original product literature for future reference.**
- r) Remove the battery from the equipment when not in use.**
- s) Dispose of properly.**
- t) Do not mix cells of different manufacture, capacity, size or type within a device.**
- u) Do not remove battery pack from its original packaging until required for use.**
- v) Observe the plus (+) and minus (-) marks on the battery and ensure correct use.**

GENERAL SAFETY WARNINGS FOR BATTERY CHARGER



WARNING! Read all safety warnings and all instructions. Failure to follow the warnings and instructions may result in electric shock, fire and/or serious injury.

Save all warnings and instructions for future reference.

This appliance can be used by children aged from 8 years and above and persons with reduced physical, sensory or mental capabilities or lack of experience and knowledge if they have been given supervision or instruction concerning use of the appliance in a safe way and understand the hazards involved. Children shall not play with the appliance. Cleaning and user maintenance shall not be made by children without supervision.

Additional safety instructions for your battery charger

1. Before charging, read the instructions.
2. Do not charge a leaking battery.
3. Do not use chargers for purposes other than those for which they are designed.
4. Before charging, ensure your local power supply matches that required for your charger.
5. For indoor use only.
6. The charging device must be protected from moisture.
7. Do not short out the contacts of battery or charger.
8. Respect the polarity “+/-“ when charging.
9. Do not open the unit
10. Keep out of the reach of children.
11. Ensure that the connection between the battery charger and battery is correctly positioned and is not obstructed by foreign bodies.
12. Keep battery charger's slots are free of foreign objects and protect against dirt and humidity. Store in a dry and frost-free place.
13. When charging batteries, ensure that the battery charger is in a well-ventilated area and away from inflammable materials. Batteries can get hot during charging. Do not overcharge any batteries. Ensure that batteries and chargers are not left unsupervised during charging.
14. Do not recharge non-rechargeable batteries, as they can overheat and break.
15. Longer life and better performance can be obtained if the battery pack is charged when the air temperature is between 18°C and 24°C. Do not charge the battery pack in air temperatures below 0°C, or above 40°C. This is important as it can prevent serious damage to the battery pack.
16. Charge only battery pack of the same model provided by manufacturer and of models recommended by manufacturer.

COMPONENT LIST

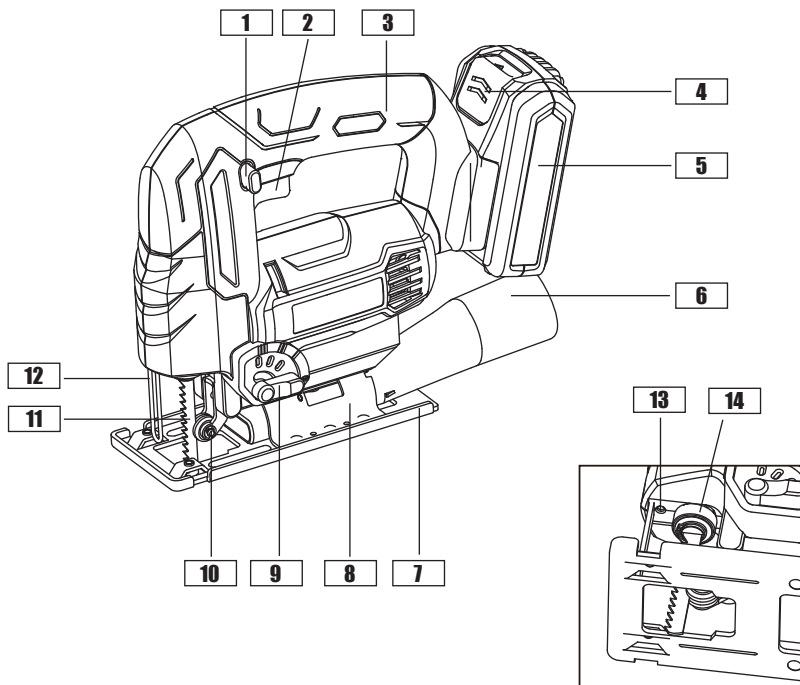

- 1** Lock-off button
- 2** On/off switch
- 3** Hand grip areas
- 4** Battery pack release button
- 5** Battery pack
- 6** Vacuum adapter
- 7** Base plate
- 8** Angle plate

- 9** Pendulum action control
- 10** Roller guide
- 11** Saw blade
- 12** Finger protection
- 13** LED light
- 14** Tool-free blade holder
- 15** Hex key (See Fig. B)
- 16** Charger (See Fig. E)

ACCESSORIES

1 hr charger (ACG118W3)	1
2.0 Ah Li-ion battery pack (ABP1820HW)	1
Wood cutting blade	1
Hex key	1
Vacuum adapter	1

We recommend that you purchase your accessories from the same store that sold you the tool. Refer to the accessory packaging for further details. Store personnel can assist you and offer advice.

SYMBOLS



To reduce the risk of injury, read all of this instruction manual



Warning



Wear ear protection



Wear eye protection



Wear dust mask



Indoor use only



Do not burn



Batteries may enter water cycle if disposed improperly, which can be hazardous for ecosystem. Do not dispose of waste batteries as unsorted municipal waste.



Read the operator's manual.



Li-Ion



Li-ion battery. This product has been marked with a symbol relating to 'separate collection' for all battery packs and battery pack. It will then be recycled or dismantled in order to reduce the impact on the environment. Battery packs can be hazardous for the environment and for human health since they contain hazardous substances.



Double insulated

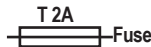

Fuse



Positive terminal



Negative terminal



Waste electrical products must not be disposed of with household waste. Please recycle where facilities exist. Check with your local authorities or retailer for recycling advice.

TECHNICAL DATA

Voltage	18V- Nominal 
No load speed	0-2500/min
Stroke length	24mm
Cutting capacity	
Wood	80mm
Steel	8mm
PVC pipe	20mm
Bevel capacity	±45°
Machine weight	1.46kg
Charger Protection class	 II
Charging time	1hr
Charger Input	100-240V~50/60Hz, 55W
Charger Output	20VDC 2.0A
Battery capacity	2.0Ah Li-ion battery
Battery Model	ABP1820HW
Charger Model	ACG118W3

For additional battery technical data, refer to the rating plate on the battery pack.

NOISE INFORMATION

A weighted sound pressure	L_{pA} : 80.7 dB(A)
A weighted sound power	L_{wA} : 91.7 dB(A)
K_{pA} & K_{wA}	3.0 dB(A)
Wear ear protection.	

VIBRATION INFORMATION

Vibration total values (triax vector sum) determined according to EN 62841:	
Cutting boards	Vibration emission value $a_{h,B} = 5.906 \text{ m/s}^2$
	Uncertainty $K = 1.5 \text{ m/s}^2$
Cutting steel metal	Vibration emission value $a_{h,M} = 6.756 \text{ m/s}^2$
	Uncertainty $K = 1.5 \text{ m/s}^2$

The declared vibration total value and the declared noise emission value have been measured in accordance with a standard test method and may be used for comparing one tool with another.

The declared vibration total value and the declared noise emission value may also be used in a preliminary assessment of exposure.

WARNING! The vibration and noise emissions during actual use of the power tool can differ from the declared value depending on the ways in which the tool is used especially what kind of workpiece is processed dependant on the following examples and other variations on how the tool is used:

How the tool is used and the materials being cut or drilled.

The tool being in good condition and well maintained.

The use of the correct accessory for the tool and ensuring it is sharp and in good condition.

The tightness of the grip on the handles and if any anti vibration and noise accessories are used.

And the tool is being used as intended by its design and these instructions.

This tool may cause hand-arm vibration syndrome if its use is not adequately managed.

WARNING! To be accurate, an estimation of exposure level in the actual conditions of use should also take account of all parts of the operating cycle such as the times when the tool is switched off and when it is running idle but not actually doing the job. This may significantly reduce the exposure level over the total working period, helping to minimize your vibration exposure risk.

Always use sharp chisels, drills and blades.

Maintain this tool in accordance with these instructions and keep well lubricated (where appropriate).

If the tool is to be used regularly then invest in anti vibration and noise accessories.

Plan your work schedule to spread any high vibration tool use across a number of days.

OPERATING INSTRUCTIONS



NOTE: Before using the tool, read the instruction book carefully.

Intended Use

The machine is intended for sawing wood, plastic, metal and building materials while resting firmly on the workpiece. It is suitable for straight and curved cuts with bevel angles to 45°. The saw blade recommendations are to be observed.

ASSEMBLY AND ADJUSTING

1. BLADE FITTING (SEE FIG. A1-A4)



WARNING: Before any work on the tool itself, remove the battery pack. Wear protective gloves when assembling the saw blade.



WARNING: Blade teeth are very sharp. For best cutting results ensure you use a blade suited to the material and cut quality you need.

NOTE: You can only use the blade type shown in Fig. A1. Don't use other blade types.

- Inserting the saw blade

- 1) Open the tool-free blade holder by rotating the ring anti-clockwise (jigsaw upside down) and hold it in position. (SEE FIG. A2).
- 2) Fully insert the blade into the blade holder slot with blade teeth facing forward. (See Fig. A2)
- 3) Release the blade holder ring, which will self rotate back to clamp over the top of the blade. Push the blade into the blade holder again to ensure it is locked in position.
- 4) Ensure the edge of the blade is located in the groove of the blade guide (SEE FIG. A3).

- Removing the saw blade (See Fig. A4)

To remove a blade, hold the blade and rotate the blade holder ring anti-clockwise (jigsaw upside down), then lift out the blade (Note that blade could be spring ejected).



T-type Shank

Fig. A1

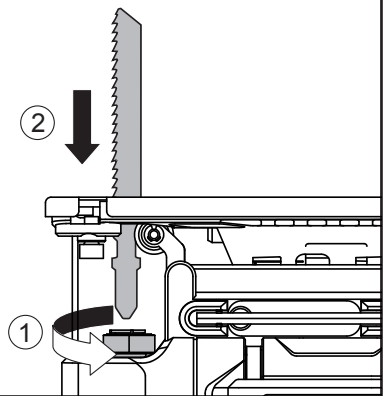

Fig. A2

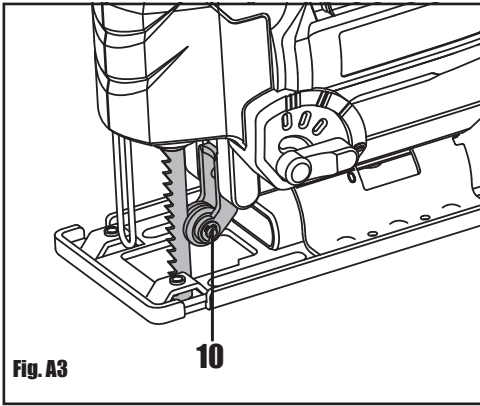

Fig. A3

10

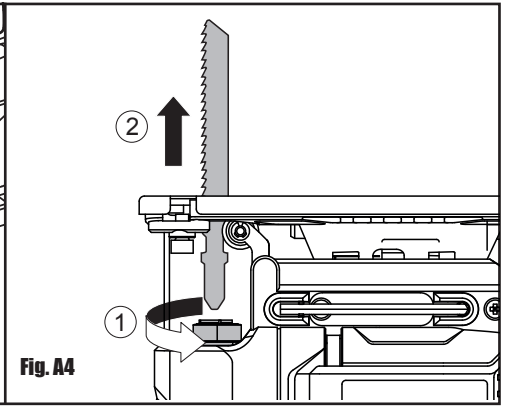

Fig. A4

2. ROLLER GUIDE

Ensure the blade is located and runs smoothly in the groove (SEE FIG. A3), otherwise the pendulum function will not work correctly and the blade will not be supported during cutting.

3. HEX KEY STORAGE (SEE FIG. B)

The hex key (15) is placed at the position as shown.

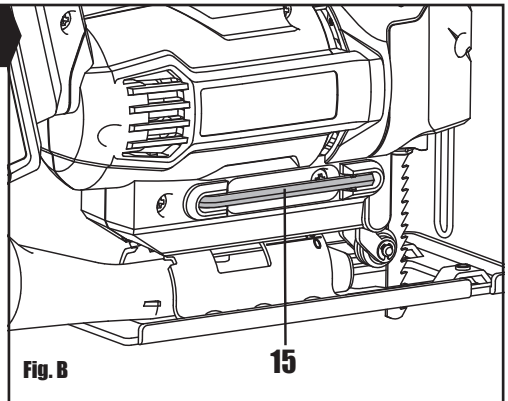

Fig. B

15

4. ADJUSTING THE CUTTING ANGLE (SEE FIG. C1 - C4)

- 1) Using the supplied hex key to loosen the bolts securing the base plate by turning the bolt anti-clockwise. (See Fig. C1)
- 2) Slide the base plate backwards to be loose. (See Fig. C1)
- 3) Rotate the base plate to a required angle (0°, 15°, 30°, 45°). For other miter angles, rotate to your desired angle (use a protractor scale). (See Fig. C2)
- 4) Hold the base plate in position, slide the base plate forwards to match the groove to lock. (See Fig. C3)
- 5) Firmly tighten the bolt by turning the bolt clockwise to clamp the base plate at the desired angle. (See Fig. C4) Check the angle and ensure the base plate is firmly clamped.

NOTE: The angle markings on the base plate are accurate for most general purposes but it is recommended for accurate work to set the angle with a protractor and make a test cut on other material.

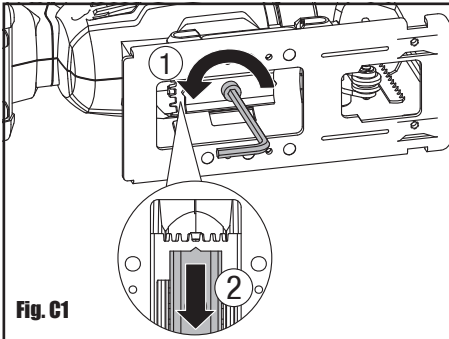

Fig. C1

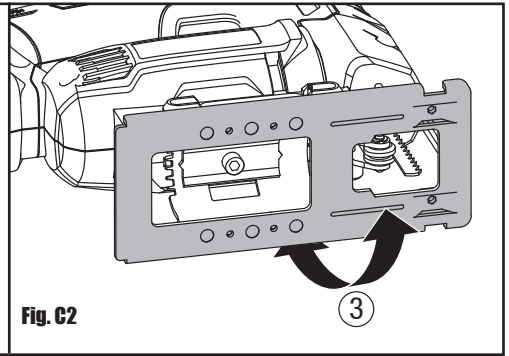

Fig. C2

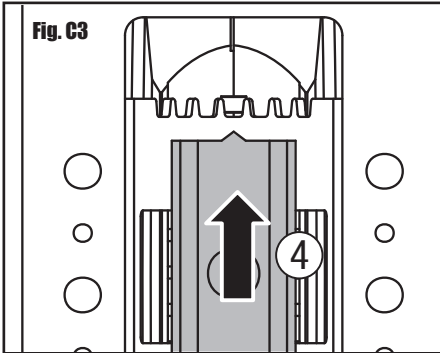

Fig. C3

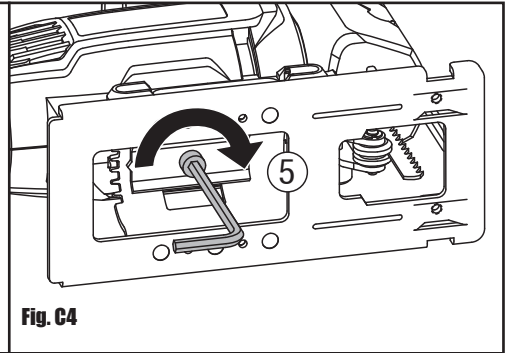

Fig. C4

5. DUST TUBE (SEE FIG. D1, D2)

Directly insert the vacuum adapter into the angle plate, be sure to insert it into the end. To remove, just pull out the vacuum adapter from the angle plate.

NOTE: Use of vacuum extraction does not negate the need to wear personal protective equipment, especially respiratory protective equipment.

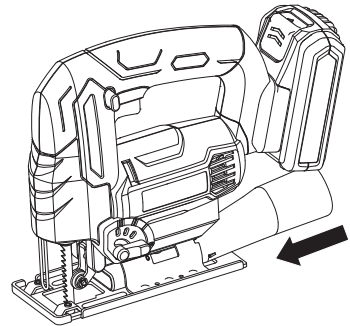

Fig. D1

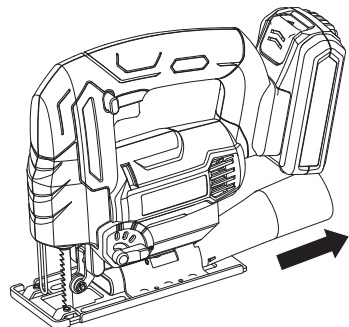

Fig. D2

BEFORE PUTTING INTO OPERATION

1. CHARGING THE BATTERY PACK

WARNING: The charger and battery pack are specially designed to work together so do not attempt to use any other devices. Never insert or allow metallic objects into your charger or battery pack connections because an electrical failure and hazard will occur.

NOTE:

- If the battery pack is very hot you must remove your battery pack from the charger and allow your battery pack to cool first to ambient temperature and then recharging can be started.
- The battery must be fully charged before storage. If the tool is not used for long periods, recharge the battery at least every 3-6 months.

2. HOW TO CHARGE YOUR BATTERY PACK (SEE FIG. E)

CHARGING PROCEDURE

- Plug the charger into an appropriate outlet. The light will be green.
- Slide the battery pack into the charger, the light will turn to red to indicate the charging process has started.
- When charging is completed, the light will turn to green. The pack is now fully charged, unplug the charger and remove the battery pack.

WARNING: If the battery pack is warm e.g. after continuous use or after exposure to direct sunlight or heat, allow time to cool down before re-charging to achieve the full charge.

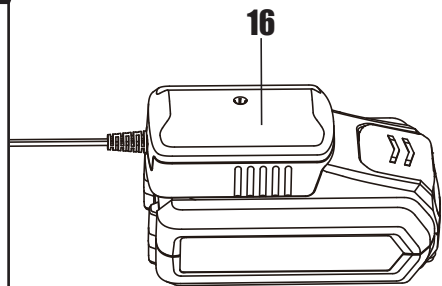

Fig. E

CHARGING INDICATOR

Light	Status
Red on ● []	Charging
Green on ● []	Fully Charged

3. TO REMOVE THE BATTERY PACK (SEE FIG. F1)

Depress the battery pack release button firmly first and then slide the battery pack out from your tool.

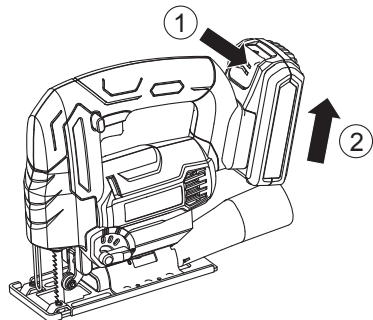

Fig. F1

4. TO INSTALL THE BATTERY PACK (SEE FIG. F2)

Slide the fully charged battery pack onto the tool with sufficient force until it clicks into position.

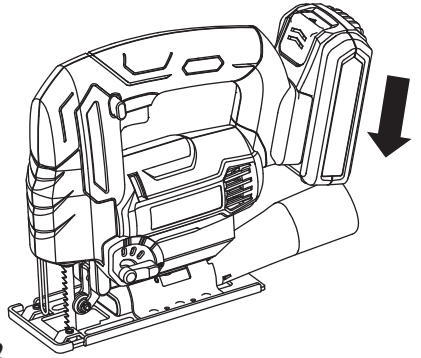

Fig. F2

OPERATION

1. HAND GRIP AREAS

Always ensure you maintain a firm grip whilst operating your jigsaw.

2. LOCK OFF SWITCH (SEE FIG. G)

The lock off switch is used to prevent unintentional starting. For starting operation of the tool, first depress the lock-off button and hold it in position, then press the on/off switch and release it to start operation. For safety reasons the on/off switch cannot be locked; it must remain pressed during the entire operation.

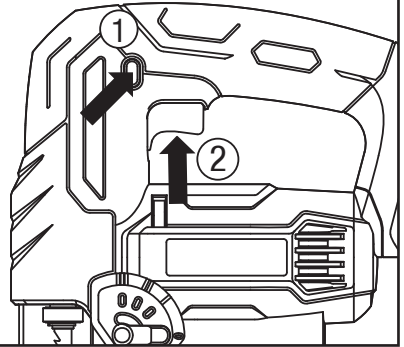

Fig. G

3. FINGER PROTECTION

The finger protection is located in front of the blade holder. Whilst working, it will help prevent accidental contact with moving blade.

4. LED LIGHT

After press the on/off switch to start, the LED light (13) will be on while working. The light will be off when the machine stops.

5. PENDULUM ACTION CONTROL (SEE FIG. H)

The pendulum action varies the forward cutting angle of the blade for increased cutting efficiency. This can also be adjusted during no load running. Refer to the chart 1 for more details. Do not use excessive blade force when cutting with the pendulum action. The blade cuts on the upward stroke only.

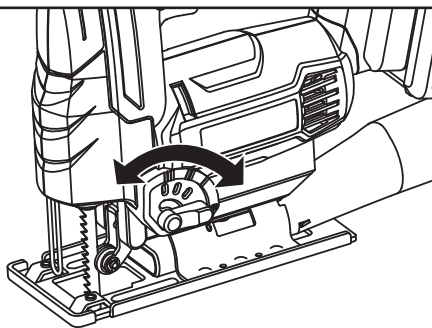

Fig. H

Chart 1	
0	Thin materials. Fine cuts. Tight curves.
I	Hard materials, (e.g. steel & chipboard)
II	Thick materials (e.g. wood) & plastic
III	Fast cuts (e.g. softwood). Cutting in the direction of the wood grain.

WORKING HINTS FOR YOUR JIGSAW

If your jig saw becomes too hot, especially when used at low speed, set the speed to maximum and run no Load for 2-3 minutes to cool the motor. Avoid prolonged usage at very low speeds.

GENERAL

Always use a blade suited to the material and material thickness to be cut. Always ensure the work-piece is firmly held or clamped to prevent movement. For easier control, use low speed to start cutting, then increase to correct speed.

Any movement of the material may affect the quality of the cut. The blade cuts on the upward stroke and may chip the uppermost surface or face of the work piece. Ensure your uppermost surface is a non-visible surface when your work is finished.

1. CUTTING LAMINATES

Use a fine tooth blade when cutting most laminates and thin wood materials. To reduce edge chipping, clamp pieces of waste wood at both ends on both sides and cut through the waste wood during cutting.

2. CIRCLE CUTTING

Do not use the pendulum action when cutting tight circles or angles.

3. PLUNGE SAWING (SEE FIG. I1, I2)

Plunge cutting may be used only on soft materials such as wood, aerated concrete, gypsum plaster boards, etc. Use only short saw blades.

Place the front edge of the base plate on the workpiece and switch on. Press the tool firmly against the workpiece and plunge the saw blade slowly into the workpiece.

As soon as the complete surface of the base plate rests on the work piece, continue to saw along the cutting line.

Fig. I1

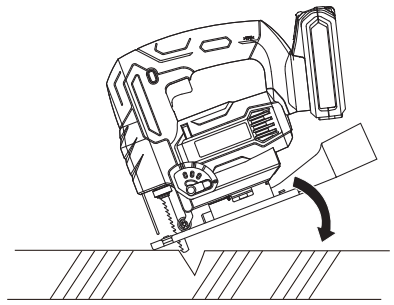
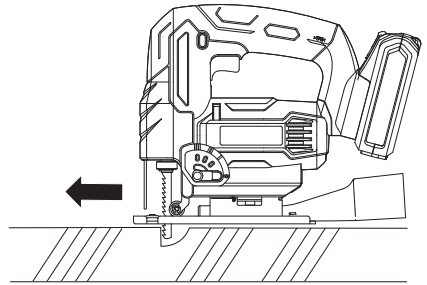

Fig. I2



4. METAL CUTTING

Use a finer tooth blade for ferrous metals and a coarse tooth blade for non-ferrous metals.

When cutting thin sheet metals, always clamp wood on both sides of the sheet to reduce vibration or tearing of the sheet metal. Both wood and sheet metal must be cut. Do not force the cutting blade when cutting thin metal or sheet steel, as they are harder materials and will take longer to cut. Excessive blade force may reduce the life of the blade or damage the motor. To reduce heat during metal cutting, add a little lubricant along the cutting line.

MAINTENANCE

Remove the battery pack from the tool before carrying out any adjustment, servicing or maintenance.

Your tool requires no additional lubrication or maintenance.

There are no user serviceable parts in your power tool. Never use water or chemical cleaners to clean your power tool. Wipe clean with a dry cloth. Always store your power tool in a dry place. Keep the motor ventilation slots clean. Keep all working controls free of dust. Occasionally you may see sparks through the ventilation slots. This is normal and will not damage your power tool.

Remove the battery pack from the tool if the tool is not used for more than 24 hours.

For Battery tools

The ambient temperature range for the use and storage of tool and battery is 0°C-45°C.

The recommended ambient temperature range for the charging system during charging is 0°C-40°C.

TROUBLESHOOTING

Fault	Cause	Remedy
The tool does not start up after switch on.	Battery depleted.	Charge the battery.
	Defective on/off switch.	Contact the service centre.
	Defective motor.	Contact the service centre.
The tool suddenly stops during operation.	Overload	Relieve the load on the machine immediately and allow cooling for approx. 30 seconds by running the machine on no-load.
	Battery temperature too high	
	Low battery capacity	Charge the battery pack.

ENVIRONMENTAL PROTECTION



Waste electrical products must not be disposed of with household waste. Please recycle where facilities exist. Check with your local authorities or retailer for recycling advice.

DECLARATION OF CONFORMITY

We,
Wickes Building Supplies Limited

Declare that this product: CORDLESS JIGSAW

Description and SKU code: 223750

Complies with the following Directives and Regulations:

2006/42/EC, Machinery Directive

2014/30/EU, Electromagnetic Compatibility Directive

2011/65/EU & (EU)2015/863 (RoHS), Restriction of Hazardous Substances Directive

2014/35/EU, Low Voltage Directive

and conforms to the following standards:

Standards specific to this product:

EN 62841-1

EN 62841-2-11

EN 55014-1

EN 55014-2

EN 61000-3-2

EN 61000-3-3

EN 60335-1

EN 60335-2-29

EN 62233

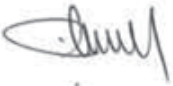

28th January, 2021

Philip Ansell

Category Technical Manager

Wickes

Vision House

19 Colonial Way

Watford

WD24 4JL"

Customer Helpline 0345 2005409