

SAFETY & CARE

1. To retain the best quality finish, clean components regularly with a soft cloth and mild detergents.
2. Do not use abrasive or chemical cleaners on the components, as these will damage the product.
3. Clean the handle with a suitable antibacterial cleaner.
4. Spare heads available if required.
5. Use protective gloves when handle the product.
6. Please retain these instructions for future reference.

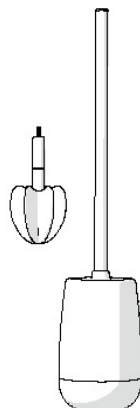

FITTING PACK

AJ510022H SWIPER

A (x1) Base



C (x1) Cover

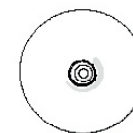

E (x1) O-ring



B (x1) Handle



D (x1) Blade

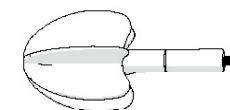

- 1 Slide the swiper cover onto the handle as shown below.

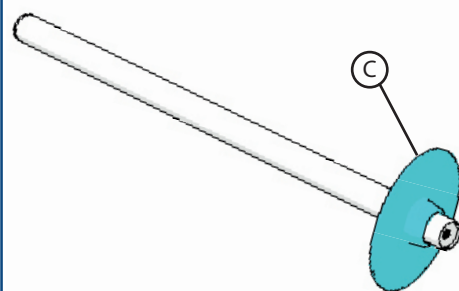
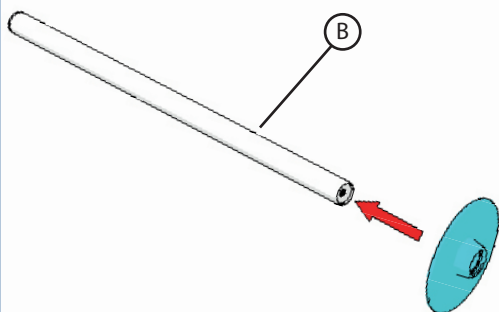

- 2 Tighten the blade unit onto the handle, ensuring the clear o-ring is in place.

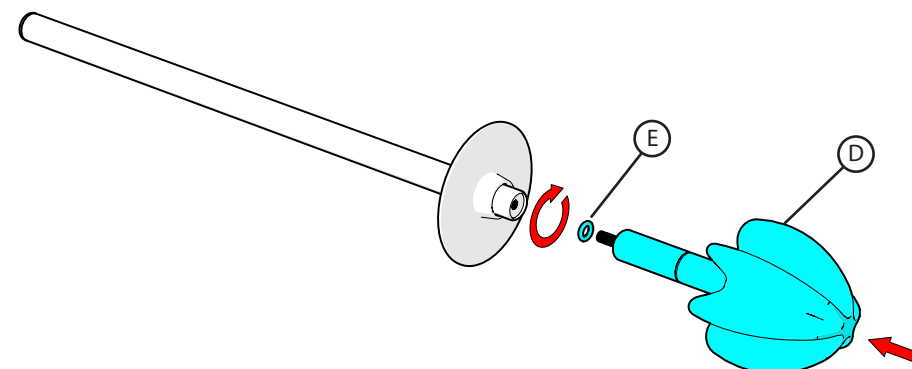

- 4 Push the cover to the fold line as shown below.

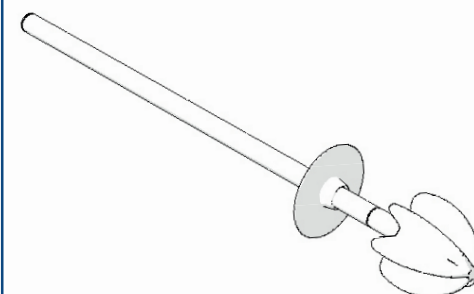
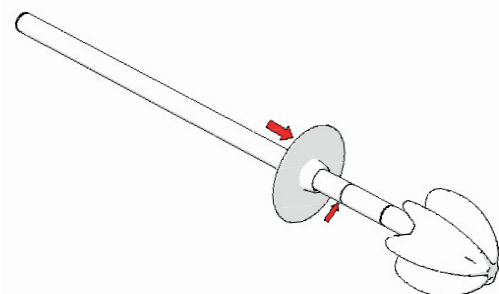

- 6 Place the brush inside the base.

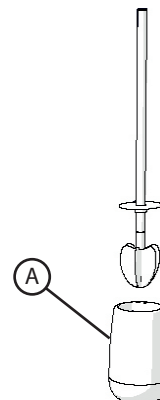

FOR CLEANING

Look to step 1-4 under 'safety & care' for instructions on how to clean the product.



UK: Croydex, Central Way, Andover, Hampshire, SP10 5AW, UK



EU: MIL, Unit 8 Purcellsinch Ind Est, Dublin Road, Kilkenny, R95 HP71, Ireland



+44 (0) 1264 365881



+44 (0) 1264 356437



info@croydex.co.uk



www.croydex.com

OTH 034 R02

Croydex
THINK BATHROOMS