

# 18mm & 22mm STS Construction Board TG4

1200mm x 600mm = 0.72m<sup>2</sup>

## Installation Guide

### 1. Cut boards to size

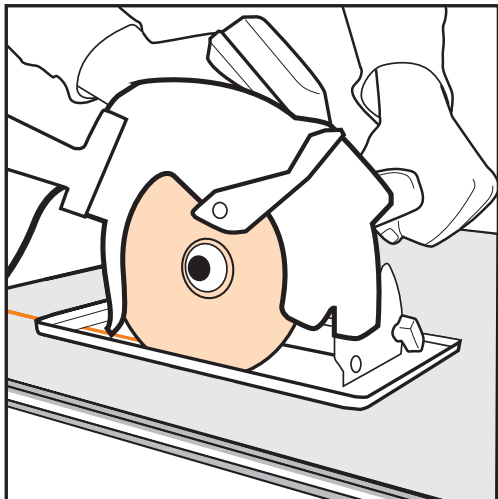

Cut STS Construction Boards TG4 using a circular saw fixed with vacuum extractor and an STS PCD saw blade. This method will cut boards easily and mitigate dust.

### 2. Stick board to joists

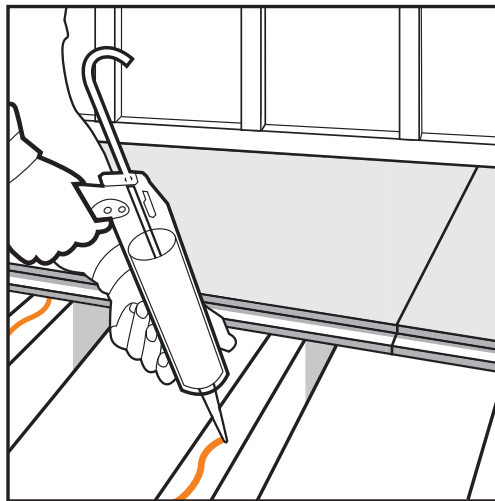

STS Construction Boards TG4 can be fixed to timber or steel joists installed at maximum 600mm centres. To achieve an acceptable finish, it is important that floor joists are level. Apply a bead of STS Mega Strength PU adhesive to the joist, then position the first floor board.

### 3. Screw board to joists

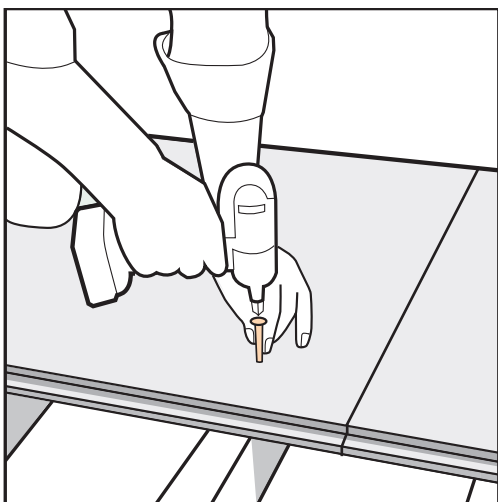

Secure with 12 x 38mm STS Drill Tip screws, placed a minimum of 12mm from the square edge and 5mm from the side of the joist. Ensure screws are placed a minimum distance of 25mm from the tongue and groove edge.

### 4. Seal between boards

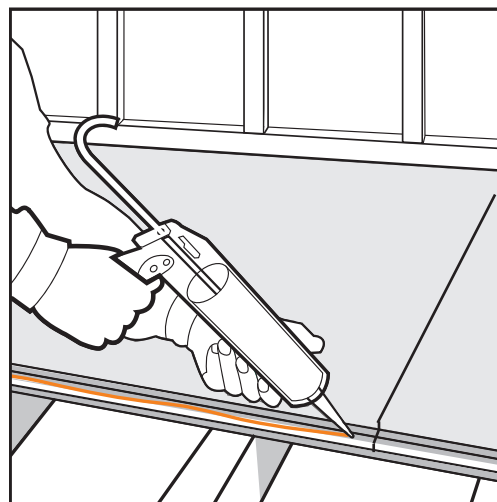

STS Construction Boards TG4 should be laid out in a brick bond pattern. T&G joints do not need to end on a joist but all short, square edges should be fully supported. Secure subsequent boards by applying Mega Strength PU adhesive along the length of the board's groove, before inserting the tongue of the next board. Clean off any surplus adhesive with a damp cloth. STS Construction Boards TG4 are ready to tile or install other surface finish immediately.