

Product Finish: Matt Black

Product code: AT2104
EAN13 barcode: 5060344157643



Product features:

- Metal construction throughout
- Subtle soft sweeping design form
- Single lever control for effortless single handed control
- Supplied complete with flexible tail pipes for fast simple fitting
- Antisplash spout supplied as standard

Additional information / Parts included:

Includes triangular stabilising bracket, 1 x 2.0mm A/F Allen key, 1 x high flow aerator

Note: the image shown may not reflect the product finish, chrome finish is typically depicted.

Product dimensions:

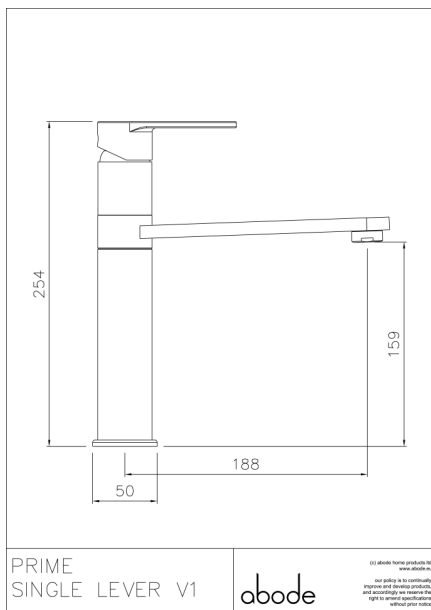

- Overall Height / projection: 254 mm
- Exit reach: 188 mm
- Exit height: 159 mm
- Centre distance(s):

- Base diameter(s): 50 mm
- Recommended hole diameter: Ø 35 mm
- Max. surface depth: 50 mm

- Spout diameter: 35 x 10 mm
- Spout aerator size: M24x1

Packaged properties:

- Box length: 420mm
- Box depth: 75mm
- Box width: 235mm
- Units per outer: 5
- Tap only weight: 0.99kg
- Boxed weight: 1.65kg

Product flow characteristics:

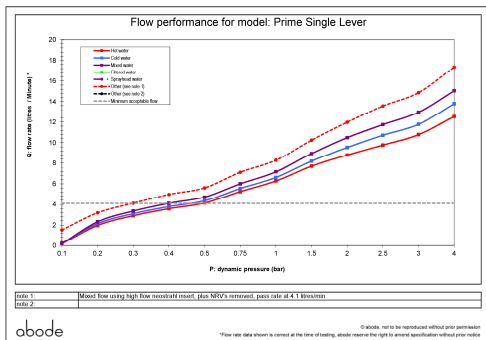

- Min / Max water pressure: 0.3 (4.1L/M no NRV, 0.5 as STD) / 5.50 bar
- Recommended / Max water temperature: 46°C / 70°C
- Part G - Mixed flow rate at 3 bar (litres / min): 13.61

- Control valve type: Single lever ceramic cartridge
- Product flow characteristics: Single flow
- Non return valve(s): Hot & cold (integral to tails)

- Aerator type: Dark blue honeycomb & hi-flow neostrahl
- Accepts revolve / spray areator: Yes
- Spout connection method: N/a

- Tail pipe inlet / outlet size: M10 / 1/2" BSP Male
- Inlet pipe type / length: flexible stainless braided hose / 365 mm

Care instructions summary:

- Clean the mixers and showers regularly as required, using soap, do not use any other cleaners.
- Regular cleaning will prevent the build-up of lime scale and dirt
- After cleaning rinse thoroughly with clean water to remove any cleaner residue
- Residues of sink & worktop cleaners can also cause damage, so rinse with clean water after using, avoid contact with any abrasives

Warranty Summary (Full details available on request):

- Materials and workmanship defects warranted for 5 years
- Valves and working parts warranted for 5 years
- Surface warranty defects warranted for 1 year
- O-rings, hoses & gaskets warranted for 1 year