

Instruction Guide

Floating Shelf Rods

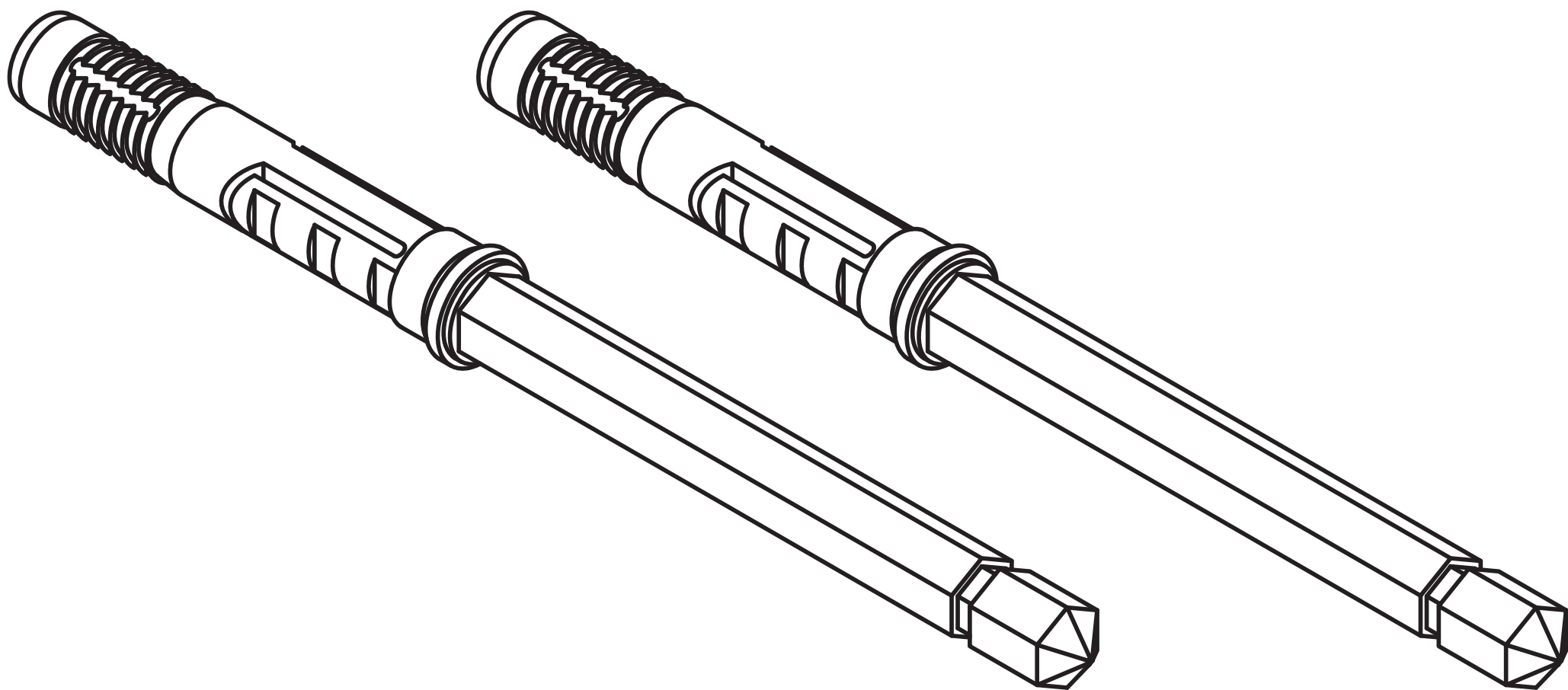

IMPORTANT INFORMATION

Before Installing please identify that you have all the kit parts as listed below.

Proper fitting of this item is **extremely important**.

This is suitable for **DIY** fitments however if the necessary tools and expertise are not available, we would recommend installation by a **qualified tradesperson**.

Ensure your wall is in sound condition prior to fitting.

The floating wall rods provided are for masonry walls only.

Ensure that no hidden pipes or cables will interfere when installing.

Ensure that **eye protection** is worn throughout the installation.



Kit Parts Included

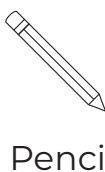

Parts Not Included

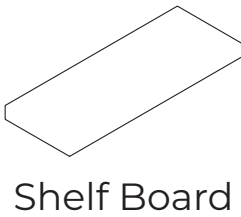

Hole size & depth table for wall & shelf board

(refer to part number on the front of the packaging)

Part Number	Wall	Shelf Board	Max Load (Per Shelf)
BFSS10010	Ø 12mm x 80mm deep.	Ø 10mm x 110mm deep.	13KG
BFSS14510	Ø 12mm x 80mm deep.	Ø 10mm x 150mm deep.	10KG
BFSS12012	Ø 12mm x 80mm deep.	Ø 12mm x 125mm deep.	16KG
BFSS14014	Ø 14mm x 80mm deep.	Ø 14mm x 145mm deep.	23KG

1

Mark position of holes on wall ready for drilling
(Making sure the markings are level)

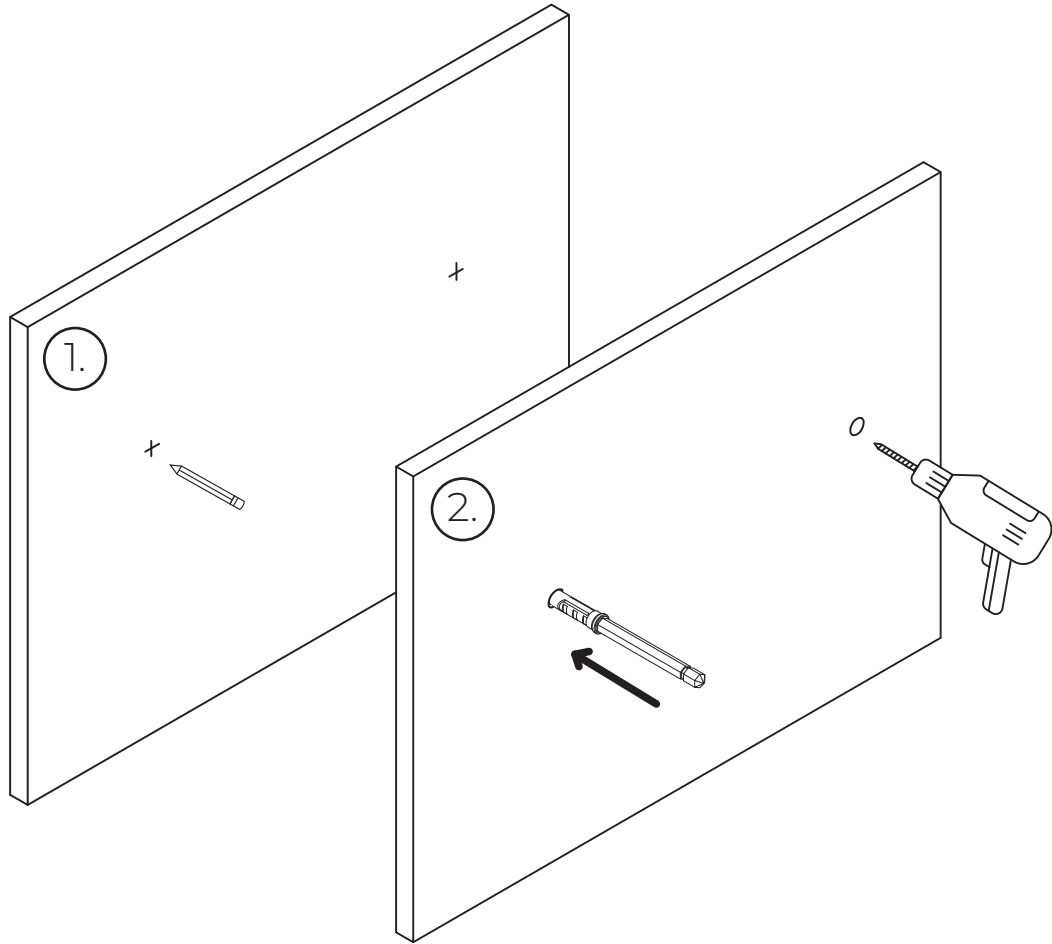

Referring to hole size & depth table, drill holes to the required diameter and depth and insert the floating rod supports into the holes.

2

Use an adjustable wrench to tighten up floating support rod
(Making sure they are tight)

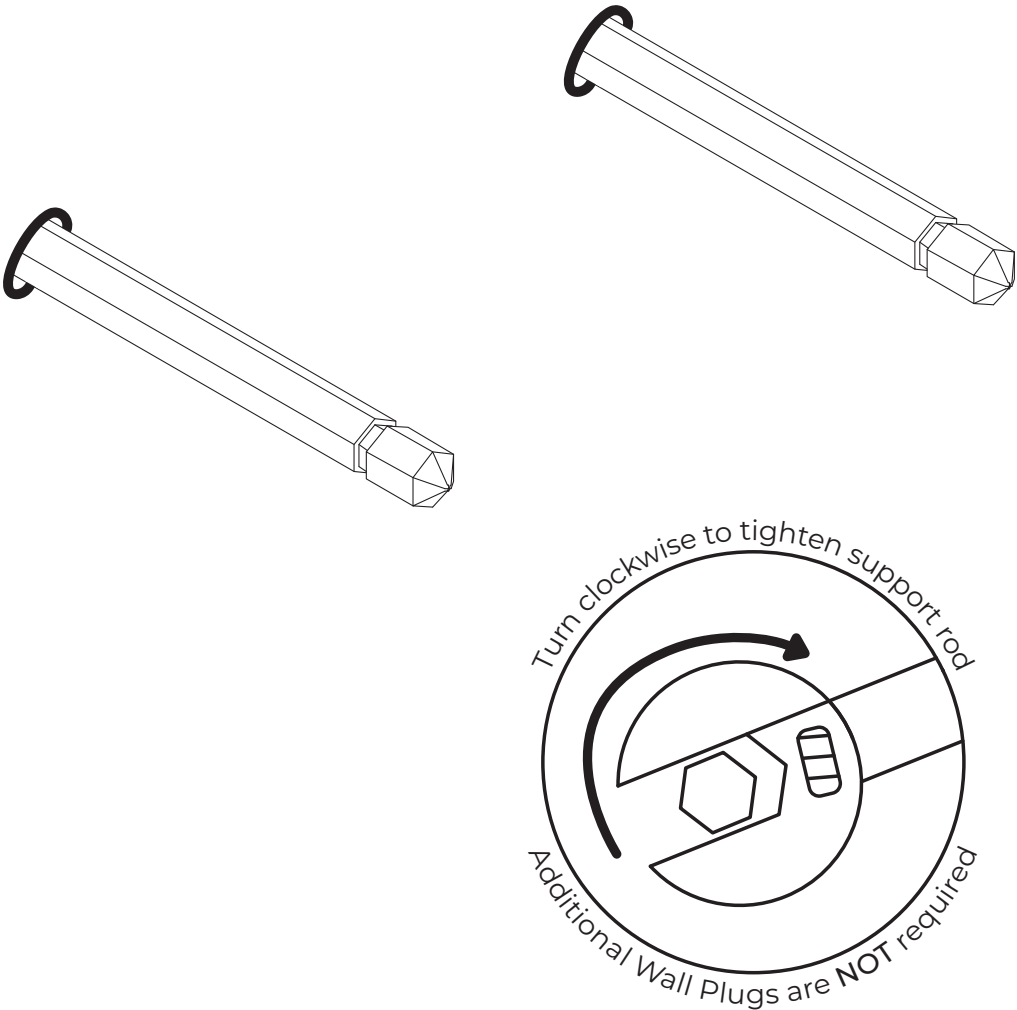

3

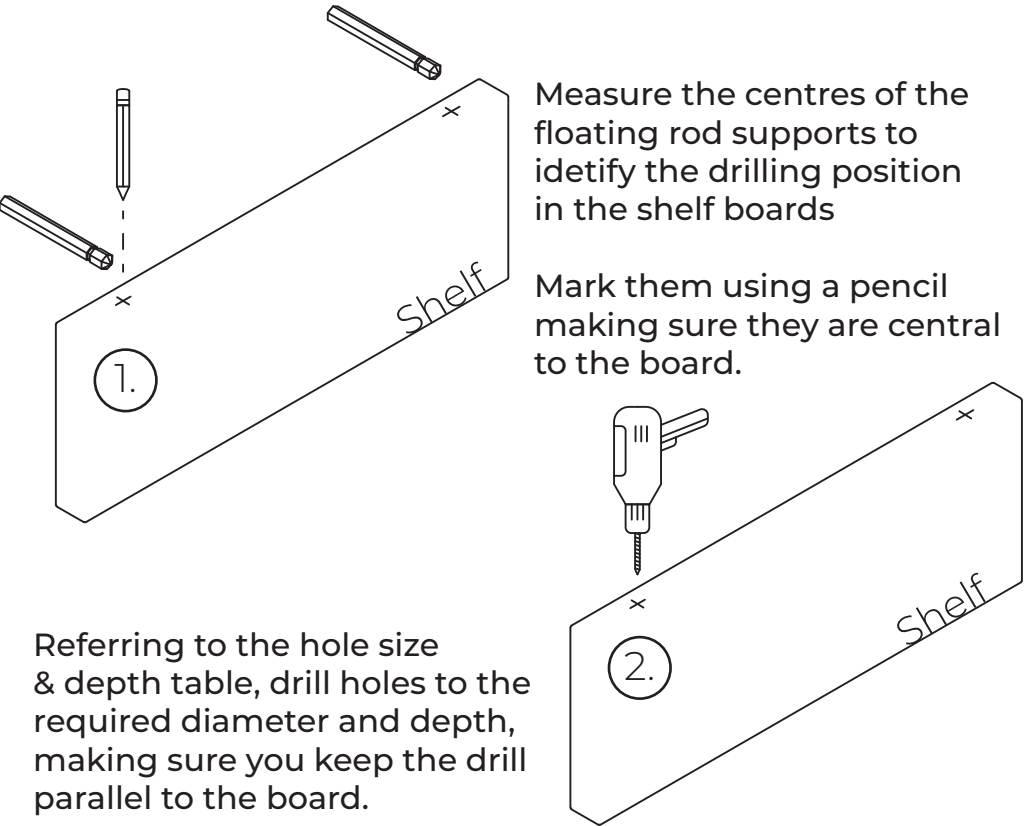

Measure the centres of the floating rod supports to identify the drilling position in the shelf boards

Mark them using a pencil making sure they are central to the board.

Referring to the hole size & depth table, drill holes to the required diameter and depth, making sure you keep the drill parallel to the board.

4

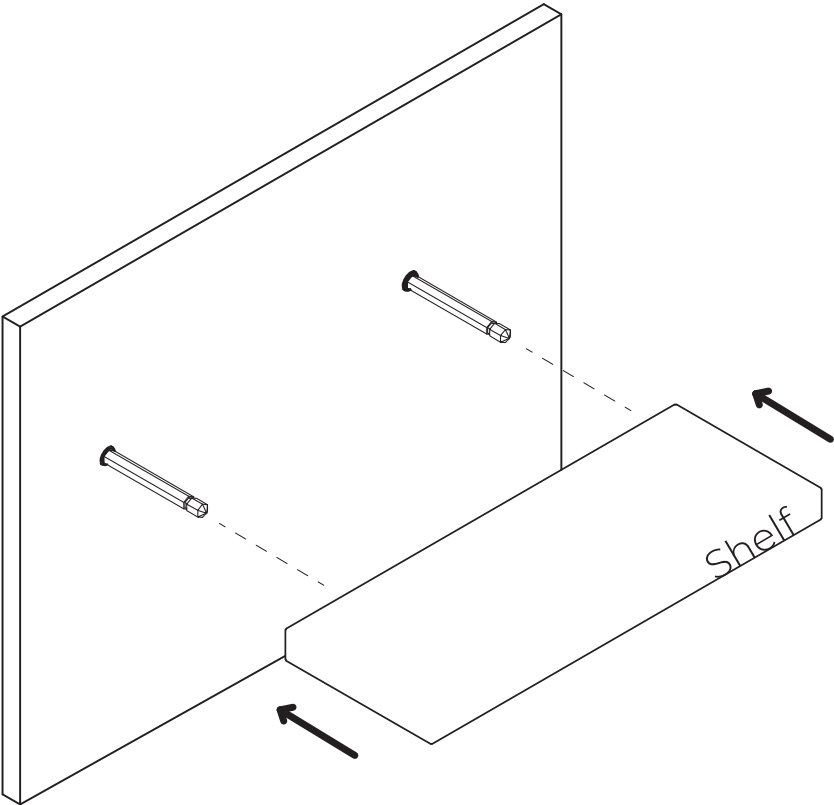

Push the shelf onto the floating shelf support rods until it is flush with the wall (Light force may be required)