

# VOC1218PF

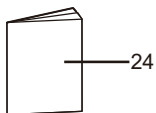

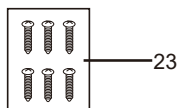

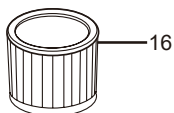

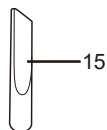
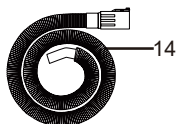
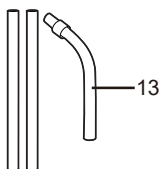
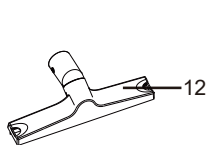
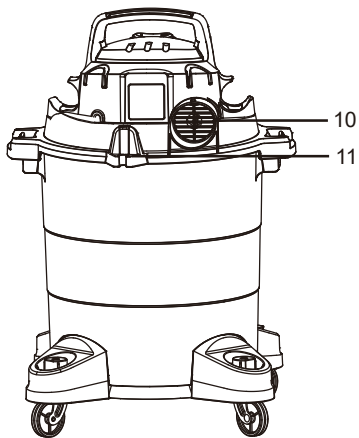
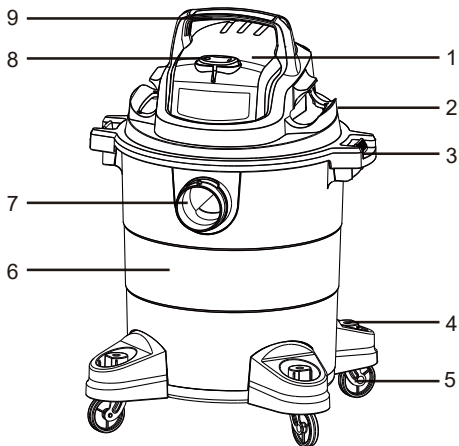

# TABLE OF CONTENTS

SECTION	PAGE
Symbols .....	4
Safety Information .....	5
Unpacking and Checking Carton Contents .....	7
Assembly .....	7
Operation .....	8
Cleaning Artificial Lawns and Outdoor Areas .....	9
Maintenance .....	10
Troubleshooting .....	11
Technical Data .....	12
Recycling and Disposal .....	12

Thank you for purchasing this Vacmaster® artificial grass wet and dry vacuum cleaner. Feel confident that with Vacmaster® you are obtaining a high-quality product that is engineered for optimal performance. This vacuum cleaner is suitable for use with both liquids and dry materials.

**FOR YOUR SAFETY: CAREFULLY READ AND UNDERSTAND ALL INSTRUCTIONS.**

## SYMBOLS

	Caution
	Read instruction manual. Failure to follow the warnings and instructions may result in electric shock, fire and/or serious injury.
	Appliance in which protection against electric shock does not rely on basic insulation only but in which additional safety precautions are provided, such as double insulation or reinforced insulation, there being no provision for protective earthing or reliance upon installation conditions.

## SAFETY INFORMATION

### **READ AND UNDERSTAND ALL INSTRUCTIONS BEFORE USING THIS VACUUM CLEANER.**

When using the equipment, a few safety precautions must be observed to avoid injuries and damage. Please read the complete operating manual with due care. Keep this manual in a safe place so that the information is always available. If you give the equipment to any other person, give them these operating instructions as well. We cannot accept any liability for damage or accidents which arise due to a failure to follow these instructions and the safety information.

- Never leave the appliance switched on unattended, if you leave the work area, switch the appliance off or unplug it from the power supply.
- Do not vacuum or use this Wet and Dry vacuum cleaner near flammable liquids, gases or explosive vapours like gasoline or other fuels, lighter fluids, cleaners, oil-based paints, natural gas, hydrogen, or explosive dusts like coal dust, magnesium dust, grain dust or gun powder. Sparks inside the motor can ignite flammable vapours or dust.
- This vacuum cleaner is not suitable for the vacuuming of asbestos or asbestos dust.
- Do not vacuum anything that is burning or smoking, such as cigarettes, matches, or hot ashes.
- Ensure the hose and connections are always pointed away from the users face, hair, ears and eyes during operation and never direct the nozzle towards persons or animals.
- Clear the working area of any items or precessions that you do not wish to be vacuumed before operation.
- Keep cord away from heated surfaces.
- Do not expose to rain. Store indoors.
- Do not unplug by pulling on the cord. To unplug, grasp the plug, not the cord.
- Do not use with damaged cord, plug or other parts.
- Do not pull or carry by cord, use cord as handle, close a door on cord, or pull cord around sharp edges or corners.
- Do not handle the plug or vacuum cleaner with wet hands.

- To reduce the risk of health hazards from vapours or dusts, do not vacuum toxic materials.
- Frequently check that the float valve positioned underneath the motor is able to move freely.
- Do not use or store near hazardous materials.
- Do not use this vacuum cleaner with a torn filter or without the filter installed.
- Do not allow to be used as a toy. Close attention is necessary when used by or near children.
- To reduce the risk of injury from accidental starting, unplug power cord before changing or cleaning filter.
- Unplug from power supply when not in use and before carrying out maintenance.
- Do not cover the ventilation openings. Do not vacuum with any ventilation openings blocked; keep free of dust, lint, hair or anything that may reduce air flow.
- Keep hair, loose clothing, fingers, all parts of body away from openings and moving parts.
- If the supply cord is damaged, it must be replaced by the manufacturer, a qualified service agent or similarly qualified persons in order to avoid a hazard.
- This appliance can be used by children aged from 8 years and above and persons with reduced physical, sensory or mental capabilities or lack of experience and knowledge if they have been given supervision or instruction concerning use of the appliance in a safe way and understanding the hazards involved.
- Children shall not play with the appliance.
- Cleaning and user maintenance shall not be made by children without supervision.
- For additional protection: It is recommended that this vacuum cleaner can be used in conjunction with residual current device (RCD) with a rated residual current of 30mA or less.
- If foam or liquid escapes from the machine, switch off immediately.
- Check the float valve regularly for moving freely and examine it for signs of damage.

### **When using as blower:**

- Direct air discharge only at work area.
- Do not use Wet/Dry Vacuum as a sprayer.
- Do not direct air at bystanders.
- Keep children away when blowing.
- Wear safety goggles.

# UNPACKING AND CHECKING CARTON CONTENTS

1	Power Head	9	Carry Handle	17	Nylon Pre-filter (pre-installed)
2	Hose Storage	10	Blower Port	18	Artificial Grass Tool
3	Latch	11	Power Cord Storage Hook	19	Hard Floor Tool
4	Accessory Storage	12	Floor Head Holder	20	Brass Moss Removal Brush
5	Caster	13	Extension Wand (x3)	21	Round Brush
6	Container	14	Suction Hose	22	Filter Retainer (pre-installed)
7	Suction Port	15	Crevice Tool	23	Screw (x6)
8	On/Off Switch	16	Washable Wet/Dry Filter (pre-installed)	24	Instruction Manual

## ASSEMBLY

**NOTE:** A Phillips screwdriver is required.



- 1) Remove all the contents from inside of the vacuum cleaner container.
- 2) Attach the carry handle into the slots located on the top of the power head. Secure them with supplied screws (Fig. 1).
- 3) Turn the container upside down and insert the feet with casters into the slots and apply pressure until they click into place. Secure them with supplied screws (Fig. 2).
- 4) Your vacuum cleaner comes ready for both wet and dry vacuum cleaning with the washable cartridge filter and pre-filter pre-installed. If the cartridge filter is not installed, refer to page 8 & 9.
- 5) Secure the power head back on the container, using the latches. Insert the locking the end of the hose into the suction port of the container and lock into place (Fig. 3).
- 6) Choose the desired accessories and/or extension wands and push fit onto the hose nozzle (Fig. 4).

### Floor Nozzle Attachments

- 1) To remove the floor nozzle attachment, release the push clips on either side of the floor head holder. The attachment should drop out from underneath (Fig. 5). Only one floor nozzle should be attached at any given time.
- 2) To insert a new floor nozzle attachment, place one side of the attachment into the bottom of the floor head holder and secure one clip in place. Push the other side up into place and ensure it is securely fitted into the holder (Fig. 6).

### Hard Floor Nozzle:

Attachment is suitable for wet or dry suction on hard floor surfaces. Ensure the squeegee is located towards the back of the floor head holder and brushes towards the front.

### Artificial Grass Tool:

Attachment is specifically designed for use on artificial lawns. Ensure the front lip is facing away from the user and in the direction of vacuuming.

## OPERATION

### 1. Switching On/Off

Connect the mains plug to a suitable a power outlet.

Position	Status
I	on
O	off



### 2. Wet & Dry Vacuum Operation



**WARNING: ENSURE YOU READ, UNDERSTAND AND APPLY SECTION ENTITLED 'SAFETY INFORMATION'.**

- 1) Verify that the washable filter and pre-filter are installed and the container latches are secured.
- 2) Secure the locking end of the hose into the vacuum suction port.
- 3) Push the desired accessories onto the hose nozzle. The air flow regulation allows you to change vacuum cleaner suction. For best cleaning results, fully close the air flow regulation (Fig. 7).
- 4) Plug the power cord into a power outlet.
- 5) Turn on the motor by assigning the switch to the "I" ON position.
- 6) Once you have completed vacuuming, switch to the "O" OFF position and unplug the power cord from the power.

**NOTE:** If vacuuming a mixture of wet and dry surfaces, fully clean and dry the filter and collection tank after each use.

### Installing Cartridge filter:



**WARNING: BEFORE INSTALLING, REMOVING OR CLEANING THE VACUUM CLEANER FILTER, ENSURE THAT THE POWER CORD IS UNPLUGGED AND SWITCHED OFF.**

- 1) To prepare your vacuum cleaner for wet or dry vacuuming, install the cartridge filter over the filter cage ( ① ) with the flat end of the filter towards the vacuum power head. Carefully push filter until it sits flush forming a tight seal (Fig. 8).
- 2) Place the filter retainer cap on top of cartridge filter over the raised lip and tighten the retainer lock clockwise to secure against the internal filter cage (Fig. 9).
- 3) Place the nylon pre-filter over the cartridge filter, making sure the whole filter is covered and secure the drawstring. Replace the power head, and secure it in place (Fig. 10).



**IMPORTANT:** Check the filter regularly for optimal performance. An old or blocked filter will reduce suction performance.

**IMPORTANT!** The vacuum cleaner is equipped with a float valve ( ② ) which is operational during wet suction (Fig. 11). The suction power decreases when the maximum filling level is reached. When this happens, switch the vacuum cleaner off immediately, and empty the container.

### 3. Blower Operation



**WARNING! KEEP BYSTANDERS CLEAR FROM BLOWING DEBRIS.**



**WARNING! WEAR A DUST MASK IF BLOWING CREATES DUST THAT MIGHT BE INHALED.**

- 1) Make sure the container and any collected waste is emptied and the filter is dry before using as a blower.
- 2) Insert the locking end of the hose into the blower port on the rear side of the power head (Fig. 12).
- 3) Turn on the motor on by turning the switch to the 'I' ON position.

## CLEANING ARTIFICIAL LAWNS AND OUTDOOR AREAS

### 1. Everyday Cleaning with Dry Suction

- 1) Clear large objects and debris from the lawn surface to ensure no large objects block or damage the vacuum cleaner (Fig. 13).
- 2) Fit the artificial grass tool attachment to the floor head holder and attach this to the end of the extension wands and hose (Fig. 14).

**NOTE:** The artificial grass tool has been specially developed for cleaning long fibers of artificial lawns.

- 3) Turn the motor on by assigning the switch to the 'I' ON position.

### 2. Remove Stubborn Dirt with Wet Suction

Stubborn dirt or mud that has been compacted into the surface is easier to remove and clean if the lawn is wet.

- 1) Use a hose or watering can directly onto the stubborn dirt allowing the dirt to loosen and absorb the water (Fig. 15).
- 2) Using the artificial grass tool, vacuum up areas to remove the dirt deep in the lawn fibers.

### 3. Brass Round Brush for Moss and Plant Removal

Nature likes to grow back into artificial lawns, moss especially likes the damp protected surface of artificial grass. The brass brush will remove the moss from the lawn, without the use of chemicals, the brass fibers are soft and gentle to surfaces compared to steel brushes.



**WARNING: ALWAYS TEST THE EFFECT OF THE BRASS BRUSH IN A SMALL AREA. CHECK THAT THE BRUSH DOES NOT DAMAGE YOUR TYPE OF ARTIFICIAL LAWN OR YOUR TYPE OF STONE WORK BEFORE CLEANING LARGE AREAS.**

- 1) Fit the brass round brush tool to the end of the extension wands and hose (Fig. 16).
- 2) Work the moss in a gentle back and forth motion. This will dislodge the roots and the moss is collected by the vacuum cleaner.

#### 4. Detailed Areas

For the corners around your lawn use the crevice tool.

- 1) Fit the crevice tool to the end of the extension wands and hose (Fig. 17).
- 2) Use the crevice tool for any final spot cleaning and to reach the edges and corners of the lawn and around any plant pots (Fig. 17).

#### 5. Other Outdoor Areas

Use the hard floor tool for any other outdoor flooring, decking or stonework.

- 1) Fit the hard floor attachment to the floor head holder and attach this to the end of the extension wands and hose (Fig. 18).

## MAINTENANCE



**WARNING: REMOVE THE POWERCORD FROM THE POWER SUPPLY BEFORE CARRYING OUT ANY MAINTENANCE.**

- 1) Keep all safety devices, air vents and the motor housing free of dirt and dust. Use a soft, dry brush to clean the equipment regularly.
- 2) Clear all dirt or debris from the collection tank after each use. Allow to dry before replacing the power head. Do not use cleaning agents or solvents; these may damage the appliance.
- 3) Check the hose, attachments, and power cord to verify that they have not been damaged or any debris is trapped and blocking airflow.

#### 1. Cleaning Washable Cartridge Filter & Nylon Pre-filter

- 1) Remove the filter and clean by gently tapping or brushing dirt off. For optimal performance it is recommended to replace the old filter with a new filter regularly.
- 2) Use a mild soap and water solution to wash cartridge filter and nylon pre-filter and rinse with clean water. Allow the filters to air dry before re-installing (Fig. 19 & 20).

# TROUBLESHOOTING

 **WARNING: TO REDUCE THE RISK OF ELECTRIC SHOCK, UNPLUG BEFORE TROUBLESHOOTING.**

## Cleaning Performance

Vacmaster vacuum cleaners are tested for endurance. If your motor is operating, then the most likely cause for a loss in suction is a blockage or an opening in the vacuum.

To maintain a high cleaning performance from your machine, it is important to replace or clean cartridge filters as necessary. Replace full dust bags to prevent performance drops. A performance drop with clean filters can only be caused by a blockage in the tools or the hose.

PROBLEM	POSSIBLE CAUSE	SOLUTION
The vacuum doesn't work.	No power.	Check the power supply and fuse.
	Functional fault in the power cord, switch, or motor.	Have the damaged part checked by qualified personnel or contact the after sales helpline.
Low suction power and high operating noise / vibrations.	Suction nozzle, hose, or tank inlet is blocked.	Check the suction nozzle, hose, and tank inlet for obstructions.
	Cartridge filter is blocked.	Remove the cartridge filter and clean.
	Float valve has closed.	Empty the container of any liquid waste and ensure the float valve located underneath the filter is able to move freely.
The vacuum turns off on its own.	The power cord is disconnected from the power supply.	Make sure the plug is connected to the power supply.
Dust is escaping from the motor cover.	The filter is missing or damaged.	Install the filter correctly or replace it if it is damaged.

## TECHNICAL DATA

Model Number	VOC1218PF
Motor	220-240V~50Hz
Power Input	1250W
Tank Volume	18L
Net Weight	5.38kg

## RECYCLING AND DISPOSAL



This marking indicates that this product should not be disposed with other household wastes throughout the EU. The machine must be delivered in rigid packaging to avoid damage during transportation. The packaging and the machine itself are manufactured from recyclable materials and should be disposed of accordingly.



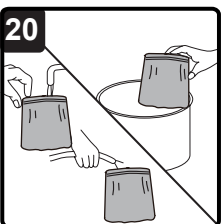
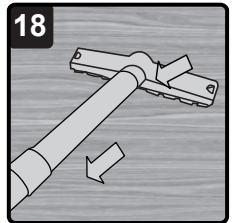
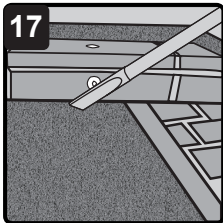
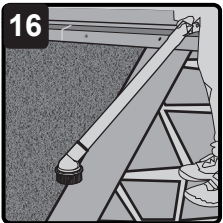
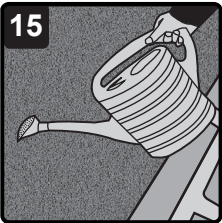
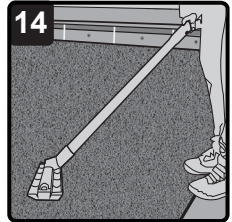
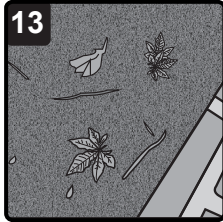
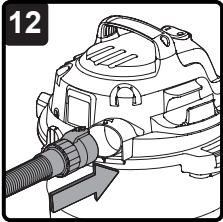
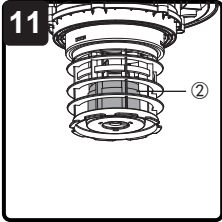
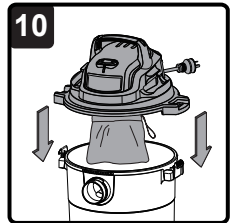
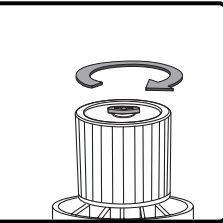
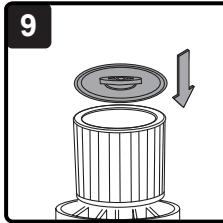
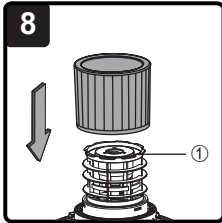
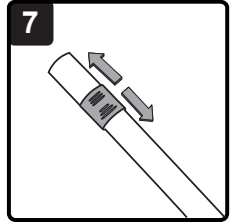
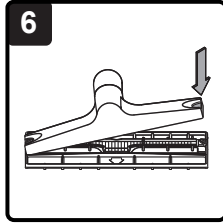
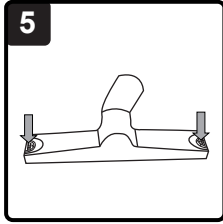
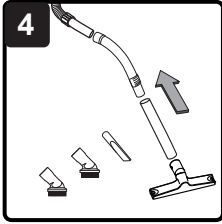
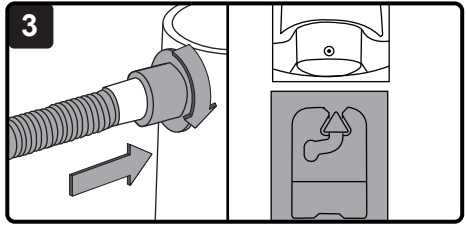
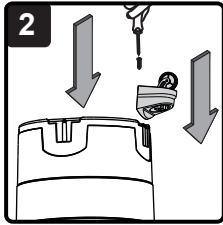
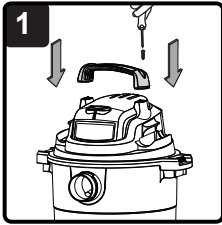





**VOC1218PF**

**Suzhou Cleva Electric Appliance Co., Ltd.**

**No.8 Ting Rong Street**

**Suzhou Industrial Park, Suzhou**

**Jiangsu Province, China**

**[www.cleva-europe.com](http://www.cleva-europe.com)**

**Made in P.R.C**