

**INSTALLATION  
INSTRUCTIONS**

**Product Code:**  
SE15990N0

**IMPORTANT:** Please read these instructions before commencing installation and retain for future reference.

**Components**

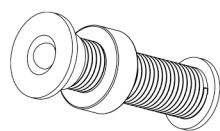

Iris Plinth Light/Lights

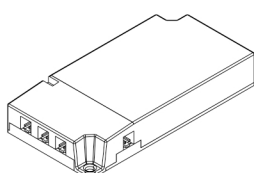

LED Driver  
Only provided with kits

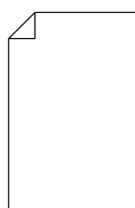

1 x Instructions  
Manual

**Tools Required**



Pencil



Ø10 mm  
Drill Bit



Power Drill

**Important Safety Information**

Please read these instructions carefully before attempting to install this product. It is advisable to keep these instructions in a safe place for future reference.

We recommend that you consult a qualified electrician. All electrical installation must be carried out in accordance with current IEE wiring regulations (BS7671).

These products must not be modified, if any modification are made, it may invalidate the warranty and may render the product unsafe. These LED lights operate low voltage (24V).

Do not wire the individual LED light fittings directly to the mains. This product is for indoor use only. Keep out of moisture and use only in dry rooms.

- If in doubt, installation must be carried out by a qualified electrician.
- Install on smooth flat surface(s) only.
- Do not exceed or stretch the cable length of each LED wire.
- This product is IP44 Rated.
- The wattage for each light is 0.32W. Ensure that the LED driver used with these fittings has an adequate max wattage.

**Safety Instructions**

1. Before commencing installation or maintenance, isolate the main electrical supply for the appropriate circuit at the fuse board.
2. This product is only suitable for connecting to a 24V Sensio Driver.
3. The lights should be mounted onto a secure surface.
4. Never exceed the total output of the LED driver.
5. Suitable for furniture lighting.
6. When the lamp expires the fitting must be replaced
7. Class III safety extra low voltage (SELV).

**Waste Electrical & Electronic Equipment (WEEE)**

The symbol on the product, or on the document accompanying the product, the crossed out wheellie bin symbol, indicates that this product may not be treated as household waste. Instead it shall be handed over to the applicable collection point for the recycling of electrical and electronic waste.



Sensio House, Unit 7, Speedwell Road, Whitwood, Castleford, West Yorkshire, WF10 5PY

[www.sensio.co.uk](http://www.sensio.co.uk)

Technical drawings for illustration purposes only, Sensio has the right to change any information without prior notice.

## Installation

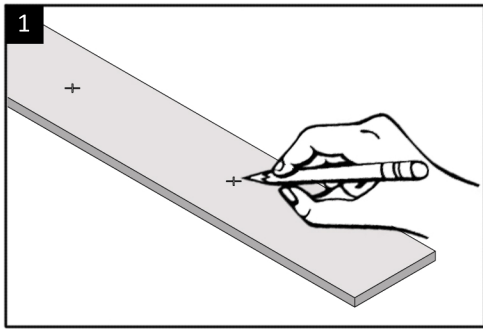

Carefully mark the desired locations for your plinth light/lights.

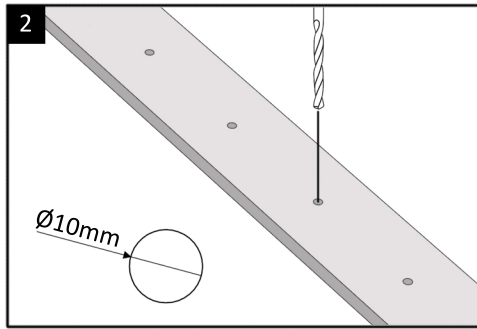

Proceed to drill the holes using a 10mm diameter drill bit.

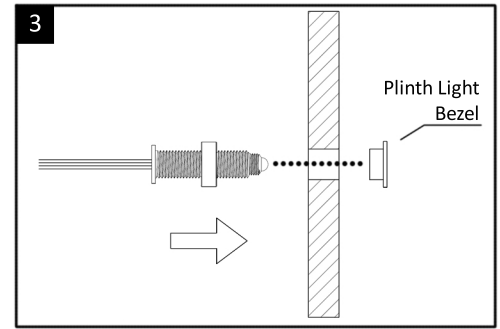

Unscrew the bezel and insert the plinth light/lights into the hole on the back of the plinth board. Proceed to screw the bezel back onto the plinth light/lights.

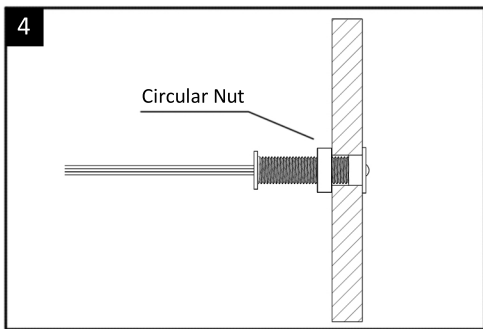

Tighten the circular nut until the plinth light/lights are held securely within the hole.

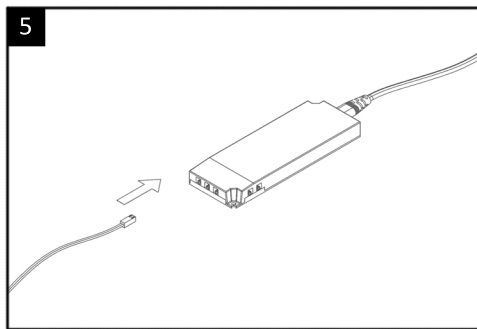

Connect the plinth light cable to the JB4 driver distribution block.  
**Note:** This should be the first or last plinth light in a run depending on the driver location.

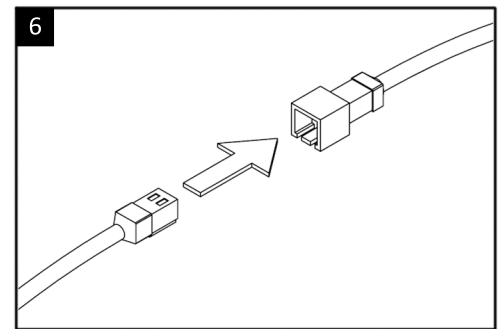

Proceed to connect each plinth light together by inserting the male JB4 connector into the female connector, in a daisy chain fashion.

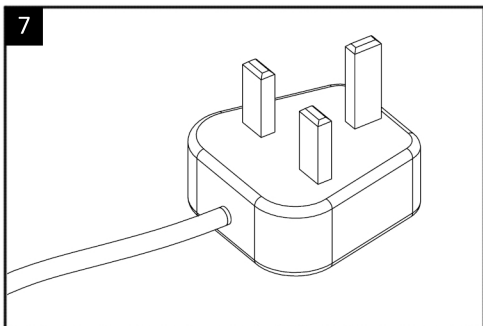

Connect the driver to the mains supply, or attach a plug.

## Maintenance & Care

- Ensure that the power is disconnected prior to cleaning.
- To keep the finish of this product, wipe over with soft cloth periodically.
- Do not use harsh chemical solvents, this may dis-colour or damage the finish.