

# NoMorePly®

## 6mm PrePrimed Tile Backing Board

The first fast-fit system with a lifetime guarantee

**FASTER  
FIT**



**THIN  
PROFILE**



**STRONGER  
BUILD**



**WATER  
RESISTANT**



**A1  
FIRE RATED**



**LIFETIME  
GUARANTEE**



FASTER  
FITTHIN  
PROFILESTRONGER  
BUILDWATER  
RESISTANTA1  
FIRE RATEDLIFETIME  
GUARANTEE

'It's best practice to prime surfaces before applying adhesive and tiles. It's the professional standard'

**Craig Sellers**  
Professional tiler since 1987



## Why professionals choose NoMorePly

6mm Pre**Primed NoMorePly** strengthens timber floors before tiling. They prevent tiles and grout lines cracking by removing the 'flex' in timber floors caused by footfall. Slim 6mm boards provide the same rigidity as 15mm plywood and so reduce the 'step' into the tiled area.

6mm Pre**Primed NoMorePly** is also water resistant, unlike plywood which weakens when damp. Plus, it's also A1 fire rated for your peace of mind.

Using Mega Strength polyurethane adhesive to fix boards makes installation quick and now being already primed, **NoMorePly** boards are the fastest to fit in the market.

	NoMorePly	Plywood	Other Fibre Cement Boards
Slim strong boards	✓		✓
Water resistant	✓		✓
A1 fire rated	✓		✓
Fix using quick drying polyurethane adhesive	✓		
PrePrimed for the fastest fit	✓		
Reduced dust	✓	✓	
Lifetime guarantee	✓		

Follow the guidance in this leaflet to learn best practice on installing the **NoMorePly** system

For sales or advice on installation  
Call: 0800 0094 354  
or Visit: [sts-uk.com/nomoreply](https://sts-uk.com/nomoreply)



**6mm PrePrimed NoMorePly**  
to strengthen timber floors

**12mm STS Construction Board**  
to create strong partition walls

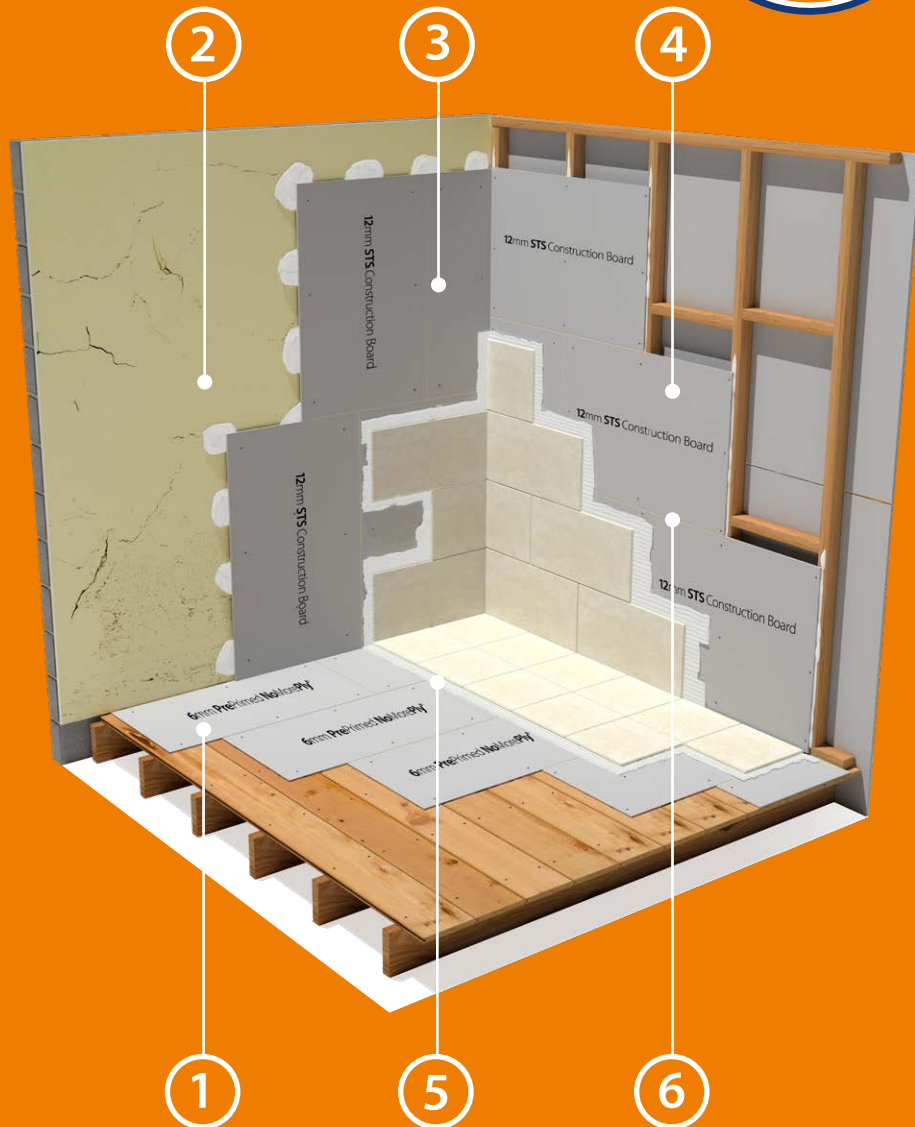

## The System

- 1 Use 6mm PrePrimed NoMorePly fixed with MEGA Strength and screws when over boarding timber floors. Use 6mm fixed with flexible rapid-set tile adhesive onto concrete floors
- 2 Prime solid walls with SBR (1 part SBR to 3 parts water) before boarding
- 3 Use 12mm STS Construction Board on solid walls - prime the boards on both sides then 'dot and dab' with tile adhesive. Secure with mechanical fixings
- 4 Use 12mm STS Construction Board fixed with MEGA Strength and screws for boarding wood or metal stud walls
- 5 Always use a good quality single part flexible adhesive for fixing tiles
- 6 Always use MEGA Strength on all joints for extra strength and complete waterproofing

## The Essentials

### Fibre cement boards

**6mm PrePrimed NoMorePly** (1200 x 600mm)  
**12mm STS Construction Board** (1200 x 800mm)

### Scoring tool

Use for scoring, before easily 'snapping' the boards

### PCD saw blade

Use with 12mm boards to speed up the cutting process on big jobs

### MEGA Strength adhesive

Fast setting polyurethane adhesive delivers an exceptionally strong and waterproof seal. Using MEGA, you're ready to tile in 10 minutes

### SBR Primer (1 litre)

Use to seal and improve the bond with tile adhesive on 12mm STS Construction Boards and to prime walls before boarding

### Torx Screws (25mm and 38mm)

Self drilling and self counter sinking, so there's no need to pilot drill and screw heads don't protrude from the boards



For sales or advice on installation

Call: 0800 0094 354 or Visit: [sts-uk.com/nomoreply](https://sts-uk.com/nomoreply)

**NoMorePly**

# Over Boarding Timber Floors

## 6mm PrePrimed NoMorePly



### Step 1

Remove any old existing floor coverings, screw down floorboards firmly (timber or chipboard) and sweep clean.

You are now ready for **NoMorePly**.



### Step 2

6mm PrePrimed NoMorePly boards have reduced dust making handling easier and cleaner.

Run two beads of Mega Strength adhesive around the back of the board..

**Always wear gloves!**



For sales or advice on installation

Call: 0800 0094 354 or Visit: [sts-uk.com/nomoreply](https://sts-uk.com/nomoreply)

**Cutting Boards** NoMorePly Boards can be easily cut by scoring one side with a scoring knife, then snapping over a block. For curves and shapes use tile nippers.



### Step 3

Screw down firmly using 8 x 25mm NoMorePly screws. Ideally, position the screws 25mm from the edge of the boards.

Apply a small bead of Mega Strength to the edge of each board to seal and reinforce the joints. Stagger the joints where possible.



### Step 4

Wipe off excess adhesive using a cloth and use solvent in case of spillage.

**Now you're ready to tile!**

### Helpful Facts

50 screws are enough for 6 boards

200 screws are enough for 25 boards

## Over Boarding Solid Floors

### 6mm PrePrimed NoMorePly



#### Step 1

6mm **NoMorePly** is ideal for covering dirty, cracked, worn out concrete floors. Always start by removing loose material, then prime the floor with one coat of **NoMorePly** Tiler's Primer (mixed 1 part primer to 3 parts water).

Mark or chalk a straight line on the floor.



#### Step 2

For best results, lay **NoMorePly** on single part flexible rapid set adhesive. This can straddle both solid and timber flooring surfaces.

Stagger the boards where possible.

**Cutting Boards** **NoMorePly** Boards can be easily cut by scoring one side with a scoring knife, then snapping over a block. For curves and shapes use tile nippers.



#### Step 3

Apply a small bead of MEGA Strength onto the edges of each board to achieve a waterproof seal.

Wipe off excess adhesive using a cloth and use solvent in case of spillage.



#### Step 4

When boards have straddled both solid and timber flooring, use screws to secure into any timber floorboards.

**Now you're ready to tile!**

# Over Boarding Stud Walls 12mm STS Construction Board



## Step 1

Use 12mm STS Construction Boards on stud walls and approach metal stud work in exactly the same way as you would timber.

Run a bead of MEGA Strength on all vertical and horizontal joints before fixing the board.

This helps combat movement that may occur due to timber shrinkage.



## Step 2

Screw the 12mm STS Construction Boards to the stud work using approximately 9 x 38mm screws per board.



## Step 3

Run a bead of Mega Strength around the edge of each board before offering up the next board. This reinforces and waterproofs the joint eliminating the need to tape the joints.

Stagger the boards where possible.

Wipe off excess adhesive using a cloth and use solvent in case of spillage.

**PRO TIP - Studs to be max 600mm centres with cross noggins on board joints**



## Step 4

Finish by priming the boards using SBR (mixed 1 part SBR to 3 parts water). This will improve tile adhesion and fully waterproof the NoMorePly boards.

**Now you're ready to tile!**

**Cutting Boards 12mm STS Construction Boards** can be easily cut by scoring one side with a scoring knife, then snapping over a block. Use a PCD Saw Blade to speed up the cutting process on big jobs.

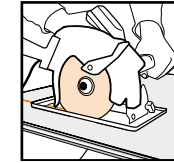

**STS**

# Over Boarding Solid Walls

## 12mm STS Construction Board



### Step 1

Use 12mm STS Construction Boards for covering solid walls.  
Always start by priming the wall with one coat of SBR ( mixed 1 part SBR to 3 parts water ).  
Boards must also be primed both sides using SBR mixed in the same way.



### Step 2

For best results, simply 'dot and dab' using a single part flexible tile adhesive. The dab depth should be a maximum of 25mm. 5kg of cement powder adhesive should be used per board and this will equate to approximately 30 dabs.  
Apply the boards directly to the wall keeping them level, plumb and flat.

**Cutting Boards 12mm STS Construction Boards** can be easily cut by scoring one side with a scoring knife, then snapping over a block. Use a PCD Saw Blade to speed up the cutting process on big jobs.

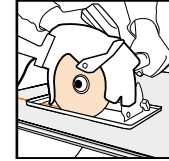

### Step 3

Secure with a minimum of 4 mechanical fixings. Simply drill the boards, plug and screw fixings.  
Apply a small bead of MEGA Strength onto the edges of each board to achieve a waterproof seal.

**PRO TIP - MEGA Strength adhesive will achieve a waterproof seal, so there's no need for tape**



### Step 4

Wipe off excess adhesive using a cloth and use solvent in case of spillage.  
Stagger the boards where possible, using a straight edge to keep the boards plumb.

**Now you're ready to tile!**

**STS**

## Boarding Wetrooms



### Step 1

Place boards into position around the tray to check fit.

Run two beads of MEGA Strength adhesive onto the back of **NoMorePly**.



### Step 2

Apply a bead of MEGA Strength around the tray before placing the first boards into position.

Apply a bead of MEGA Strength around the edges of each board to achieve a waterproof seal.

Stagger the boards where possible.

Secure each board with 8 x 25mm screws and continue laying boards as described on page 6.

For sales or advice on installation  
Call: 0800 0094 354 or Visit: [sts-uk.com/nomoreply](https://www.sts-uk.com/nomoreply)

**NoMorePly**®

**Cutting Boards** NoMorePly boards can be easily cut by scoring one side with a scoring knife, then snapping over a block. For curves and shapes use tile nippers.



### Step 3

Tape between the shower tray and the **NoMorePly** board to complete the fix.

Tape is included in the STS Tanking Kit, which is a complete waterproofing system and essential when installing a wetroom.



### Kaskade Wetrooms

**NoMorePly** 6mm boards work in conjunction with Kaskade, the ultra slim walk-in shower tray, for a true 'no step' wetroom effect.

Kaskade trays come in a choice of three sizes to suit most requirements and all include a trap.

These trays provide an ideal surface to tile directly onto.

**For full fitting instructions, please visit: [sts-uk.com](https://www.sts-uk.com)**

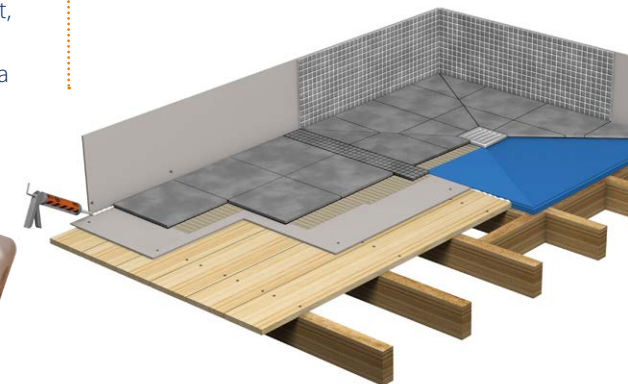



# 6mm PrePrimed NoMorePly Guarantee and guidance

## Lifetime Guarantee Terms

The **NoMorePly** board lifetime guarantee only applies when the correct installation procedures, as set out in our Installation Guide, have been followed and the recommended **NoMorePly** system essentials used during installation.

### LIFETIME GUARANTEE



## For guidance only

As conditions of use and any labour involved are beyond our control, the end user must satisfy himself by prior testing that the product is suitable for his specific application. No responsibility can be accepted or any warranty given by our representatives, agents or distributors.



## Tested and Approved

6mm PrePrimed **NoMorePly** 6mm boards with CE approval and low in emissions.



## Helpful Facts

**50 screws** are enough for **6 boards**

**200 screws** are enough for **25 boards**

**NoMorePly** holds the heaviest tiles. **100kg per m<sup>2</sup>** is no problem when fitted correctly

**6mm boards** are 1200mm x 600mm = **0.72m<sup>2</sup>**

**12mm boards** are 1200mm x 800mm = **0.96m<sup>2</sup>**

**1 tube of Mega Strength** for every **5 boards**

**1 litre of NoMorePly Tiler's Primer** - diluted 3:1 with water = **40m<sup>2</sup>**

For sales or advice on installation

Call: **0800 0094 354** or Visit: [sts-uk.com/nomoreply](https://sts-uk.com/nomoreply)

Lines open: Monday-Friday **7am-5pm**

**STS**