

Pioneering for You

wilo

Wilo-Yonos PICO



en Installation and operating instructions

Fig. 1:

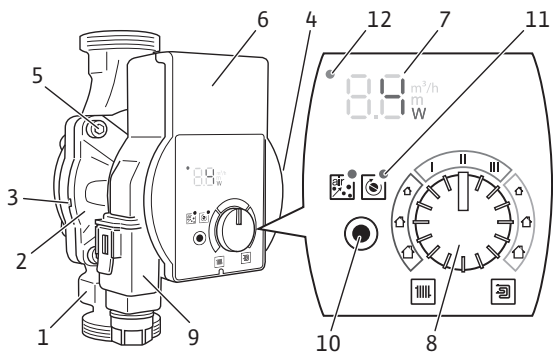

Fig. 2:

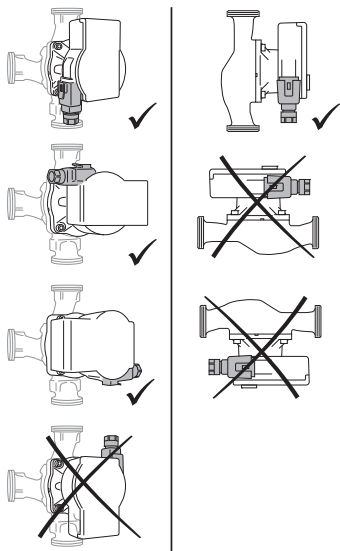

Fig. 3a:

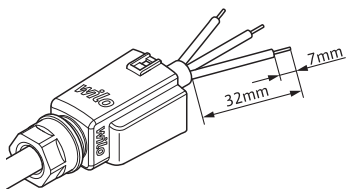

Fig. 3b:

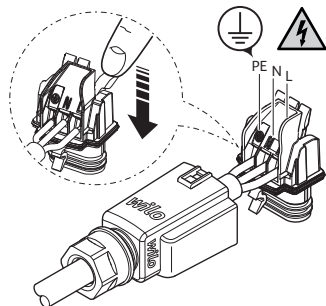

Fig. 3c:

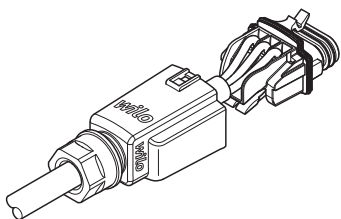

Fig. 3f:

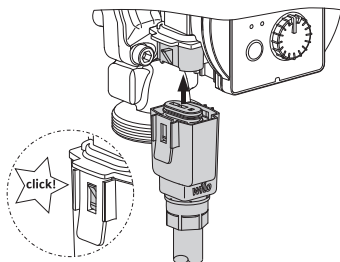

Fig. 3d:

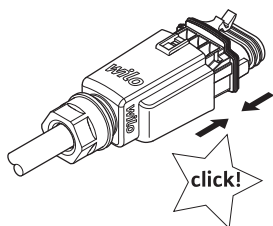

Fig. 4:

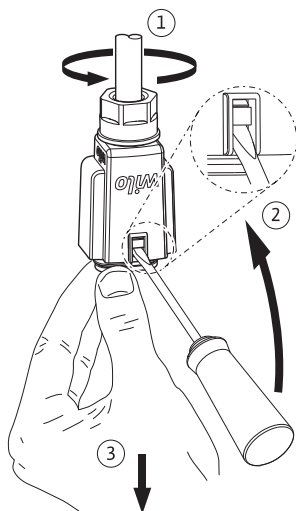
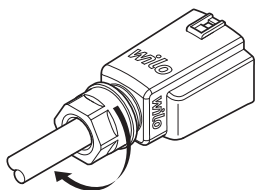

Fig. 3e:



1 General information

About these instructions

These installation and operating instructions are an integral part of the product. Read these instructions before commencing work and keep them in an accessible place at all times.

Strict adherence to these instructions is a precondition for the intended use and correct operation of the product. All information and markings on the product must be observed.

The language of the original operating instructions is German. All other languages of these instructions are translations of the original operating instructions.

2 Safety

This chapter contains basic information which must be adhered to during installation, operation and maintenance. Additionally, the instructions and safety instructions in the other chapters must be observed.

Failure to follow the installation and operating instructions will result in risk of injury to persons and damage to the environment and the product. This will result in the loss of any claims for damages.

Failure to follow the instructions will, for example, result in the following risks:

- Danger to persons due to electrical, mechanical and bacteriological factors as well as electromagnetic fields
- Environmental risks due to leakage of hazardous substances
- Property damage
- Failure of important functions of the product

Identification of safety instructions

These installation and operating instructions set out safety instructions for preventing personal injury and damage to property that are displayed in different ways:

- Safety instructions relating to personal injury start with a signal word and are **preceded by a corresponding symbol**.

- Safety instructions relating to property damage start with a signal word and are displayed **without** a symbol.

Signal words **DANGER!**

Failure to observe the safety instructions will result in serious injuries or death!

WARNING!

Failure to follow the instructions can lead to (serious) injuries!

CAUTION!

Failure to follow the instructions can lead to property damage and a possible total loss.

NOTE

Useful information on handling the product.

Symbols These instructions use the following symbols:



Danger due to electrical voltage



General danger symbol



Warning of hot surfaces/media



Warning of magnetic fields



Notes

Personnel qualifications Personnel must:

- Be instructed in the locally applicable accident prevention regulations.
- Have read and understood the installation and operating instructions.

Personnel must have the following qualifications:

- Electrical work must be carried out by an authorised electrician (in accordance with EN 50110-1).

- Installation/dismantling must be carried out by a qualified technician who is trained in the use of the necessary tools and mounting materials.
- The product must be operated by persons who are instructed in the functioning of the complete system.

Definition of “qualified electrician”

A qualified electrician is a person with appropriate technical education, knowledge and experience who can identify and prevent electrical hazards.

Electrical work

- Electrical work must be performed by a qualified electrician.
- Nationally applicable guidelines, standards and regulations as well as specifications by local energy supply companies for connection to the local power supply system must be observed.
- Before commencing work, disconnect the product from the mains and secure it against being switched on again.
- The connection must be protected by means of a residual-current device (RCD).
- The product must be earthed.
- Have defective cables replaced immediately by a qualified electrician.
- Never open the control module and never remove control elements.

Obligations of the operator

- Have all work carried out by qualified personnel only.
 - Ensure on-site contact protection from hot components and electrical hazards.
 - Have defective gaskets and connecting cables replaced.
- This device can be used by children from 8 years old as well as persons with limited physical, sensory or mental capabilities or lack of experience and knowledge, if they are supervised or instructed in the safe use of the device and they understand the dangers that may arise. Children are not allowed to play with the device. Cleaning and user maintenance may not be carried out by children without supervision.

3 Product description and function

- Overview** Wilo-Yonos PICO (Fig. 1)
- 1 Pump housing with screwed connections
 - 2 Glandless pump motor
 - 3 Condensate drain openings
(4x around circumference)
 - 4 Rating plate
 - 5 Housing screws
 - 6 Control module
 - 7 LED display
 - 8 Operating button
 - 9 Wilo-Connector, electrical mains connection
 - 10 Function key
 - 11 Function LED
 - 12 Fault signal LED

Function High-efficiency circulator for hot-water heating systems with integrated differential pressure control. Control mode and delivery head (differential pressure) are adjustable. The differential pressure is controlled via the pump speed.

Type key

Example: Wilo-Yonos PICO 25/1-6 130

| | |
|------------|---|
| Yonos PICO | High-efficiency circulator |
| 25 | Screwed connection DN 25 (Rp 1) |
| 1-6 | 1 = Minimum delivery head in m (adjustable down to 0.5 m) 6 = Maximum delivery head in m at $Q = 0 \text{ m}^3/\text{h}$ |
| 130 | Port-to-port length: 130 mm or 180 mm |

Technical data

| | |
|---|----------------------------------|
| Connection voltage | 1 ~ 230 V \pm 10 %, 50/60 Hz |
| Protection class IP | See rating plate (4) |
| Energy efficiency index EEI | See rating plate (4) |
| Fluid temperatures at max. ambient temperature +40 °C | -10 °C to +95 °C |
| Fluid temperatures at max. ambient temperature +25 °C | -10 °C to +110 °C |
| Permitted ambient temperature | -10 °C to +40 °C |
| Max. operating pressure | 10 bar (1000 kPa) |
| Min. inlet pressure at +95 °C/+110 °C | 0.3 bar/1.0 bar (30 kPa/100 kPa) |

LED display



- Display of the setpoint H of the delivery head (differential pressure) in m .



- Display of selected constant speed (c1 = I, c2 = II, c3 = III).

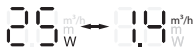

- Display of the current power consumption in W , alternating with the current flow rate in m^3/h .

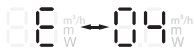

- Display of warning and fault signals.

3.1 Controls

Operating button

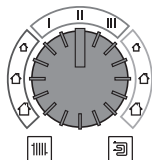

Turn

- Select application/control mode.
- Set setpoint H of the delivery head (differential pressure).
- Select constant rotation speed.

Function key Press

- Start pump venting function.
- activate pump manual restart.



3.2 Applications/control mode and functions

Radiator heating system

Recommended for two-pipe heating systems with radiators to reduce the flow noises at the thermostatic valves.

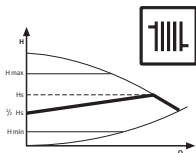

Variable differential pressure ($\Delta p-v$):

The pump reduces the delivery head at a decreasing volume flow in the pipe network to half.

Electrical energy saving by adjusting the delivery head to the volume flow requirement and lower flow rates.



NOTE

Factory setting: $\Delta p-v, \frac{1}{2} H_{\max}$

Underfloor heating

Recommended for underfloor heating.

Or for large-sized pipes as well as all applications without changeable pipe network curve (e.g. storage charge pumps) as well as single-pipe heating systems with radiators.

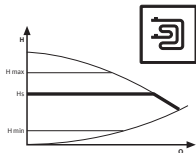

Constant differential pressure ($\Delta p-c$):

The controller keeps the set delivery head constant irrespective of the conveyed volume flow.

Constant speed

Recommended for systems with fixed system resistance requiring a constant volume flow.

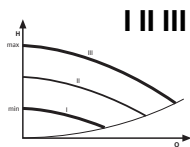

Constant speed (I, II, III):

The pump runs uncontrolled in three prescribed fixed speed stages.

Venting



The **pump venting function** is activated via the function key and vents the pump automatically. The heating system is not vented.

Manual restart



A **manual restart** is activated via the function key and deblocks the pump as required (e.g. after a prolonged standstill during the summer).

4 Intended use

The high-efficiency circulators in the Wilo-Yonos PICO series are exclusively designed for circulating fluids in hot-water heating systems and similar systems with constantly changing volume flows.

Permitted fluids:

- Heating water according to VDI 2035 (CH: SWKI BT 102-01).
- Water-glycol mixtures* with a maximum of 50 % glycol.

* Glycol has a higher viscosity than water. If glycol is added, the delivery data of the pump must be corrected to suit the mixing ratio.



NOTE

Only add ready-to-use mixtures to the system. Do not use the pump to mix the fluid in the system.

Intended use includes observing these instructions and the data and markings on the pump.

Misuse Any use beyond the intended use is considered misuse and will result in the loss of all liability claims.



WARNING!

Danger of injury or material damage due to improper use!

- Never use non-specified fluids.
- Never allow unauthorised persons to perform work.
- Never operate the pump outside of the specified limits of use.
- Never carry out unauthorised conversions.
- Use authorised accessories only.
- Never operate with phase angle control.

5 Transportation and storage

Scope of delivery

- High-efficiency circulator with 2 gaskets
- Wilo-Connector
- Installation and operating instructions

Transport inspection Inspect for transportation damage and check completeness immediately after delivery, and claim immediately if necessary.

Transport and storage conditions Protect from moisture, frost and mechanical loads. Permissible temperature range: -10 °C to +50 °C.

6 Installation and electrical connection

6.1 Installation

May only be installed by qualified technicians.



WARNING!

Risk of burns due to hot surfaces!

Pump housing (1) and glandless pump motor (2) may become hot and result in burns on contact.

- During operation, touch the control module (6) only.
- Allow the pump to cool down before commencing any work.



WARNING!

Risk of burns due to hot fluids!

Hot fluids can result in scalding. Before installing or removing the pump, or undoing the housing screws (5), note the following:

- Allow the heating system to cool down completely.
- Close shut-off devices or drain the heating system.

Preparation

- Choose an installation point that is as easily accessible as possible.
- Observe the pump's allowable installation position (Fig. 2), rotate the motor head (2 + 6) if necessary.

CAUTION!

An incorrect installation position may damage the pump.

- Select the installation point in line with the allowable installation position (Fig. 2).
 - The motor must always be installed horizontally.
 - The electrical connection must never face upwards.
-

- Install shut-off devices upstream and downstream of the pump to facilitate pump replacement.

CAUTION!

Leaking water may damage the control module.

- Align the upper shut-off device such that leaking water cannot drip onto the control module (6).

- Align the upper shut-off device laterally.
- When installing in the feed of open systems, the safety supply must branch off upstream of the pump (EN 12828).
- Complete all welding and brazing tasks.
- Flush the pipe system.

Rotating the motor head

Rotate the motor head (2 + 6) before installing and connecting the pump.

- If necessary, remove the thermal insulation shell.



WARNING!

Risk of fatal injury from magnetic field!

Risk of death for people with medical implants due to permanent magnets installed in the pump.

- Never remove the rotor.

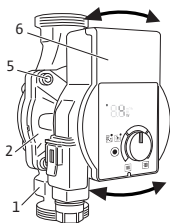

- Hold the motor head (2 + 6) and unscrew the 4 housing screws (5).

CAUTION!

Damage to the inner gasket leads to leakages.

- Carefully rotate the motor head (2 + 6) without removing it from the pump housing (1).
- Carefully rotate the motor head (2 + 6).
- Observe the allowable installation position (Fig. 2) and the direction arrow on the pump housing (1).
- Tighten the 4 housing screws (5) (4-7.5 Nm).

Installing the pump

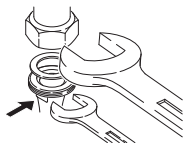
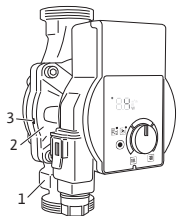

Observe the following points when installing the pump:

- Note the direction arrow on the pump housing (1).
- Install without tension, with glandless pump motor horizontal (2).
- Place gaskets in the screwed connections.
- Screw on threaded pipe unions.
- Secure the pump with an open-end wrench against twisting and screw tightly with the piping
- Re-mount the thermal insulation shell, if applicable.

CAUTION!

Insufficient heat dissipation and condensation water may damage the control module and the glandless pump motor.

- Do not thermally insulate the glandless pump motor (2).
- Ensure all condensate drain openings (3) are kept free.

6.2 Electrical connection

The electrical connection may only be performed by a qualified electrician.



DANGER!

Danger to life due to electrical voltage!

Immediate danger to life if live components are touched.

- Before commencing work, switch off the power supply and secure it against being switched on again.
- Never open the control module (6) and never remove control elements.

CAUTION!

Pulsed mains voltage can lead to damage to electronic components.

- Never operate the pump with phase angle control.
 - When switching the pump on or off using an external control unit, deactivate any voltage pulsing (e.g. phase angle control).
 - For applications where it is not clear whether the pump is operated with pulsed voltage, get the control/system manufacturer to confirm that the pump is operated with sinusoidal AC voltage.
 - Switching the pump on/off via triacs/solid-state relays must be examined on a case-by-case basis.
-

Preparation

- The current type and voltage must agree with the specifications on the rating plate (4).
 - Maximum back-up fuse: 10 A, slow-blow.
 - Only operate the pump with sinusoidal AC voltage.
 - Note switching frequency:
 - On/off switching operations via mains voltage $\leq 100/24$ h.
 - $\leq 20/h$ for a switching frequency of 1 min. between switching on/off via mains voltage.
-

**NOTE**

The inrush current of the pump is $< 5A$. If the pump is switched „On“ and „OFF“ via a relay, it must be sure that the relay is designed to switch an inrush current of minimum 5A. If necessary, the boiler-/regulation manufacturer need to give a statement.

- The electrical connection must be made via a fixed connecting cable equipped with a connector device or an all-pole switch with a contact opening width of at least 3 mm (VDE 0700/Part 1).
- Use a connecting cable with a sufficient outer diameter (e.g. H05VV-F3G1.5) to protect against leaking water and to ensure strain relief at the threaded cable connection.

Fitting the Wilo-Connector

- Use a heat-resistant connecting cable where fluid temperatures exceed 90 °C.
- Ensure that the connecting cable does not make contact with either the pipes or the pump.
- Disconnect the connecting cable from the power supply.
- Observe the terminal allocations (PE, N, L).
- Connect and fit the Wilo-Connector (Fig. 3a to 3e).

Connecting the pump

- Earth the pump.
- Connect the Wilo-Connector (9) to the control module (6) until it snaps into place (Fig 3f).

Removing the Wilo-Connector

- Disconnect the connecting cable from the power supply.
- Remove the Wilo-Connector using a suitable screwdriver (Fig. 4).

7 Commissioning

Commissioning only by qualified technicians.

7.1 Venting

- Fill and vent the system correctly.
 - ↳ The pump vents automatically when first started.
- If the pump does not vent automatically:
- Activate the pump venting function via the function key, briefly press 1x, LED lights green.
 - ↳ Pump venting function starts after 5 seconds, duration 10 minutes.
 - ↳ LED display shows bars running from bottom to top.
 - To cancel, press the function key for a couple of seconds.

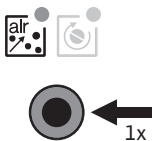

NOTE

After venting, the LED display shows the previously set values of the pump.

7.2 Setting the control mode and the delivery head

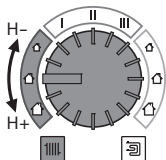

The size of the displayed house symbols and data for setting the delivery head are provided as a guide only. A more detailed calculation for the setting is recommended. The values of the delivery head are displayed in increments of 0.1 m with the setting.

Radiator heating system



Variable differential pressure ($\Delta p-v$):

- Select the setting range of the application.
 - Set setpoint H of the delivery head (variable differential pressure).
- ➔ The LED display shows the setpoint H of the delivery head in m.

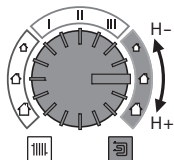

| Pump | Number of radiators | | |
|---------------------|---|---|---|
| |  |  |  |
| Yonos PICO.../1-4 m | 8 | 12 | 15 |
| Yonos PICO.../1-6 m | 12 | 15 | 20 |
| Yonos PICO.../1-8 m | 15 | 20 | 30 |

Underfloor heating



Constant differential pressure ($\Delta p-c$):

- Select the setting range of the application.
 - Set setpoint H of the delivery head (constant differential pressure).
- ➔ The LED display shows the setpoint H of the delivery head in m.

| Pump | Number of square metres of heated space in m ² | | |
|---------------------|---|---|---|
| |  |  |  |
| Yonos PICO.../1-4 m | - | 80 | 120 |
| Yonos PICO.../1-6 m | 80 | 150 | 220 |
| Yonos PICO.../1-8 m | > 220 | | |

Constant speed

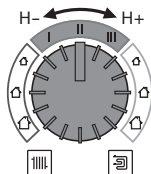

Constant speed I II III:

- Select the setting range of the constant speed.
- Select speed stage I II or III.
- ➔ The LED display shows the set speed c1, c2 or c3 according to the characteristic curve.

Completing the setting

- Do not rotate the operating button for 2 seconds.
- LED display flashes 5 times and changes to the current power consumption in W , alternating with the current flow rate in m^3/h .



NOTE

All settings and displays are retained if the power supply is interrupted.

8 Decommissioning

Shutting down the pump

Shut down the pump immediately in case of damage to the connecting cable or other electrical components.

- Disconnect the pump from the power supply.
- Contact Wilo customer service or a specialist technician.

9 Maintenance

Cleaning

- Carefully remove soiling from the pump on a regular basis using a dry duster.
- Never use liquids or aggressive cleaning agents.

10 Faults, causes and remedies

The troubleshooting must only be performed by a qualified specialist, work on the electrical connection must only be performed by a qualified electrician.

| Faults | Causes | Remedies |
|--|---|---|
| Pump is not running although the power supply is switched on | Electrical fuse defective | Check fuses |
| | Pump has no voltage | Resolve the power interruption |
| Pump making noises | Cavitation due to insufficient suction pressure | Increase the system pressure within the permissible range |
| | | Check the delivery head and set it to a lower head if necessary |
| Building does not get warm | Thermal output of the heating surfaces is too low | Increase setpoint |
| | | Set control mode to $\Delta p-c$ |

10.1 Warning signals

- The warning signal is indicated by the LED display.
- Fault signal LED does not light up.
- The pump continues to run with limited output.
- The indicated faulty operating status must not occur for a prolonged period. The cause must be eliminated.

| LED | Faults | Causes | Remedies |
|-----|---------------------|---|---|
| E07 | Generator operation | Water is flowing through the pump hydraulics, but pump has no mains voltage | Check mains voltage |
| E11 | Dry run | Air in the pump | Check volumetric flow rate/water pressure |
| E21 | Overload | Sluggish motor, pump is operated outside of its specifications (e.g. high module temperature). The speed is lower than during normal operation. | Check the ambient conditions |

10.2 Fault signals

- The fault signal is indicated by the LED display.
- Fault signal LED lights up red.
- The pump switches off (depending on the error code) and attempts a cyclical restart.

| LED | Faults | Causes | Remedies |
|-----|---------------------------------|-------------------------------------|---|
| E04 | Undervoltage | Power supply too low on mains side | Check mains voltage |
| E05 | Overvoltage | Power supply too high on mains side | Check mains voltage |
| E10 | Blocking | Rotor blocked | Activate manual restart or contact customer service |
| E23 | Short-circuit | Motor current too high | Request customer service |
| E25 | Contacting/ winding | Winding defective | Request customer service |
| E30 | Excessive temperature of module | Module interior too warm | Check conditions of use |
| E36 | Module defective | Electronics defective | Request customer service |

Manual restart

- The pump attempts an automatic restart upon detecting a blockage.



If the pump does not restart automatically (E10):

- Activate the manual restart via the function key, briefly press 2x, LED lights green.
 - A restart is performed after 5 seconds, duration 10 minutes.
 - LED display shows the outer segments in a clockwise fashion.
- To cancel, press the function key for a couple of seconds.



NOTE

After the restart, the LED display shows the previously set values of the pump.

If the fault cannot be remedied, contact a specialist technician or Wilo customer service.

11 Disposal

Information on the collection of used electrical and electronic products

Proper disposal and appropriate recycling of this product prevents damage to the environment and dangers to your personal health.



NOTE

Disposal in domestic waste is forbidden!

In the European Union, this symbol can appear on the product, the packaging or the accompanying documentation. It means that the electrical and electronic products in question must not be disposed of along with domestic waste.

To ensure proper handling, recycling and disposal of the used products in question, please note the following points:

- Only hand over these products at designated, certified collecting points.
- Observe the locally applicable regulations!

Please consult your local municipality, the nearest waste disposal site, or the dealer who sold the product to you for information on proper disposal. For further information on recycling, go to www.wilo-recycling.com.



**DECLARATION OF CONFORMITY
KONFORMITÄTSERKLÄRUNG
DECLARATION DE CONFORMITE**

We, the manufacturer, declare under our sole responsibility that these glandless circulating pump types of the series,
Als Hersteller erklären wir unter unserer alleinigen Verantwortung, daß die Nassläufer-Umwälzpumpen der Baureihen,
Nous, fabricant, déclarons sous notre seule responsabilité que les types de circulateurs des séries,

Yonos PICO ...

(The serial number is marked on the product site plate.
Die Seriennummer ist auf dem Typenschild des Produktes angegeben.
Le numéro de série est inscrit sur la plaque signalétique du produit)

in their delivered state comply with the following relevant directives and with the relevant national legislation:
in der gelieferten Ausführung folgenden einschlägigen Bestimmungen entsprechen 'und entsprechender nationaler Gesetzgebung:
dans leur état de livraison sont conformes aux dispositions des directives suivantes et aux législations nationales les transposant :

_ LOW VOLTAGE 2014/35/EU / NIEDERSpannungsRICHTLINIE 2014/35/EU / BASSE TENSION 2014/35/UE

_ ELECTROMAGNETIC COMPATIBILITY 2014/30/EU / ELEKTROMAGNETISCHE VERTRÄGLICHKEIT - RICHTLINIE 2014/30/EU / COMPATIBILITE ELECTROMAGNETIQUE 2014/30/UE

_ ENERGY-RELATED PRODUCTS 2009/125/EC / ENERGIEVERBRAUCHSRELEVANTER PRODUKTE - RICHTLINIE 2009/125/EG / PRODUITS LIÉS A L'ENERGIE 2009/125/CE
(and according to the regulation 641/2009 on glandless circulators amended by 622/2012 / und gemäß der Verordnung (EG) Nr. 641/2009 über Nassläuferpumpen, geändert durch 622/2012 / et conformément au règlement 641/2009 sur les circulateurs à rotor noyé amendé par 622/2012)

_ RESTRICTION OF THE USE OF CERTAIN HAZARDOUS SUBSTANCES 2011/65/EU + 2015/863 / BESCHRÄNKUNG DER VERWENDUNG BESTIMMTER GEFÄHRLICHER STOFFE-RICHTLINIE 2011/65/EU + 2015/863 / LIMITATION DE L'UTILISATION DE CERTAINES SUBSTANCES DANGEREUSES 2011/65/EU + 2015/863

comply also with the following relevant harmonised European standards:
sowie auch den Bestimmungen zu folgenden harmonisierten europäischen Normen:
sont également conformes aux dispositions des normes européennes harmonisées suivantes :

**EN 60335-1:2012+A11:2014+A13:2017; EN 60335-2-51:2003+A1:2008+A2:2012;
EN 61000-6-1:2007; EN 61000-6-2:2005; EN 61000-6-3:2007+A1:2011;
EN 61000-6-4:2007+A1:2011; EN 16297-1:2012; EN 16297-2:2012; EN IEC 63000:2018;**

Person authorized to compile the technical file is:
Bevollmächtigter für die Zusammenstellung der technischen Unterlagen ist:
Personne autorisée à constituer le dossier technique est :

Dortmund,

Digital unterschrieben
von Holger Herchenheim
Datum: 2020.10.22
11:50:19 +02'00'

H. HERCHENHEIN
Senior Vice President - Group Quality & Qualification

Group Quality
WILO SE
Wilopark 1
D-44263 Dortmund

Wilopark 1
D-44263 Dortmund



**DECLARATION OF CONFORMITY
KONFORMITÄTSEKVLÄRUNG
DECLARATION DE CONFORMITE**

| | |
|---|--|
| <p>(BG) - Български език ДЕКЛАРАЦИЯ ЗА СЪОТВЕТСТВИЕ ЕС/ЕО</p> <p>WILO SE декларира, че продуктите посочени в настоящата декларация съответстват на разпоредбите на следните европейски директиви и приелите ги национални законодателства:</p> <p>Ниско Напрежение 2014/35/ЕУ; Електромагнитна съвместимост 2014/30/ЕУ; Продукти, свързани с енергопотреблението 2009/125/ЕУ; Ограничение на употребата на определени опасни вещества 2011/65/ЕУ;</p> <p>както и на хармонизираните европейски стандарти, упоменати на предишната страница.</p> | <p>(CS) - Čeština EU/ES PROHLÁŠENÍ O SHODĚ</p> <p>WILO SE prohlašuje, že výrobky uvedené v tomto prohlášení odpovídají ustanovením níže uvedených evropských směrníc a národním právním předpisům, které je přijímají:</p> <p>Nízké Napětí 2014/35/EU; Elektromagnetická Kompatibilita 2014/30/EU; Výrobků spojených se spotřebou energie 2009/125/ES; Omezení používání určitých nebezpečných látek 2011/65/EU;</p> <p>a rovněž splňují požadavky harmonizovaných evropských norem uvedených na předcházející stránce.</p> |
| <p>(DA) - Dansk EU/EF-OVERENSSTEMMELSESEKVLÆRING</p> <p>WILO SE erklærer, at produkterne, som beskrives i denne erklæring, er i overensstemmelse med bestemmelserne i følgende europæiske direktiver, samt de nationale lovgivninger, der gennemfører dem:</p> <p>Lavspændings 2014/35/EU; Elektromagnetisk Kompatibilitet 2014/30/EU; Energirelaterede produkter 2009/125/EF; Begrænsning af indholdet af visse farlige stoffer 2011/65/EU;</p> <p>De er ligeledes i overensstemmelse med de harmoniserede europæiske standarder, der er anført på forrige side.</p> | <p>(EL) - Ελληνικά ΔΗΛΩΣΗ ΣΥΜΜΟΡΦΩΣΗΣ ΕΕ/ΕΚ</p> <p>WILO SE δηλώνει ότι τα προϊόντα που ορίζονται στην παρούσα ευρωπαϊκή δήλωση είναι σύμφωνα με τις διατάξεις των παρακάτω οδηγιών και τις εθνικές νομοθεσίες στις οποίες έχει μεταφερθεί:</p> <p>Χαμηλής Τάσης 2014/35/ΕΕ; Ηλεκτρομαγνητικής συμβατότητας 2014/30/ΕΕ; Συνδεδεμένο με την ενέργεια προϊόντα 2009/125/ΕΚ; Περιορισμός της χρήσης ορισμένων επικίνδυνων ουσιών 2011/65/ΕΕ;</p> <p>και επίσης με τα εξής εναρμονισμένα ευρωπαϊκά πρότυπα που αναφέρονται στην προηγούμενη σελίδα.</p> |
| <p>(ES) - Español DECLARACIÓN DE CONFORMIDAD UE/CE</p> <p>WILO SE declara que los productos citados en la presente declaración están conformes con las disposiciones de las siguientes directivas europeas y con las legislaciones nacionales que les son aplicables :</p> <p>Baja Tensión 2014/35/UE; Compatibilidad Electromagnética 2014/30/UE; Certos relacionados con la energía 2009/125/CE; Restricción del uso de ciertas sustancias peligrosas 2011/65/UE;</p> <p>Y igualmente están conformes con las disposiciones de las normas europeas armonizadas citadas en la página anterior.</p> | <p>(ET) - Eesti keel EL/EÜ VASTAVUSDEKLARATSIOONI</p> <p>WILO SE kinnitab, et selles vastavustunnistuses kirjeldatud tooted on kooskõlas alljärgnevat Euroopa direktiivide sätetega ning riiklike seadusandlustega, mis nimetatud direktiivide üle on võtnud:</p> <p>Madalpingeseadmed 2014/35/EL; Elektromagnetilist Ühilduvust 2014/30/EL; Energiaga seotud tooted 2009/125/UE; Kasutamise piiramine teatavate ohtlike ainetega 2011/65/EL;</p> <p>Samuti on tooted kooskõlas eelmise lehekülje ära toodud harmoniseeritud Euroopa standarditega.</p> |
| <p>(FI) - Suomen kieli EU/EY-VAATIMUSTENMUKAISUUSVAKUUTUS</p> <p>WILO SE vakuuttaa, että tässä vakuutuksessa kuvutat tuotteet ovat seuraavien eurooppalaisten direktiivien määräysten sekä niihin sovellettävien kansallisten lakiesitysten mukaisia:</p> <p>Matala Jännite 2014/35/EU; Sähkömagneettinen Yhteensopivuus 2014/30/EU; Energiaan liittyvien tuotteiden 2009/125/EU; Käytön rajoittaminen tiettyjen vaarallisten aineiden 2011/65/EU;</p> <p>Lisäksi ne ovat seuraavien edellisellä sivulla mainittujen yhdenmukaistettujen eurooppalaisten normien mukaisia.</p> | <p>(GA) - Gaeilge AE/EC DEARBHŪ COMHLIŪNTA</p> <p>WILO SE ndearbhainn ar cur síos ar na táirgí atá i ráiteas seo, siad i gcomhréir leis na fórlacha atá sna teorach seo a leanas na hEorpa agus leis na dlíthe náisiúnta is infheidhme orthu:</p> <p>Isealvoltais 2014/35/AE; Comhoiriúnacht Leictreamaighnéadach 2014/30/AE; Fuinneamh a bhaineann le táirgí 2009/125/EC; Srian ar an úsáid a bhaint as substaintí gaisceacha acu 2011/65/EU;</p> <p>Agus siad i gcomhréir le fórlacha na caighdeánáil chomhchulbhithe na hEorpa dá dtagraítear sa leathanach roimhe seo.</p> |
| <p>(HR) - Hrvatski EU/EZ IZJAVA O SUKLADNOSTI</p> <p>WILO SE izjavljuje da su proizvodi navedeni u ovoj izjavi u skladu sa sljedećim prihvaćenim europskim direktivama i nacionalnim zakonima:</p> <p>Smjernica o niskom naponu 2014/35/EU; Elektromagnetna kompatibilnost - smjernica 2014/30/EU; Smjernica za proizvode relevantne u pogledu potrošnje energije 2009/125/EU; Ograničenju uporabe određeni opasnih tvari 2011/65/EU;</p> <p>i sukladnim europskim normama navedenim na prethodnoj stranici.</p> | <p>(HU) - Magyar EU/EK-MEGFELELŐSÉGI NYILATKOZAT</p> <p>WILO SE kijelenti, hogy a jelen megfelelősségi nyilatkozatban megjelölt termékek megfelelnek a következő európai irányelvek előírásainak, valamint azok nemzeti jogrendbe áültetett rendelkezéseinek:</p> <p>Alacsony Feszültségű 2014/35/EU; Elektromágneses összeférhetőségre 2014/30/ES; Energiaigény kapcsolatos termékek 2009/125/EC; Korlátozása az egyes veszélyes anyagok 2011/65/EU;</p> <p>valamint az előző oldalon szereplő, harmonizált európai szabványoknak.</p> |
| <p>(IT) - Italiano DICHIARAZIONE DI CONFORMITÀ UE/CE</p> <p>WILO SE dichiara che i prodotti descritti nella presente dichiarazione sono conformi alle disposizioni delle seguenti direttive europee nonché alle legislazioni nazionali che le traspongono :</p> <p>Bassa Tensione 2014/35/UE; Compatibilità Elettromagnetica 2014/30/UE; Prodotti connessi all'energia 2009/125/CE; Restrizione dell'uso di determinate sostanze pericolose 2011/65/UE;</p> <p>E sono pure conformi alle disposizioni delle norme europee armonizzate citate a pagina precedente.</p> | <p>(LT) - Lietuvių kalba ES/EB ATITIKTIS DEKLARACIJA</p> <p>WILO SE pareiškia, kad šioje deklaracijoje nurodyti gaminiai atitinka šių Europos direktyvų ir jas perkeltančių nacionalių įstatymų nuostatas:</p> <p>Žema įtampa 2014/35/ES; Elektromagnetinės Suderinamumas 2014/30/ES; Energija susijusių gaminių 2009/125/EB; Apribojimų dėl tam tikrų pavojingųjų medžiagų naudojimo 2011/65/UE;</p> <p>ir taip pat harmonizuotas Europos normas, kurios buvo cituotos ankstesniame puslapyje.</p> |
| <p>(LV) - Latviešu valoda ES/EK ATBILSTĪBAS DEKLARĀCIJA</p> <p>WILO SE deklarē, ka izstrādājumi, kas ir nosaukti šajā deklarācijā, atbilst šeit uzskaitīto Eiropas direktīvu nosacījumiem, kā arī atsevišķu valstu likumiem, kuros tie ir ietverti:</p> <p>Zemsprieguma 2014/35/ES; Elektromagnētiskās Saderības 2014/30/ES; Enerģiju saistītiem ražojumiem 2009/125/EC; Izmantošanas ierobežošanu dažu bīstamu vielu 2011/65/UE;</p> <p>un saskaņotajiem Eiropas standartiem, kas minēti iepriekšējā lappusē.</p> | <p>(MT) - Malti DIKJARAZZJONI TA' KONFORMITÀ UE/KE</p> <p>WILO SE jidkljara li i-prodotti speċifikați f'din id-dikjarazzjoni huma konformi mad-direttivi Ewropej li jsegwu u mal-legislazzjonijiet nazzjonali li japplikawhom:</p> <p>Vultaġġ Baxx 2014/35/UE; Kompatibilità Elettromagnetika 2014/30/UE; Prodotti relatiati mal-enerġija 2009/125/KE; Restrizzjoni tal-użu ta' ċerti sustanzi perikoluži 2011/65/UE;</p> <p>kif ukoll man-normi Ewropej armonizzati li jsegwu imsemjija fil-paġna preċedenti.</p> |



**DECLARATION OF CONFORMITY
KONFORMITÄTSERKLÄRUNG
DECLARATION DE CONFORMITE**

| | |
|--|---|
| <p>(NL) - Nederlands EU/EG-VERKLARING VAN OVEEREENSTEMMING</p> <p>WILO SE verklaart dat de in deze verklaring vermelde producten voldoen aan de bepalingen van de volgende Europese richtlijnen evenals aan de nationale wetgevingen waarin deze bepalingen zijn overgenomen:</p> <p>Laagspannings 2014/35/EU; Elektromagnetische Compatibiliteit 2014/30/EU; Energierelaterende producten 2009/125/EG; Beperking van het gebruik van bepaalde gevaarlijke stoffen 2011/65/EU;</p> <p>De producten voldoen eveneens aan de geharmoniseerde Europese normen die op de vorige pagina worden genoemd.</p> | <p>(PL) - Polski DEKLARACJA ZGODNOŚCI UE/WE</p> <p>WILO SE oświadcza, że produkty wymienione w niniejszej deklaracji są zgodne z postanowieniami następujących dyrektyw europejskich i transponujących je przepisami prawa krajowego:</p> <p>Niskich Napieć 2014/35/EU; Kompatybilności Elektromagnetycznej 2014/30/EU; Produktów związanych z energią 2009/125/WE; Ograniczenie stosowania niektórych niebezpiecznych substancji 2011/65/EU; oraz z następującymi normami europejskich zharmonizowanymi podanymi na poprzedniej stronie.</p> |
| <p>(PT) - Português DECLARAÇÃO DE CONFORMIDADE UE/CE</p> <p>WILO SE declara que os materiais designados na presente declaração obedecem às disposições das diretivas europeias e às legislações nacionais que as transcrevem :</p> <p>Baixa Voltagem 2014/35/EU; Compatibilidade Electromagnética 2014/30/EU; Produtos relacionados com o consumo de energia 2009/125/CE; Restrição do uso de determinadas substâncias perigosas 2011/65/EU;</p> <p>E obedecem também às normas europeias harmonizadas citadas na página precedente.</p> | <p>(RO) - Română DECLARAȚIE DE CONFORMITATE UE/CE</p> <p>WILO SE declară că produsele citate în prezenta declarație sunt conforme cu dispozițiile directivelor europene următoare și cu legislațiile naționale care le transpun :</p> <p>Joasă Tensiune 2014/35/EU; Compatibilitate Electromagnetică 2014/30/EU; Produsele cu impact energetic 2009/125/CE; Restricțiile de utilizare a anumitor substanțe periculoase 2011/65/EU;</p> <p>și, de asemenea, sunt conforme cu normele europene armonizate citate în pagina precedentă.</p> |
| <p>(SK) - Slovenčina EU/ES VYHLÁSENIE O ZHODE</p> <p>WILO SE čestne prehlasuje, že výrobky ktoré sú predmetom tejto deklarácie, sú v súlade s požiadavkami nasledujúcich európskych direktív a odpovedajúcich národných legislatívnych predpisov:</p> <p>Nízkonapäťové zariadenia 2014/35/EÚ; Elektromagnetickú Kompatibilitu 2014/30/EÚ; Energeticky významných výrobkov 2009/125/ES; Obmedzenie používania určitých nebezpečných látok 2011/65/EÚ;</p> <p>ako aj s harmonizovanými európskych normami uvedenými na predchádzajúcej strane.</p> | <p>(SL) - Slovenščina EU/ES-IZJAVA O SKLADNOSTI</p> <p>WILO SE izjavlja, da so izdelki, navedeni v tej izjavi, v skladu z določili naslednjih evropskih direktiv in z nacionalnimi zakonodajami, ki jih vsebujejo:</p> <p>Nizka Napetost 2014/35/EU; Elektromagnetno Zdržljivostjo 2014/30/EU; Izdelkov, povezanih z energijo 2009/125/ES; O omejevanju uporabe nekaterih nevarnih snovi 2011/65/EU;</p> <p>pa tudi z usklajenimi evropskih standardi, navedenimi na prejšnji strani.</p> |
| <p>(SV) - Svenska EU/EG-FÖRSÄKRAN OM ÖVERENSSTÄMMELSE</p> <p>WILO SE intygar att materialet som beskrivs i följande intyg överensstämmer med bestämmelserna i följande europeiska direktiv och nationella lagstiftningar som inför dem:</p> <p>Lågspännings 2014/35/EU; Elektromagnetisk Kompatibilitet 2014/30/EU; Energirelaterade produkter 2009/125/EG; Begränsning av användningen av vissa farliga ämnen 2011/65/EU;</p> <p>Det överensstämmer även med följande harmoniserade europeiska standarder som nämns på den föregående sidan.</p> | <p>(TR) - Türkçe AB/CE UYGUNLUK TEYID BELGESİ</p> <p>WILO SEbu belgede belirtilen ürünlerin aşağıdaki Avrupa yönetmeliklerine ve ulusal kanunlara uygun olduğunu beyan etmektedir:</p> <p>Alçak Gerilim Yönetmeliği 2014/35/AB; Elektromanyetik Uyumluluk Yönetmeliği 2014/30/AB; Eko Tasarım Yönetmeliği 2009/125/AT; Belirli tehlikeli maddelerin 2011/65/EU bir kullanımını sınırladın;</p> <p>ve önceki sayfada belirtilen uyumlaştırılmış Avrupa standartlarına.</p> |
| <p>(IS) - Íslenska ESB/EB LEYFISYFIRLÝSING</p> <p>WILO SE lýsir því yfir að vörurmar sem um getur í þessari yfirlýsingu eru í samræmi við eftirfarandi tilskipunum ESB og landslögum hafa samþykkt:</p> <p>Lágsþennutlískipun 2014/35/ESB; Rafseguls-samhæfni-tilskipun 2014/30/ESB; Tilskipun varðandi vörur tengdar orkunotkun 2009/125/EB; Takmörkun á notkun tiltekinnna hættulegra efna 2011/65/EU;</p> <p>og samhæfða evrópska staðla sem nefnd eru í fyrri síðu.</p> | <p>(NO) - Norsk EU/EG-OVERENSSTEMMELSESERKLÆING</p> <p>WILO SE erklærer at produktene nevnt i denne erklæringen er i samsvar med følgende europeiske direktiver og nasjonale lover:</p> <p>EG-Lavspenningsdirektiv 2014/35/EU; EG-EMV-Elektromagnetisk kompatibilitet 2014/30/EU; Direktiv energirelaterete produkter 2009/125/EF; Begrensning av bruk av visse farlige stoffer 2011/65/EU;</p> <p>og harmoniserte europeiske standarder nevnt på forrige side.</p> |
| | |
| | |



wilo



Local contact at
www.wilo.com/contact

WILO SE
Wilopark 1
D-44263 Dortmund
Germany
T +49(0)231 4102-0
F +49(0)231 4102-7363
wilo@wilo.com
www.wilo.com

Pioneering for You