

Part Number: 1000E-030-P1

Product Description: Pneumatic Cistern

WRAS Approval: Fill Valve - 2006333, Flush Valve 2107101

Applied Standard(s): BS 1212-4:2016, BS EN 14055: 2018, BS EN 997:2018

Material(s): ABS, Brass, EPDM, HIPS, Nitrile Rubber, POM, PP, Silicon

Approx. Weight (kg) 3.000

Product Dimensions See Image

Packaging: Individually Boxed

Product Type: Concealed Cistern with fittings

Product Details:

- Fitted with Fluidmaster Dual flush valve – Pneumatic operation
- Fitted with Fluidmaster side entry Airgap™ Fill valve – Heavy duty brass inlet shank
- Can be used to achieve a recognised air gap arrangement.
- Meets requirements of the Water Supply (Water Fittings) Regulations, Byelaws in Scotland, as they apply to Type AG and Type AUK1 air gaps in WC suites and the interim agreement.
- Brass inlet thread ½" BSP
- Top and Front Access
- Internal Overflow
- Flush pipe, seals, nuts, washers included
- Flush pipe designed to be cut very low - Horizontal centerline as low as 50mm to underside of the cistern.
- Outlet thread size 2"
- Efficient flushing of nominally 6 & 4 Litres at 198mm waterline
- Reduced flush option available for 4.5 and 3L (175mm W/L) if required - Provides additional BREEAM points
- ***Dimensions (mm)**
 - Cistern 337L x 135W x 315H
 - Flush Bend - 330 to 50mm - Measured from centre line of horizontal to underside of the cistern base.
- Fixing Bracket Supplied for easy installation
- **Made From Recyclable Materials**

For further information about Fluidmaster products please go to:

<https://www.fluidmaster.com/united-kingdom-products/>

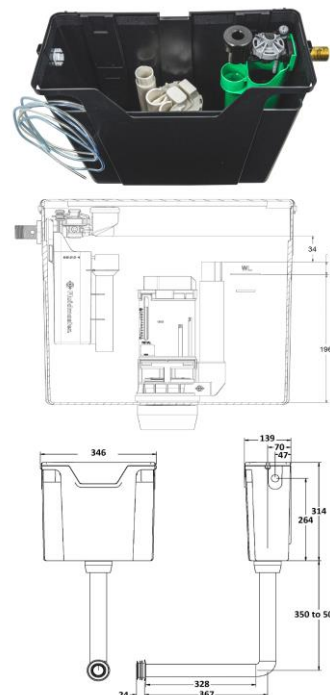

Installation Notes:

Please follow instructions included with the products.

End Of Life Data:

Please recycle all components in accordance with local guidelines/facilities.

Product Warranty 12 Months