

# An introduction to AQUAPANEL® Cement Board Floor Tile Underlay

## The ideal substrate for tiles on a wooden subfloor

AQUAPANEL® Cement Board Floor Tile Underlay



### Benefits

- Thickness of only 6mm allowing for increased room height
- Can be installed over existing wooden subfloors
- Will not deteriorate in water
- Resistant to mould and mildew
- Easy to score and snap
- No pre-drilling required
- Only 9 screws per board necessary

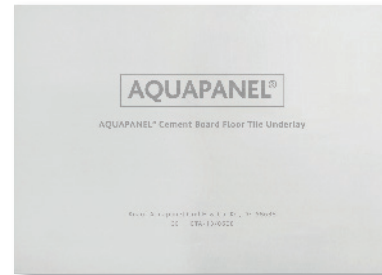

### Your big helper in floor renovation projects

Classy kitchen floors with large-size natural stone tiles or comprehensive bathroom refurbishments can also be done on old wooden subfloors. Knauf AQUAPANEL® Cement Board Floor Tile Underlay is a light, highly stable dry floor panel, perfectly suited for ceramic, mosaic or natural stone. As part of the Knauf AQUAPANEL® Cement Board range, it is resistant to water or mildew and thus an ideal solution for wet and humid areas. With a thickness of only 6mm, it makes low floor heights possible as well.

### Solid substrate for your new floor

Set-up for floor tiling in a system overview

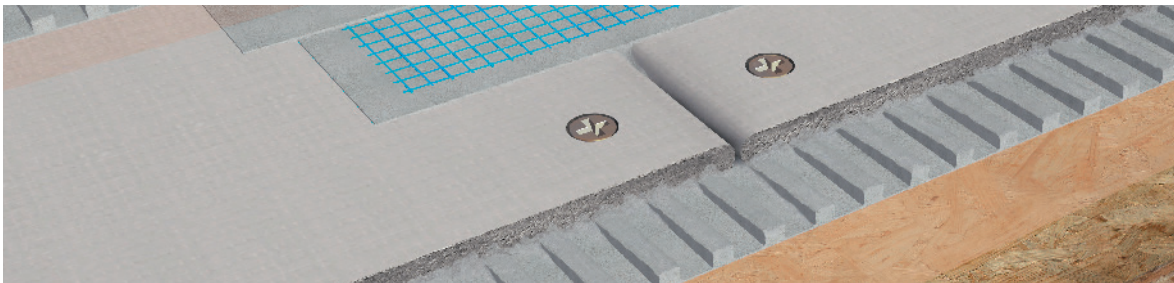

### Application table – timber or steel joists

Minimum subfloor thickness				
Joist centres	400 mm	600 mm	800 mm	
OSB 3 subfloor thickness acc. to EN 300	18 mm	18 mm	22 mm	
Chipboard cat. P5 subfloor thickness acc. to EN 312	19 mm	22 mm	–	

Deflection limits: L/300 bearing wooden/steel framework  
L/400 wooden subfloor (OSB or chipboard)

Minimum subfloor thickness dependent on centre distance of wooden joists.

### Specifications of Knauf AQUAPANEL® Cement Board Floor Tile Underlay

Length (mm)	1200
Width (mm)	900
Thickness (mm)	6.0
Weight per unit area (kg/m <sup>2</sup> )	approx. 8.5
Dry density (kg/m <sup>3</sup> )	approx. 1250
Building material class according to EN 13501	A1 non-combustible

## One system that works perfectly

From board to fitting accessories

With Knauf AQUAPANEL® Cement Board Floor Tile Underlay you have a complete system solution for your tiling project. You benefit from one-stop shopping and an ensured compatibility of all components and accessories.

When working with wooden subfloors we recommend our system screws for fixing boards on timber, as well as our Knauf AQUAPANEL® Tape (100mm) to effectively reinforce all floor joints.



### Knauf AQUAPANEL® Cement Board Floor Tile Underlay

- Aggregated Portland cement board
- Coated glass fibre mesh embedded in back and front surfaces
- Square cut ends with reinforced and smoothly finished edges (EasyEdge™)

### Knauf AQUAPANEL® Maxi Screw SN 25

- Specially suited for fixing boards onto wooden subfloors
- Special corrosion-proof coating

### Knauf AQUAPANEL® Tape (100mm)

- Glass fabric joint tape with alkaline-resistant coating
- Used to reinforce joints in floors and walls in interior areas
- Coverage of approx. 2.1 m<sup>2</sup>
- Width: 100 mm, Length: 20m

## Floor installation

Six easy steps to installation

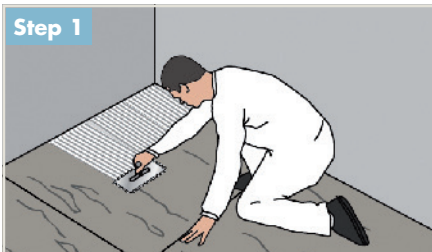

Apply a complete bed of flexible tile adhesive (class C2/S1 acc. EN 12004 /12002) to the subfloor, in accordance with manufacturer's guidelines. Wooden subfloor must be primed before applying Knauf AQUAPANEL® Cement Board Floor Tile Underlay.

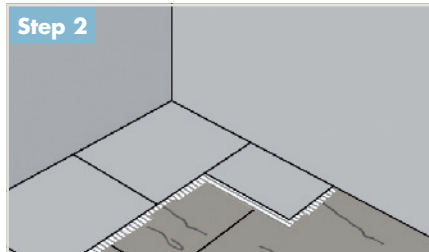

Lay Knauf AQUAPANEL® Cement Board Floor Tile Underlay, starting in the corner farthest from the door. Joints between boards and the subfloor should be staggered (minimum 200mm). No two joints should coincide.

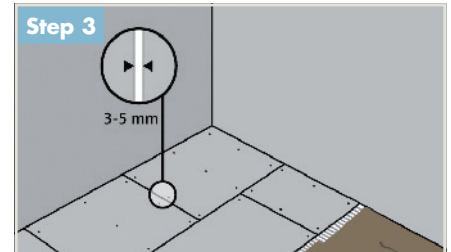

Leave a gap of 3–5mm between each board and screw Knauf AQUAPANEL® Cement Board Floor Tile Underlay to the subfloor using Knauf AQUAPANEL® Maxi Screws SN 25.



Nine screws per board evenly distributed with a minimum distance from the board edge of 15mm.

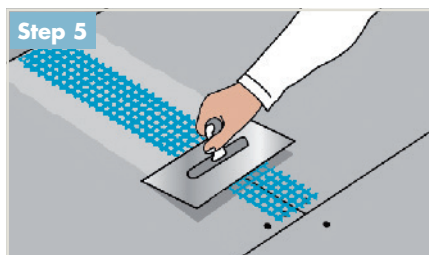

Fill all the joints with flexible tile adhesive (class C2/S1 acc. EN 12004/12002), then embed Knauf AQUAPANEL® Tape (100mm). Allow for the adhesive in the joints to dry.



Ready to lay tiles: apply a complete bed of flexible tile adhesive (class C2/S1 acc. EN 12004/12002), in accordance with manufacturer's guidelines.