

**BARDOLINE®  
CLASSIC**



**BUNGALOW**



**CARPORT**

Made by me!



**BARDOLINE®  
CLASSIC**

**BARDOLINE®  
CLASSIC**

Made by me!



Before



After

**TOOL SHELTER**



Aesthetic



Easy to install



Impact resistant



Watertight

**QUALITY SHINGLES  
FOR ORIGINAL ROOF**

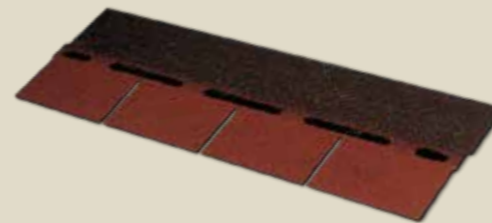

**CE**  
Norm EN 544

Fully compliant with regulations



Sustainable product & production because we care about environment!

8803105A - 12/2018 - Not contractually binding. All information given is for illustrative purposes only and may be modified without notice.

ONDULINE BUILDING PRODUCTS LTD  
Dawson House, 5 Jewry Street  
London, EC3N 2EX  
[onduline.co.uk](http://onduline.co.uk)



Onduline French joint stock company  
share capital of €11,323,485.05  
RCS Nanterre 552 088 361

**Onduline®**  
Lightweight roofing systems

**Onduline®**  
Lightweight roofing systems

Made by me!

**BARDOLINE® CLASSIC**

With BARDOLINE®, you can cover your auxiliary building roof all by yourself, in a practical and long lasting way. AA Fire rated roof shingles suitable for any type of roof.

# BARDOLINE® CLASSIC

## Shape and colour range

### RECTANGULAR



Red

Green



Brown

Slate Grey

### BEAVER



RED

GREEN



Brown

Slate Grey

### TRIANGULAR



Red

Slate Grey

## Technical characteristics

Length	100 cm
Width	34 cm
Tiles per m <sup>2</sup>	7 pcs
Weight per m <sup>2</sup>	9,4 kg

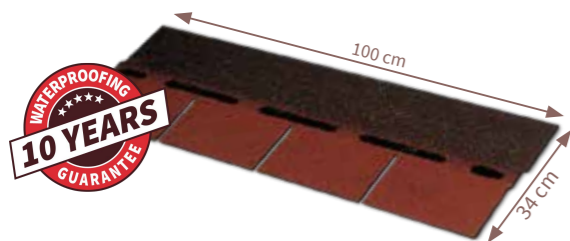

Onduline 5 years warranty for waterproofing, valid if the product has been installed in full compliance with installation recommendations (more on [onduline.com](http://onduline.com)).

## Installation in few and easy steps



### Support and the 1<sup>st</sup> tile row

Installation is done on full wooden decking only (thickness >24 mm). For pitches < 35% is recommended to install a previous protection layer. Prepare base course cutting lengthways tile tabs. The eaves course is then bonded to the adhesive tabs of the base course.



### Fixing

Use five 20 mm large headed galvanised nails per shingle. Nail through strip centre band and into the top edge of the lower course.

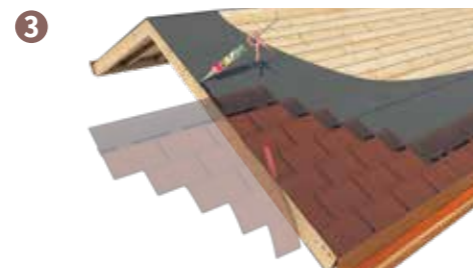

### Installation basic rule

If needed shorten the first left (or right) strip by half a tab. On completion check the tile bonding, use adhesive to reinforce laps as required.

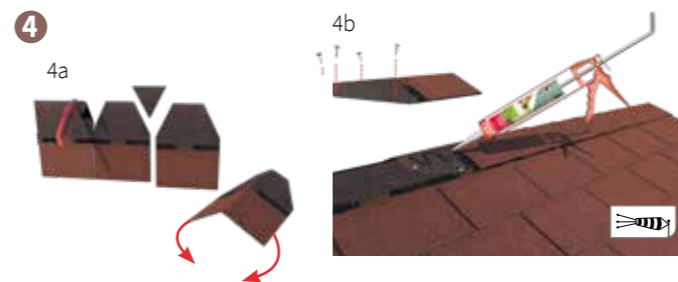

### Ridge

To complete the ridge line, start always cutting shingles to make the ridge (see 4a). Make sure that the bitumen shingles are sufficiently covered on both sides of the roof. The direction of the overlap is made in the opposite direction to prevailing winds (see 4b).



### Job completed

BARDOLINE® shingles provide an attractive, colored and long lasting finishing to a wide variety of garden buildings.

## Accessories



### BARDOLINE DETAIL STRIP

Available in matching colours with the roof shingles for seamless finish



GARDEN SHED



Made by me!

### How to cut and trim your product?

You can easily cut the shingles with a roofers' cutter.



### CALCULATE THE PITCH OF YOUR ROOF

$$\text{Pitch (\%)} = \frac{h}{b} \times 100$$

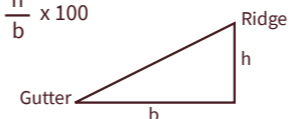

Watch the video!