



Product Technical Sheet



I. General

Product Description	Wickes Ratchet Tube Cutter 6-23mm
SKU	159813
Brand	Wickes
Product image	<div>PRODUCT IMAGE</div>



Product Technical Sheet



II. Reference data

Specification	A durable ratchet pipe cutter with an ergonomic handle, ideal for use in confined spaces, features a cast-metal head with a fully adjustable blade position for cutting pipework.
Features and Benefits	<ul style="list-style-type: none">-Aluminum alloy die casting structure;-A hardened and tempered cutting wheel made of high-quality bearing steel;-With a ratcheting mechanism, this pipe cutter offers easy operation and adjustable cutting;-1 Spare cutting wheel stored in handle;-Durable, professional cutting performance, efficient and precise.
Application	<ul style="list-style-type: none">-Ranging from 6 to 23mm;-Suitable for cutting water pipes, gas lines, oil pipes;-Cuts pipes with wall thickness up to 2 mm;-Suitable for cutting water pipes, gas lines, oil pipes.



Product Technical Sheet



III. Instructions & Note

-Instructions-

STEP 1

Turn the knob to release the blade.

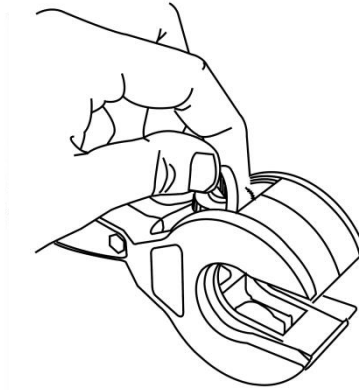

STEP 2

Put the pipe into the pipe cutter and turn the knob again until the tube snaps.

Note: make sure the knob is tight.

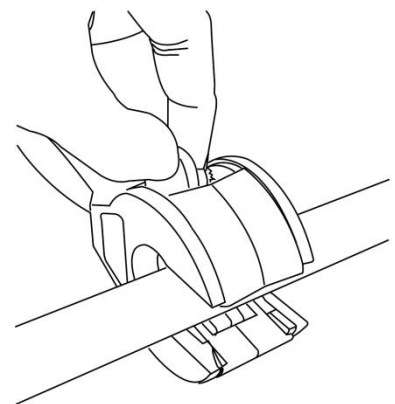

STEPS

STEP 3

When using it, hold the pipe with one hand, and turn the handle up and down five times with the other hand, and then tighten the knob. After that, continue to turn the handle up and down five times, and tighten the knob again. Repeat the above steps until the pipe is cut off.

Note: make sure the knob is tight.

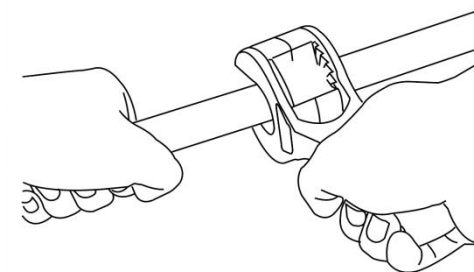

STEP 4

Successfully cut.

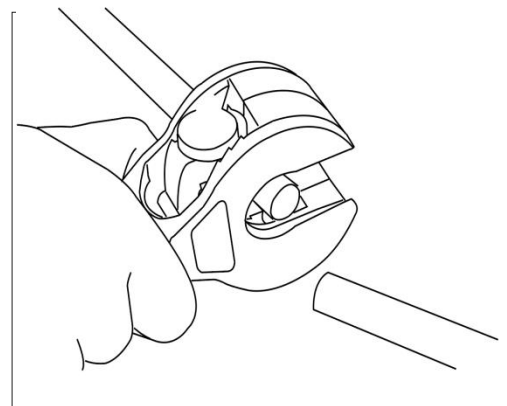

-Cutting Wheel replacement-

STEP 1

Turn the knob to release the wheel part.

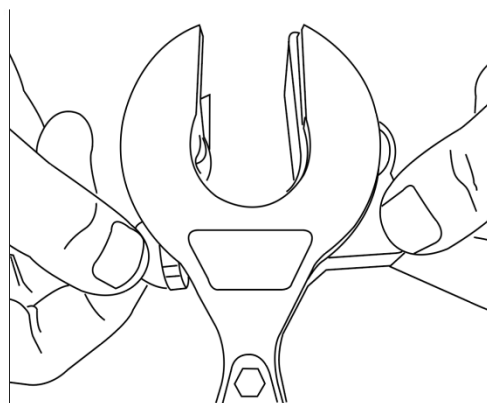

STEP 2

Take out the wheel part, then remove the old cutting wheel by turning it counterclockwise with a screwdriver.

Note: Do not touch the edge of the blade, or you might cut your finger. Grasp the base of the cutting wheel.

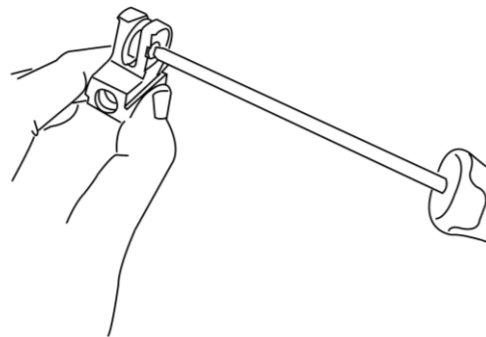

STEPS

STEP 3

Use a screwdriver to release the spare cutting wheel.

Note: Do not touch the edge of the blade, or you might cut your finger. Grasp the base of the cutting wheel.

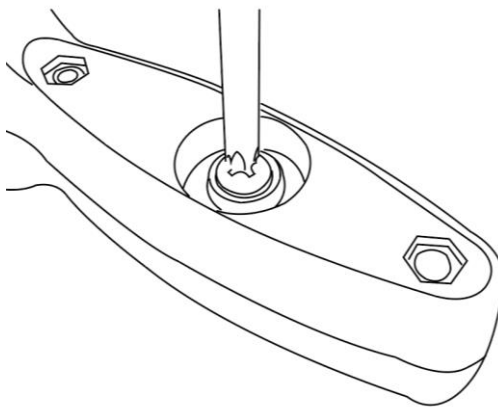

STEP 4

Align the center hole of the new cutting wheel with the support hole and place it into the wheel part, then turn the screwdriver clockwise to tighten.

Note: Do not touch the edge of the blade, or you might cut your finger. Grasp the base of the cutting wheel.

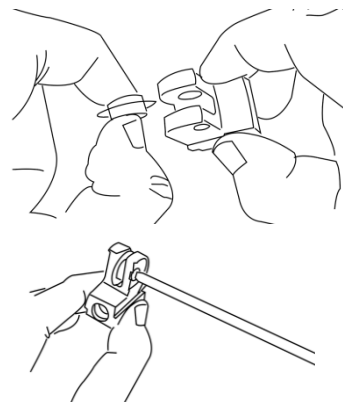

Product Technical Sheet

Wickes

STEPS

STEP 5

Turn the knob to put the wheel part back into the tube cutter.

