

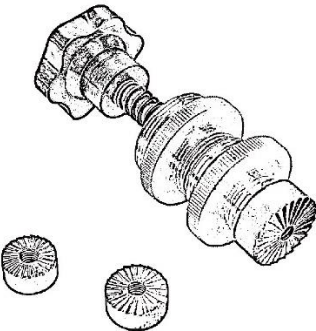

# Product Technical Sheet



## I. General

Product Description	Wickes Tap Re-Seating Tool
SKU	500530
Brand	Wickes
Product image	<div>PRODUCT IMAGE</div> 



# Product Technical Sheet



## II. Reference data

<b>Specification</b>	Excellent quality tool, Select the correct threaded guide, remove as little material as possible to achieve a smooth surface.
<b>Features and Benefits</b>	<ul style="list-style-type: none"><li>-Designed for reseating most UK taps;</li><li>-The four brass threaded guides are designed to fit taps to BS1010 with 18 TPI threads and BS 5412 with BSP threads;</li><li>-Tool is supplied with three hardened steel cutters which will repair most sink, basin and bath taps.</li></ul>
<b>Application</b>	<ul style="list-style-type: none"><li>-17mm (11/16") diameter steel cutter for various sink or basin taps;</li><li>-19mm(3/4") diameter steel cutter for most sink or basin taps;</li><li>-25mm (1") diameter steel cutter for most bath taps.</li></ul>



# Product Technical Sheet



## III. Instructions & Note

### -Instructions-

#### STEP 1

Ensure you have the right sized threaded piece and cutter for the reseating tool. Place the reseating tool cutter downwards into the tap body.

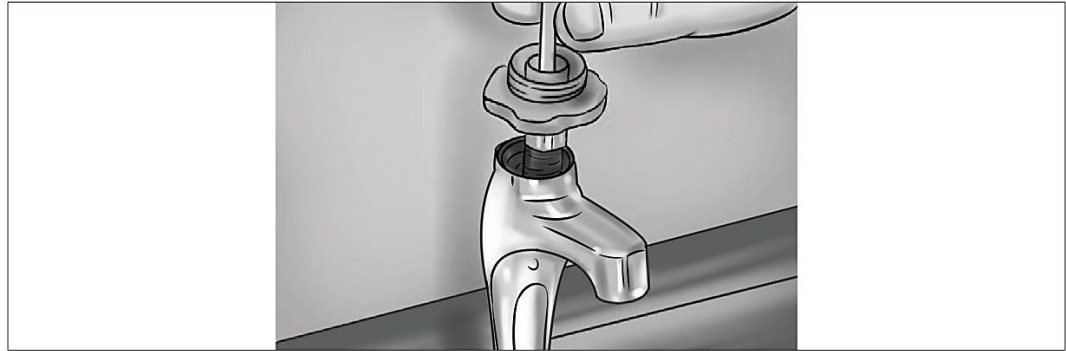

#### STEPS

#### STEP 2

Tighten the threaded section in the retaining nut screw hole.

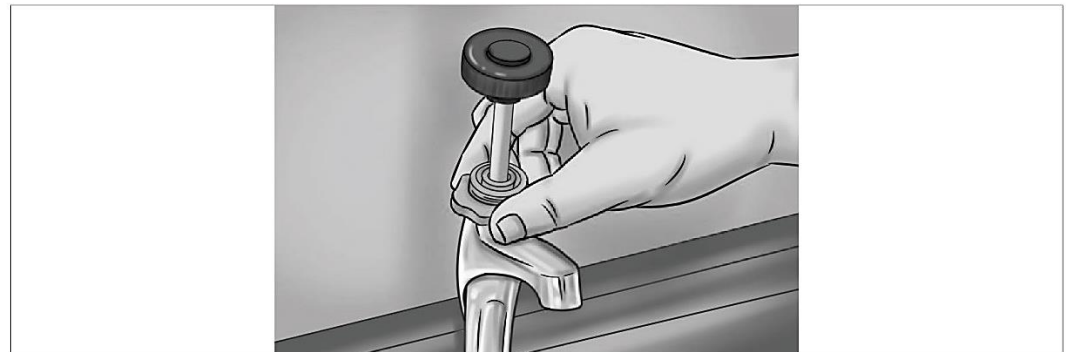

## STEP 3

Twist the reseating tool in a clockwise direction, applying a moderate amount of pressure.

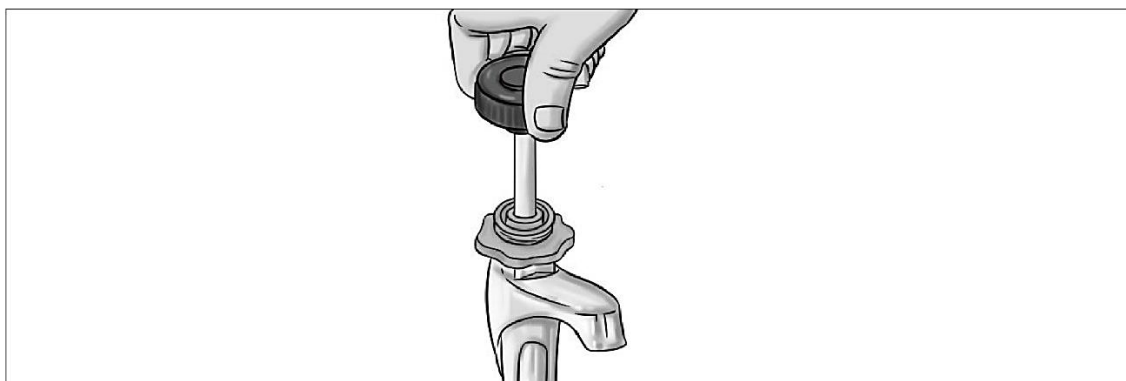

## STEPS

## STEP 4

Remove the tap reseater and inspect the seat. The process may need repeating several times until you have a shiny-looking seat which is smooth to the touch. A smooth seat is a repaired seat and the washer should now sit flush.

