

71b. PICK AXE WITH FIBREGLASS HANDLE

ASSEMBLY

Please read all instructions thoroughly before proceeding. Please refer to the installation diagram as necessary.

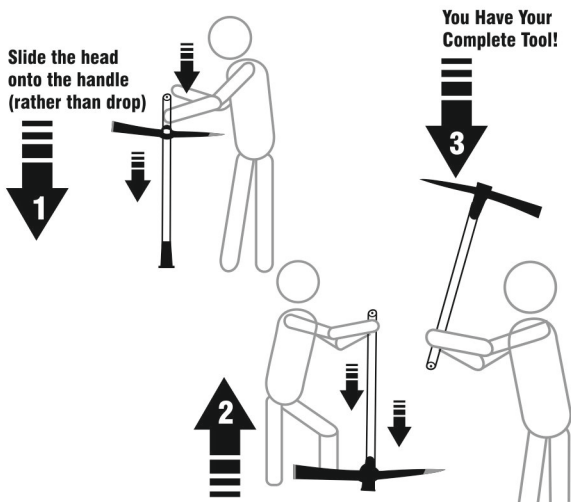

Holding the top of the handle bang the bottom end onto a hard surface such as concrete with force (ensure the handle is held straight). Repeat several times until head is secure

INSTRUCTIONS FOR USE

MANUAL ASSEMBLY

- ★ Make sure the assembly instructions have been followed correctly.
- ★ Keep children well away from the assembly area.
- ★ During normal use you should occasionally check that the head is still secure. If it is loose repeat step 2.

WARNING :

Be safe wear safety goggles. Protect your eyes-any striking tool may chip if struck against another hardened surface resulting in damage to the tool, possibly resulting in serious bodily injury. Never use with a loose or damaged handle.

Protect feet and hands during use. Be aware of bystanders and surroundings when using. Keep away from children.