

# Floor Standing Bath Shower Mixer

## Fitting instructions

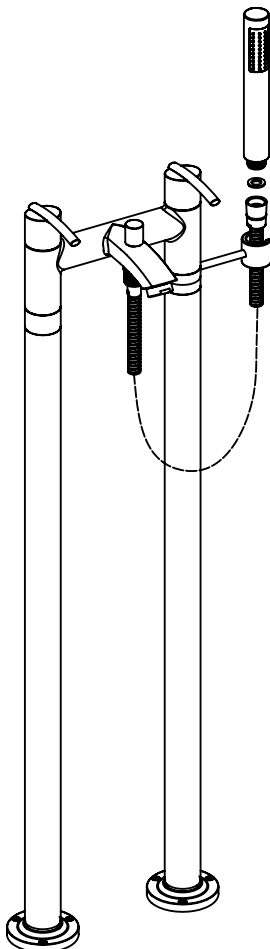

Please keep these instructions for future reference and request of replacement parts.

We have taken great care to ensure that this product reaches you in perfect condition. However should any parts be damaged or missing please contact your point of purchase. This does not affect your statutory rights. In addition if you require replacement parts your point of purchase will be happy to assist.

<b>Contents</b>	<b>Page</b>
<b>1. Tools required</b>	<b>2</b>
<b>2. Parts Supplied</b>	<b>3</b>
<b>3. Specifications</b>	<b>3</b>
<b>4. Installation</b>	<b>3-4</b>
<b>5. Aftercare</b>	<b>4</b>

**Tools required**  
**(Tools not supplied)**



## Parts Supplied

NO.	Description	Qty
1	Tap Body	1
2	Long Connect Seat	1
3	Tube Rail	2
4	Flange	2
5	Screw Plug	6
6	Screw	6
7	Low Connect Seat	1
8	Handset Seat	1
9	Shower Hose	1
10	Handset	1

## Specifications

The taps is suitable for use at water supply pressures of 0.5 bar (min.) to 5 bar (max.). This pressure rating is determined by the manufacturer using soft water under test house conditions and may differ to the retailer's recommendation.

This taps should be installed in compliance with Water Regulations. For further details contact your Local Water Authority.

- (a) Identify all components and check pack contents.
- (b) Turn off water mains supply.

## Installation

**IT IS RECOMMENDED THAT THIS PRODUCT IS INSTALLED ON A WOODEN FLOOR AND THE USE OF FLEXIBLE PIPE FOR TAP CONNECTION. IF YOU ARE LOOKING TO FIT ANY OTHER FLOOR TYPE, PLEASE ENSURE THE CORRECT FITTINGS ARE SOURCED AND USED.**

1. Place the Flanges (4) onto the floor for the desired tap position. Mark and drill holes at 180mm centres. Ensure that a sufficient hole is drilled in the centre of each flange for the pipework. Once holes are drilled, use Screws (6) to fix Flanges (4) to the floor.
2. Connect and thread pipework through the Tube Rails. Ensure that the hot supply is on the left side. Screw Tube Rails (3) into the Flanges (4) as tighten as possible by hand.

3. Screw Long Connect Seat (2) into the left of Inlet legs and then put the Handset Seat (8) to the right of inlet legs with the Grub Screw secured. Screw the Low Connect Seat (7) into the right of inlet legs.
4. Connect the hot water to the left inlet leg of the Tap Body(1) and connect the cold water to the right inlet leg of Tap Body(1). Use suitable plumbing joints. Put assembly into the Tube Rail. Secure this assembly using the Allen Key to screw the Grub Screw till tight.
5. Fix Shower Hose (9) to the Tap Body (1) by placing Hose Seal in between the two. DO NOT OVERTIGHTEN.
6. Turn on the hot and cold and mains water supply. Check for leaks immediately. It is always advisable at this stage to flush out the system. To do this, open both valves fully and allow water to flow for approx. 1 minute. This will remove any foreign matter within the installation.
7. Finally turn on all the water heating arrangements.
8. Fix Shower Hose (9) to the Handset (10) by placing hose seal in between the two, and then place the Handset (10) to the Handset Seat (8).

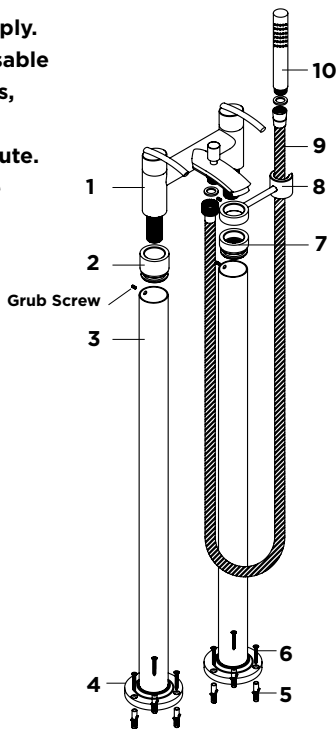

## Aftercare

Whilst modern plating techniques are used in the manufacture of these fittings, the plating will wear if not cleaned properly. The safest way to clean your product is to wipe with a soft damp cloth. Stains can be removed using washing up liquid. All cleaning powders and liquids will damage the surface of your fitting even the non-scratch cleaners.